

**Precision Laser  
& Instrument, Inc.**  
www.laserinst.com

Order Online Anytime!  
www.laserinst.com

**Construction • Survey • GIS**

**Sales    Service    Rentals    Training    Support**



Total Stations



GNSS Receivers



Construction Lasers



Field Supplies & Accessories



# Fall 2018 Catalog (Ver. 8.0)

## Surveying Equipment, Supplies & Accessories

*"Your Hand Guide to Positioning Essentials!"*

### Locations:

**Pittsburgh, PA (HQ):** 724-266-1600  
**Cincinnati, OH:** 513-539-0022  
**Charleston, WV:** 304-776-1831

**Columbus, OH:** 614-759-1000  
**Akron, OH:** 330-633-4900  
**Bridgeport, WV:** 304-933-3036



**Local Pick-Up & Delivery!**



**See Back Cover for Full Store Addresses.**

\*Note: All prices in this catalog are subject to change per dealer discretion.



# Table of Contents



## Field Supplies & Accessories

|  |            |
|--|------------|
| Grade Rods .....                               | Page 3     |
| Tripods & Tripod Accessories .....             | Page 3     |
| Tribachs & Adapters .....                      | Page 4     |
| Prisms .....                                   | Page 4     |
| Plumb Bobs & Accessories .....                 | Page 4-5   |
| Datum Markers & Smart Targets .....            | Page 5     |
| Prism Poles & Accessories .....                | Page 5-6   |
| Bipods .....                                   | Page 6     |
| Hand Levels .....                              | Page 6     |
| Automatic Levels, Transits & Theodolites ..... | Page 7     |
| Nails & Fasteners .....                        | Page 7     |
| Tape Measures & Measuring Wheels .....         | Page 8-9   |
| Rebar & Rebar Caps .....                       | Page 9     |
| Marking Paint .....                            | Page 10    |
| Lumber Crayons & Paint Sticks .....            | Page 10    |
| Survey Benchties & Hub Discs .....             | Page 10    |
| Brass Survey Markers .....                     | Page 10-11 |
| Wood Hubs, Flats, Lath & Stakes .....          | Page 11    |
| Drafting Supplies .....                        | Page 11    |
| Flagging & Whiskers .....                      | Page 12    |
| Field Books & Binders .....                    | Page 13    |
| Carrying Cases & Bags .....                    | Page 13    |
| Safety Glasses .....                           | Page 14    |
| Hard Hats .....                                | Page 14    |
| Safety Vests .....                             | Page 14    |
| Two-Way Radios .....                           | Page 15    |
| Road Signs & Accessories .....                 | Page 15    |
| Survey Vehicle Accessories .....               | Page 15    |
| Hand Tools .....                               | Page 16-17 |
| Alternative Leveling Solutions .....           | Page 17    |



## Construction Layout Solutions

|  |            |
|--|------------|
| Leveling Lasers .....                              | Page 18    |
| Grade Lasers .....                                 | Page 18    |
| Pipe & Utility Lasers .....                        | Page 19    |
| Interior Lasers .....                              | Page 20    |
| Hand Receivers .....                               | Page 20-21 |
| Machine Receivers .....                            | Page 21    |
| One Person Construction Positioning Package .....  | Page 22    |
| Two-Person Construction Positioning Packages ..... | Page 23    |

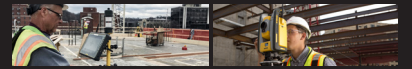

## Build Construction Solutions

|  |            |
|--|------------|
| Build Construction Equipment Hardware, Software, Sales & Support ..... | Page 24-25 |
|--|------------|



## Geospatial Positioning Equipment & Accessories

|  |                |
|--|----------------|
| Trimble SX10 & S-Series Robotic Total Stations & Survey Controllers .....            | Page 26        |
| Trimble R10 & R8s GNSS Receivers .....   | Page 27        |
| Hydrographic Surveying Solutions .....   | Page 28        |
| <b>Spectra Precision &amp; Nikon Financing Program Credit Application Form .....</b> | <b>Page 29</b> |
| Spectra Precision GNSS Receivers .....   | Page 30        |
| Nikon Mechanical Total Stations .....  | Page 30        |
| Spectra Precision Robotic Total Stations .....                                       | Page 31        |
| Spectra Precision Data Collectors & Software .....                                   | Page 31        |
| Warranty Plans for Geospatial Equipment .....  | Page 32-33     |
| Virtual Reference Station (VRS) Solutions .....                                      | Page 34        |
| Survey Total Station Accessories .....   | Page 35        |
| Survey GNSS Receiver Accessories .....   | Page 35        |
| Instrument Radio Accessories .....   | Page 35        |
| Survey Data Controller Accessories .....   | Page 35-36     |
| Mobile Computing Tablet Accessories .....  | Page 37        |
| Mapping & GIS Equipment Accessories .....  | Page 37        |
| Underground/Utility Locators .....   | Page 38        |
| Trimble Forensics Law Enforcement Solutions .....                                    | Page 39        |



## The PLI Difference

Precision Laser & Instrument, Inc. is a Factory Authorized Warranty Service Center specializing in Cleaning, Calibration & Warranty Repairs.

From Sales & Rentals to Service & Support, our expert staff is what sets us apart!



## Field Supplies & Accessories

### Grade Rods

#### Crain/Seco Grade Rods

| Part #          | Description   | Qty | PLI Price |
|-----------------|---|-----|-----------|
| 7301-50/7321-50 | Seco 16ft. Aluminum Rod - Engineer/Inches                 | 1   | \$66.50   |
| 92021/92022     | Crain CR 13ft. Fiberglass Leveling Rod - Engineer/Inches  | 1   | \$74.95   |
| 92041/92042     | Crain CR 16ft. Fiberglass Leveling Rod - Engineer/Inches  | 1   | \$93.95   |
| 92031/92032     | Crain CR 20ft. Fiberglass Leveling Rod - Engineer/Inches  | 1   | \$116.95  |
| 98010/98011     | Crain SVR 25ft. Fiberglass Leveling Rod - Engineer/Inches | 1   | \$193.95  |
| 90004           | Crain LR-STD 25ft. Fiberglass Round Rod - Engineer        | 1   | \$258.42  |
| 90022           | Crain LR-PRO 25ft. Fiberglass HD Round Rod - Engineer     | 1   | \$269.00  |
| 90024           | Crain LR-PRO 35ft. Fiberglass HD Round Rod - Engineer     | 1   | \$449.00  |
| 90026           | Crain LR-PRO 45ft. Fiberglass HD Round Rod - Engineer     | 1   | \$539.00  |
| 91258           | Crain 5/8in. x 11in. Prism Mounting Adapter Kit           | 1   | \$17.95   |



#### LaserLine Manufacturing, Inc. Leveling/Laser Rods

| Part #               | Description  | Qty | PLI Price       |
|----------------------|--|-----|-----------------|
| GR1000/GR1000T       | LaserLine Lenker-Style 10ft Laser Rod (ft, 10ths, plus cut/fill) | 1   | \$189.00        |
| GR1000I /GR1000ICF   | LaserLine Lenker-Style 10ft Laser Rod (ft, in, cut/fill)         | 1   | \$189.00        |
| GR1450/GR1450T       | LaserLine Lenker-Style 15ft Laser Rod (ft, 10ths, plus cut/fill) | 1   | \$265.00        |
| 1000-1301 /1000-1302 | LaserLine 10ft (3m)/15ft (5m) Laser Rod Carrying Case            | 1   | \$35.00/\$38.00 |
| 1000-1026            | LaserLine 10ft (10ths) Replacement Tape                          | 1   | \$65.00         |
| B-STORM              | LaserLine Rod Bracket (HL700/750/450 & Rod Eye Digital Receiver) | 1   | \$65.00         |
| B1/UB-1              | LaserLine Universal Rod Brackets                                 | 1   | \$65.00/\$75.00 |

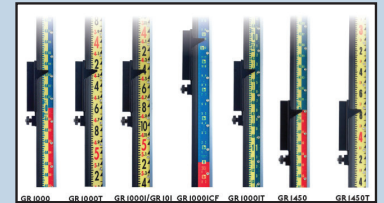

**L LASERLINE**  
MANUFACTURING, INC.

### Tripods & Tripod Accessories

#### CST/Berger Tripods & Accessories

| Part #         | Description  | Qty | PLI Price |
|----------------|--|-----|-----------|
| 60-ALQRI20-BPL | CST/Berger Aluminum Quick Clamp Tripod                 | 1   | \$79.50   |
| 60-FGHD20      | CST/Berger Heavy Duty Fiberglass Tripod w/ Quick Clamp | 1   | \$123.00  |
| 60-WDF20       | CST Wood Fiberglass Leg Tripod w/ Logo                 | 1   | \$142.00  |
| 60-ALQRI20ELAZ | CST/Berger Elevating Tripod w/ Quick Clamp             | 1   | \$199.00  |



#### Crain, Nedo, Seco Tripods

| Part #      | Description  | Qty | PLI Price |
|-------------|--|-----|-----------|
| 5610-00     | Seco HD Aluminum Tripod Stabilizer                   | 1   | \$92.50   |
| 5321-17-ORG | Seco Heavy-Duty, Extra-Tall Elevator Tripod - Orange | 1   | \$344.95  |
| 90553-PL    | Crain Tri-Max Dual-Clamp Tripod                      | 1   | \$369.50  |
| 90556       | Crain/Seco Elevator Tripod                           | 1   | \$716.95  |



#### 3D Laser Scanner Tripods & Acc.



|            |  |   |            |
|------------|--|---|------------|
| 6704-10    | Seco Scanning Spheres Hard Case (Fits 3 Spheres)       | 1 | \$785.00   |
| 6704-10-TR | Scanning Sphere, 230mm (Pack of 3) & Case              | 1 | \$999.95   |
| 210710     | Nedo Industrial Line Elevating 3D Laser Scanner Tripod | 1 | \$1,395.00 |

#### Leica Geosystems Tripods

| Part # | Description   | Qty | PLI Price |
|--------|---|-----|-----------|
| 757938 | Leica Geosystems TRI 100 Tripod w/ Tilting Head               | 1   | \$79.00   |
| 663099 | Leica Geosystems LAT195 195cm. (77in.) Crankable Laser Tripod | 1   | \$525.00  |



#### Trimble Tripods

| Part #   | Description                                   | Qty | PLI Price |
|----------|---|-----|-----------|
| 28959-00 | Trimble Tripod - Adjustable Height 2m for GPS | 1   | \$782.25  |





## Field Supplies & Accessories

### Tribrachs & Adapters

#### Seco Tribrach Adapters

| Part #  | Description                                 | Qty | PLI Price |
|---------|---|-----|-----------|
| 2010-00 | Seco Fixed Tribrach Adapter                 | 1   | \$35.15   |
| 2020-00 | Seco Rotating Tribrach Adapter              | 1   | \$42.95   |
| 2070-00 | Seco Rotating, Swiss-Style Tribrach Adapter | 1   | \$53.95   |



#### SitePro Tribrachs

| Part #       | Description                         | Qty | PLI Price |
|--------------|-------------------------------------|-----|-----------|
| 05-1200-BBAG | SitePro Tribrach w/ Op & Padded Bag | 1   | \$179.00  |



### Prisms

#### NEW! Leica Geosystems Steep-Angle Prisms

| Part #  | Description  | Qty | PLI Price  |
|---------|--|-----|------------|
| 2131-01 | GRZ101 5/8" x 11" Female to 1/4" x 20" Female Prism Pole Adapter | 1   | \$12.95    |
| 644327  | Leica Geosystems GRZ101 360 Degree Mini Prism                    | 1   | \$650.00   |
| 5187-00 | GRZ122 Quick-Release Prism Pole Adapter                          | 1   | \$27.95    |
| 754384  | Leica Geosystems GRZ122 Monitoring Prism                         | 1   | \$1,700.00 |



#### Seco Prisms

| Part #      | Description   | Qty | PLI Price |
|-------------|---|-----|-----------|
| 6200-11-FOR | Seco 25mm. 0/-30 Mini Prism System w/ Side Vial - Flo. Orange   | 1   | \$112.95  |
| 6200-10-FOR | Seco 25mm. 0/-30 Mini Prism System w/ Center Vial - Flo. Orange | 1   | \$112.95  |
| 6422-02-YLB | Seco 5.5in. x 7in. 0/-30 Prism Assembly - Yellow w/ Black       | 1   | \$173.50  |
| 6422-02-FLB | Seco 5.5in. x 7in. 0/-30 Prism Assembly - Flo. Yellow w/ Black  | 1   | \$173.50  |
| 6422-02-FOB | Seco 5.5in. x 7in. 0/-30 Prism Assembly - Flo. Orange w/ Black  | 1   | \$173.50  |
| 6405-01-FOR | Seco 25mm. 0/-30 Stakeout Prism Assembly - Flo. Orange          | 1   | \$163.50  |
| 6405-10-FOR | Seco 0/-30 Mini Stakeout Prism w/ Site Cones - Flo. Orange      | 1   | \$165.50  |
| 6405-11-FOR | Seco 0/-30 Mini Stakeout Prism Kit - Flo. Orange                | 1   | \$239.50  |



#### SitePro Prisms

| Part #    | Description                           | Qty | PLI Price |
|-----------|---------------------------------------|-----|-----------|
| 03-1010-O | SitePro 0/-30mm Constant Prism System | 1   | \$131.50  |
| 03-3600   | SitePro 360 Degree Robotics Prism     | 1   | \$399.00  |



### Plumb Bobs & Accessories

#### NEW! Bazooka Plumb Bob

A precision magnetic level for the vertical alignment of columns, walls, etc.  
Use on steel, precast, forms, walls, studs & more!

| Part #     | Description                                  | Qty | PLI Price |
|------------|--|-----|-----------|
| BAZOOKABOB | Bazooka Plumb Bob Magnetic Leveling Solution | 1   | \$369.00  |



#### Leather Works/SitePro Plumb Bob Sheaths & Tool Pouches

| Part #      | Description   | Qty | PLI Price         |
|-------------|---|-----|-------------------|
| BP-15/25/35 | Leather Works 8-10/14-16/18-24 oz Plumb Bob Sheaths           | 1   | \$5.69/\$6/\$6.31 |
| 51-10218G   | SitePro Leather Gammon Reel and Plumb Bob Sheath              | 1   | \$16.00           |
| BL-2X       | Leather Works Belt (36-54)                                    | 1   | \$19.92           |
| EP-96       | Leather Works Surveyors Tool Pouch                            | 1   | \$26.54           |
| 51-10107    | SitePro 7-Pocket Leather Surveyor's Tool Pouch                | 1   | \$30.00           |
| 51-10109    | SitePro 9-Pocket Leather Professional Contractor's Tool Pouch | 1   | \$38.00           |





## Field Supplies & Accessories

### Plumb Bobs & Accessories (Continued)

#### Seco Plumb Bobs & Accessories

| Part #   | Description   | Qty | PLI Price |
|----------|---|-----|-----------|
| 6000-012 | Seco 12oz Solid Brass, Hardened Steel Point Plumb Bob | 1   | \$19.95   |
| 6000-014 | Seco 14oz Solid Brass, Hardened Steel Point Plumb Bob | 1   | \$21.95   |
| 6000-016 | Seco 16oz Solid Brass, Hardened Steel Point Plumb Bob | 1   | \$22.95   |
| 6000-018 | Seco 18oz Solid Brass, Hardened Steel Point Plumb Bob | 1   | \$24.95   |
| 6000-024 | Seco 24oz Solid Brass, Hardened Steel Point Plumb Bob | 1   | \$31.95   |
| 6000-002 | Seco Universal Plumb Bob Replacement Point            | 1   | \$2.95    |
| 5193-00  | Seco Topo Point w/ Plumb Bob Tip                      | 1   | \$18.95   |
| 6030-00  | Seco Plumb Bob Prism Mount                            | 1   | \$20.95   |



#### SitePro Gammon Reels

| Part #    | Description                                | Qty | PLI Price          |
|-----------|--|-----|--------------------|
| 001       | 6ft. Gammon Reel                           | 1   | \$13.50            |
| 012/012HV | 12ft. Gammon Reel Standard/High-Visibility | 1   | \$18.75<br>\$19.95 |

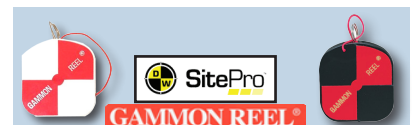

### Datum Markers & Smart Targets

#### NEW! Rothbucher Systems Datum Markers & Smart Targets

| Part #    | Description   | Qty | PLI Price |
|-----------|---|-----|-----------|
| RS30      | Rothbucher Flat Prism Level Reflective Target 30mm (Red/Grey)         | 1   | \$8.85    |
| RS40      | Rothbucher Smart Target w/ Crosshairs (Red/Grey)                      | 1   | \$6.54    |
| RS50      | Rothbucher Reflective Smart Target, 30mm (Red/Grey)                   | 1   | \$9.08    |
| RS60      | Rothbucher Reflective Smart Target, 40mm (Red/Grey)                   | 1   | \$10.69   |
| RS70/RS71 | Rothbucher Smart Target w/ Crosshairs (Red/Grey)                      | 1   | \$6.54    |
| RS90      | Rothbucher Smart Angle w/ 2 or 3 Reflective Targets, 40mm (Red/Grey)  | 1   | \$26.54   |
| RS80      | Rothbucher Smart Angle w/ 2 or 3 Reflective Targets, 40mm (Red/Grey)  | 1   | \$21.92   |
| RS100     | Rothbucher Smart Angle Target w/ 4 Crosshairs                         | 1   | \$15.31   |
| RS96      | Rothbucher Stake-Out Aid w/ Reflective Target Marker (Red/Grey)       | 1   | \$59.92   |
| RSAK80    | Rothbucher Angled Adapter w/ Reflective Targets, 40mm (Red/Grey)      | 1   | \$38.38   |
| RSAK130   | Rothbucher Angled Adapter w/ Reflective Targets, 30mm (Red/Grey)      | 1   | \$24.23   |
| RSAM80    | Rothbucher Steel Thread Adapter & Reflective Targets, 40mm (Red/Grey) | 1   | \$83.46   |
| RSAMG80   | Rothbucher Steel Thread Adapter & Reflective Targets, 40mm (Red/Grey) | 1   | \$91.15   |
| RS183     | Rothbucher Swivelling Target Reflector, 30mm (Red/Grey)               | 1   | \$45.77   |
| RSMP280   | Rothbucher 17.5mm Mini-Prism, 30mm Tilting Axis (Red/Grey)            | 1   | \$139.92  |
| RSMP190   | Rothbucher 12.7mm Mini-Prism w/ 45mm Tilting Axis (Red/Grey)          | 1   | \$147.62  |

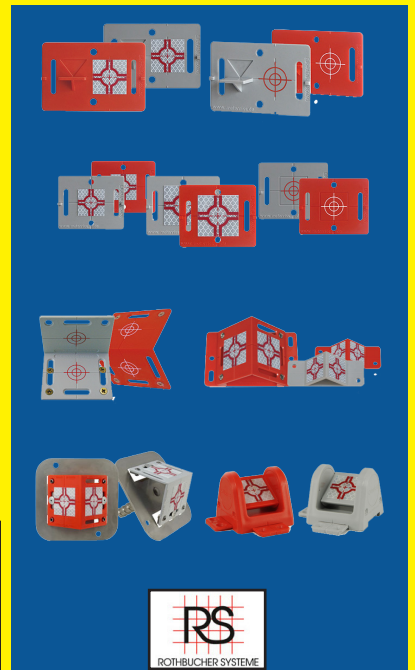

### Prism Poles & Accessories

#### Trimble/Spectra Precision Prism Poles

| Part #   | Description  | Qty | PLI Price |
|----------|--|-----|-----------|
| 61586-20 | Trimble Inverted Construction Layout Rod w/ Metal Punch  | 1   | \$435.00  |
| 43169-10 | Trimble 2m. Carbon Fiber Pole                            | 1   | \$235.00  |
| 43169-30 | Trimble 2.5m. Carbon Fiber Telescopic Pole               | 1   | \$284.00  |
| 51003007 | Trimble 2.6m. Standard Robotic Telescopic Pole           | 1   | \$379.00  |
| 43169-00 | Trimble 2m. Carbon Fiber Pole w/ Bipod                   | 1   | \$470.00  |
| 43169-20 | Trimble 2.5m. Carbon Fiber Telescopic Pole w/ Bipod      | 1   | \$535.00  |
| 89848-00 | Trimble 2.0m. Carbon Fiber Pole w/ Quick Release Adapter | 1   | \$633.00  |





## Field Supplies & Accessories

### Prism Poles & Accessories (Continued)

#### Seco Prism Poles

| Part #          | Description  | Qty      | PLI Price        |
|-----------------|--|----------|------------------|
| 5160-02-WOR     | Seco 4ft. Range Pole - Orange & White                              | 1        | \$23.50          |
| 5150-02-WOR     | Seco 12ft. Range Pole - Orange & White                             | 1        | \$73.95          |
| 5530-10/5540-10 | Seco 8.5ft. Dual-Grad., Prism Pole Basic/Plus                      | 1        | \$92.65/\$158.35 |
| 5500-23         | Seco 2.7-5.1FT 115MM Mini Prism Pole                               | 1        | \$180.95         |
| 5540-20         | Seco 12ft. Dual-Grad., Ultralite Prism Pole w/ TLV Lock            | 1        | \$199.00         |
| 5500-21         | Seco 12ft. TLV Prism Pole - Red & White                            | 1        | \$195.00         |
| 5540-30         | Seco 15ft. Dual-Grad., Ultralite Prism Pole w/ TLV Lock            | 1        | \$315.85         |
| 5125-00-YEL     | Seco 2m. Two-Piece GPS Rover Rod - Standard Yellow                 | 1        | \$95.50          |
| 5125-06-YEL     | Seco 2m. GPS Rover Rod w/ Cable Slot - Standard Yellow             | 1        | \$116.95         |
| 5125-20-YEL-GT  | Seco 2m. Snap-Lock Rover Rod w/ Outer "GT" Grad. - Standard Yellow | 1        | \$129.95         |
| 5512-13-FLY-GM  | Seco GPS Pole, 2.6M, CM, TLV, 0MM, LP                              | 1        | \$194.95         |
| 5512-14-FOR-GT  | Seco Robotic Pole, 8.5ft, CM/.01, TLV, 135MM, LP                   | 1        | \$194.95         |
| 5128-20-GT      | Seco 2m. Snap-Lock Rover Rod w/ Outer "GT" Grad.                   | 1        | \$312.00         |
| 5145-00-FLY     | Seco 25cm. Prism Pole Extension/1.25in. OD - Flo. Yellow           | 1        | \$27.50          |
| 5132-00-ACL     | Seco 6in. Prism Pole Extension/1in. OD                             | 1        | \$27.50          |
| 5130-00-FLY     | Seco 1ft. Prism Pole Extension/1.25in. OD - Flo. Yellow            | 1        | \$29.50          |
| 5110-00-RED     | Seco 4ft. Prism Pole Extension/1.25in. OD - Red                    | 1        | \$35.95          |
| 5010-00-RED     | Seco 1ft. Mini Stakeout Prism Pole - Red                           | 1        | \$73.75          |
| <b>5530-30</b>  | <b>Seco 15ft. Twist-Lock Style Construction Series Prism Pole</b>  | <b>1</b> | <b>\$139.50</b>  |
| 5214-01         | Seco Gardner Rod Rest for 1.25in. Pole                             | 1        | \$179.95         |
| 5125-L-PLI-KIT  | Seco 2m. Prism Pole, Pole Bag & Bipod KIT                          | 1        | \$325.00         |



### Bipods

#### Seco/SitePro Bipods & Prism Tripods

| Part #      | Description                                 | Qty | PLI Price |
|-------------|---|-----|-----------|
| 07-4360     | SitePro Thumb-Release Aluminum Bipod        | 1   | \$142.00  |
| 5217-04-YEL | Seco Original Thumb Release Bipod - Yellow  | 1   | \$147.00  |
| 5217-05-YEL | Seco Mini Thumb Release Bipod - Yellow      | 1   | \$145.00  |
| 5214-00     | Seco Alligator Clamp Prism Pole Tripod      | 1   | \$49.95   |
| 5218-15-ABK | Seco Mini Simple Tripod w/ 12in. Legs       | 1   | \$70.15   |
| 5218-02-YEL | Seco Original Thumb Release Tripod - Yellow | 1   | \$171.95  |



### Hand Levels

#### Stabila Smart Levels - Voted Number 1 in Both Quality and Accuracy!

| Part #       | Description   | Qty | PLI Price         |
|--------------|---|-----|-------------------|
| 36524/ 36548 | Stabila 24in./48in. IP65 Digital TECH Level w/ Case | 1   | \$246.99/\$278.50 |
| 37424/37448  | Stabila 24in./48in. Type 196 Level                  | 1   | \$74.95/\$119.95  |
| 41048/ 41072 | Stabila 48in./72in. R-Beam Series Level             | 1   | \$135.50/\$203.95 |
| 34610/35712  | Stabila 6ft.-10ft./7ft.-12ft Magnetic Plate Level 2 | 1   | \$341.99/\$378.00 |



#### Seco Hand Levels

| Part #          | Description  | Qty | PLI Price        |
|-----------------|--|-----|------------------|
| 4050-01         | Seco Abney Level   | 1   | \$45.95          |
| 4040-60         | Seco 1x Hand Level (5in.) w/ 1x External Vial & Stadia           | 1   | \$61.50          |
| 4040-05/4040-30 | Seco 1x/2x Hand Level (5-7in. ext.) w/ 1x External Vial & Stadia | 1   | \$78.25/\$92.50  |
| 4200-00/4300-00 | Seco 2x Hand Level (5-7in. ext.) w/ 2x External Vial & Stadia    | 1   | \$111.95/\$12.95 |



#### Sokkia Hand Levels

| Part # | Description                                     | Qty | PLI Price |
|--------|---|-----|-----------|
| 804260 | Sokkia 5x Hand Level                            | 1   | \$156.56  |
| 804745 | Sokkia 6-3/8" Topographic Abney Level w/ 2 Arcs | 1   | \$200.85  |
| 804755 | Sokkia 5x Abney Level w/ Stadia                 | 1   | \$272.95  |





## Field Supplies & Accessories

### Automatic Levels, Transits & Theodolites

#### David White/SitePro Builders' & Utility Transits

| Part #                | Description  | Qty | PLI Price |
|-----------------------|--|-----|-----------|
| 46-D8871 (LT8-300P)   | David White/SitePro Builders' Transit - 26x Mag. w/ Optical Plum. & Case | 1   | \$856.00  |
| 46-D8872              | David White/SitePro Builders Transit - 26x Mag. w/ Laser Plum. & Case    | 1   | \$895.00  |
| 46-D8879              | David White/SitePro Utility Transit - 26x Mag. w/ Laser Plum. & Case     | 1   | \$920.00  |
| 46-D8877 (LT8-300LTU) | David White/SitePro Utility Transit - 26x Mag. w/ Optical Plum. & Case   | 1   | \$920.00  |



#### Leica Geosystems Automatic & Precision Levels

| Part # | Description   | Qty | PLI Price  |
|--------|---|-----|------------|
| 840381 | Leica NA320 20x Auto-Level w/ 360° Circle                             | 1   | \$219.00   |
| 840382 | Leica NA324 24x Auto-Level w/ 360° Circle                             | 1   | \$249.00   |
| 840383 | Leica NA332 32x Auto-Level w/ 360° Circle                             | 1   | \$299.00   |
| 352036 | Leica NA2 32x (Optional 40x) Universal Automatic Level w/ Accessories | 1   | \$3,300.00 |
| 352038 | Leica NAK2 Universal Automatic Level w/ Horizontal 360° Circle        | 1   | \$4,250.00 |



#### Nikon/Spectra Precision Automatic Levels & Theodolites

| Part #         | Description   | Qty | PLI Price  |
|----------------|---|-----|------------|
| AL-NIKON-AX-2S | Nikon Model AX-2S 20x Auto-Level w/ 360° Circle, Plumb Bob & Case | 1   | \$290.00   |
| AL-NIKON-AC-2S | Nikon Model AC-2S 24x Auto-Level w/ 360° Circle, Plumb Bob & Case | 1   | \$350.00   |
| AL-NIKON-AP-8  | Nikon Model AP-8 28x Auto-Level w/ 360° Circle, Plumb Bob & Case  | 1   | \$615.00   |
| AL-NIKON-AE-7  | Nikon Model AE-7 30x Auto-Level w/ Plumb Bob & Case               | 1   | \$1,189.00 |
| AL-NIKON-AS-2  | Nikon Model AS-2 34x Auto-Level w/ Plumb Bob & Case               | 1   | \$1,470.00 |
| NIKON-NE-100   | Nikon 10" Construction Theodolite w/ Case                         | 1   | \$1,995.00 |
| NIKON-NE-101   | Nikon 7" Construction/Survey Theodolite w/ Case                   | 1   | \$2,170.00 |
| DET-2          | Spectra Precision DET-2 2" Construction Theodolite                | 1   | \$1,150.00 |



### Nails & Fasteners

#### MagNails, Spikes, Hubs & Stake Tacks

| Part #      | Description                  | Qty   | PLI Price |
|-------------|------------------------------|-------|-----------|
| 24750       | 3/4in. x 1/8in. Mag Nails    | 100   | \$5.75    |
| 241000      | 1in. x 5/32in. Mag Nails     | 100   | \$7.50    |
| 241250      | 1 1/4in. x 3/16in. Mag Nails | 100   | \$10.95   |
| 241500      | 1 1/2in. x 1/4in. Mag Nails  | 100   | \$16.95   |
| 242000      | 2in. x 1/4in. Mag Nails      | 100   | \$18.50   |
| 242500      | 2 1/2in. x 1/4in. Mag Nails  | 100   | \$21.50   |
| 253MAGSPIKE | 3/8in. x 3in. Mag Spikes     | 25    | \$31.87   |
| 254MAGSPIKE | 3/8in. x 4 1/2in. Mag Spikes | 25    | \$39.37   |
| 256MAGSPIKE | 3/8in. x 6in. Mag Spikes     | 20    | \$39.45   |
| 258MAGSPIKE | 3/8in. x 8in. Mag Spikes     | 20    | \$45.95   |
| 23MAG-HUB4  | 3/16in. x 4in. Mag Hubs      | 30lb. | \$75.00   |
| 23MAG-HUB6  | 1/4in. x 6in. Mag Hubs       | 30lb. | \$75.00   |
| 23MAG-HUB8  | 1/4in. x 8in. Mag Hubs       | 30lb. | \$75.00   |
| 25456855    | Stake Tacks - 1lb. Box       | 1lb.  | \$9.95    |
| 2545644     | Stake Tacks - 5lb. Box       | 5lb.  | \$40.00   |



### Ask About Our Lunch & Learn Series!

Positioning technology is constantly evolving, and we're on the cutting edge to bring you the best available to get your jobs done efficiently, effectively, and accurately. Between all of the hardware, software, and techniques, it can be tough to keep up and keep working. That's why PLI is now offering our "Lunch & Learn" series!

■ 30-60 Minute Technical Presentations

■ Tailored to Your Interests

■ 1 PDH Available

Call 724.266.1600 or Email [PLI@laserinst.com](mailto:PLI@laserinst.com) to Learn More!





## Field Supplies & Accessories

### Tape Measures & Measuring Wheels

#### PIPE-MIC II Pipe Invert Measurement Solution

- Measurements are more accurate because you are measuring with a vertical plumb rod.
- Made for 25' SVR, USL rods and our new double sided PIPE-MIC II rod.
- Made of lightweight (two pounds) non-rusting aircraft aluminum.
- No tools needed to attach to rod. \*Slides on and off in seconds.
- Slices through material at bottom of pipe for accurate invert and pipe diameter measurement.

| Part #  | Description  | Qty | PLI Price |
|---------|--|-----|-----------|
| 1702PM2 | PIPE-MIC II Pipe Invert Measurement Solution w/ Zero and 1ft Vertical Offset Positions | 1   | \$215.00  |



#### Keson Tape Measures & Measuring Wheels

| Part #                  | Description   | Qty | PLI Price           |
|-------------------------|---|-----|---------------------|
| PGPRO1812V              | Keson 12ft. Nylon-Coated, Stainless Steel Housing, Hook-End <b>Short Tape</b> (ft., in., 1/8, 1/16 (1/32 first 12in.) Blade Type A1             | 1   | \$7.00              |
| PGT1816V                | Keson 16ft., Nylon-Coated, Hook-End <b>Short Tape</b> (ft., in., 1/8, 1/16 (1/32 first 12in.), Blade Type B1                                    | 1   | \$7.50              |
| PGT181025V              | Keson 25ft., Nylon-Coated, Stainless Steel Housing, Hook-End <b>Short Tape</b> (ft., 1/10, 1/100, ft., in., 1/8, 1/16) Blade Type B4            | 1   | \$10.00             |
| PGT1825V                | Keson 16ft., Nylon-Coated, Hook-End <b>Short Tape</b> (ft., in., 1/8, 1/16 (1/32 first 12in.) Blade Type B1                                     | 1   | \$10.00             |
| PG1025                  | Keson 25ft., Nylon-Coated, Hook-End <b>Short Tape</b> (ft., 1/10, 1/100) Blade Type B2  | 1   | \$11.95             |
| PGPRO1816V              | Keson 16ft., Nylon-Coated, Stainless Steel Housing, Hook-End <b>Short Tape</b> (ft., in., 1/8, 1/16 (1/32 first 12in.) Blade Type B1            | 1   | \$10.00             |
| PGPRO1825               | Keson 25ft., Nylon-Coated, Stainless Steel Housing, Hook-End <b>Short Tape</b> (ft., in., 1/8, 1/16 (1/32 first 12in.) Blade Type B1            | 1   | \$14.00             |
| PGPRO1830               | Keson 30ft., Nylon-Coated, Stainless Steel Housing, Hook-End <b>Short Tape</b> (ft., in., 1/8, 1/16 (1/32 first 12in.) Blade Type B1            | 1   | \$16.00             |
| OTR18100/<br>OTR10100   | Keson 100ft., <b>Standard Rewind</b> , Open-Type Reel, Ultra-Glass Blade, Hook-End, Fiberglass <b>Long Tape</b> (in./10ths.) Blade Type F1/F2   | 1   | \$18.95             |
| OTR18200/<br>OTR10200   | Keson 200ft., <b>Standard Rewind</b> , Open-Type Reel, Ultra-Glass Blade, Hook-End, Fiberglass <b>Long Tape</b> (in./10ths.) Blade Type F1/F2   | 1   | \$32.95             |
| OTR1810300/<br>OTR10300 | Keson 300ft., <b>Standard Rewind</b> , Open-Type Reel, Ultra-Glass Blade, Hook-End Fiberglass <b>Long Tape</b> (in./10ths.) Blade Type F1/F2    | 1   | \$40.00/<br>\$40.00 |
| OTRS1810100E            | Keson 100ft., <b>High-Speed (3x)</b> , Ring-End, FGL. <b>Long Tape</b> (in./10ths.)   | 1   | \$18.50             |
| OTRS1810200E            | Keson 200ft., <b>High-Speed (3x)</b> , Ring-End, FGL. <b>Long Tape</b> (in./10ths.)   | 1   | \$29.07             |
| OTRS1810300E            | Keson 300ft., <b>High-Speed (3x)</b> , Ring-End, FGL. <b>Long Tape</b> (in./10ths.)   | 1   | \$36.35             |
| NR10100/<br>NR10100E    | Keson 100ft., <b>Standard Rewind</b> , Nylon-Reinforced Steel, Ring-End <b>Long Tape</b> (ft., 1/10, 1/100) Blade Type E19/E2                   | 1   | \$46.69/<br>\$46.69 |
| NR10200H/<br>NR10200E   | Keson 20ft., <b>Standard Rewind</b> , Nylon-Reinforced Steel, Ring-End <b>Long Tape</b> (ft., 1/10, 1/100) Blade Type E19/E2                    | 1   | \$73.00             |
| NR30M                   | Keson 30m., Metric, Double-Nylon Coated Steel, Ring-End <b>Long Tape</b> (m., cm., mm.) Blade Type E17  | 1   | \$46.00             |
| NRS18M100               | Keson 100ft./60m., <b>High-Speed (3x)</b> , Nylon-Reinforced Steel, Hook-End <b>Long Tape</b> (ft., in., 1/8, m., cm., mm.) Blade Type E1 & E15 | 1   | \$56.00             |
| NRS18M200               | Keson 200ft./60m., <b>High-Speed (3x)</b> , Nylon-Reinforced Steel, Hook-End <b>Long Tape</b> (ft., in., 1/8, m., cm., mm.) Blade Type E1 & E15 | 1   | \$89.93             |
| NRS18300                | Keson 300ft., <b>High-Speed (3x)</b> , Nylon-Reinforced Steel, Hook-End <b>Long Tape</b> (ft., in., 1/8) Blade Type E1                          | 1   | \$121.29            |
| SNR18100                | Keson 100ft., Stainless-Steel Housing, Double Nylon-Coated Steel, Hook-End <b>Long Tape</b> (ft., in., 1/8)                                     | 1   | \$65.56             |
| SNR18200                | Keson 200ft., Stainless-Steel Housing, Double Nylon-Coated Steel, Hook-End <b>Long Tape</b> (ft., in., 1/8)                                     | 1   | \$98.35             |
| SNR10300                | Keson 300ft., Stainless-Steel Housing, Double Nylon-coated Steel, Hook-End <b>Long Tape</b> (ft., 1/10, 1/100)                                  | 1   | \$151.62            |
| SNR18300                | Keson 300ft., Stainless-Steel Housing, Double Nylon-Coated Steel, Hook-End <b>Long Tape</b> (ft., in., 1/8)                                     | 1   | \$151.62            |
| MP301                   | Keson 11-1/2in., 3ft. <b>Measuring Wheel</b> (ft.)  | 1   | \$119.00            |
| RRT12                   | Keson 3ft. <b>Measuring Wheel</b> (ft./in.)   | 1   | \$124.79            |
| RRT1210                 | Keson 3ft. <b>Measuring Wheel</b> (ft./10ths.)  | 1   | \$124.79            |
| MP401                   | Keson 15-1/2in., 4ft., Spoked <b>Measuring Wheel</b> (ft.)  | 1   | \$139.00            |

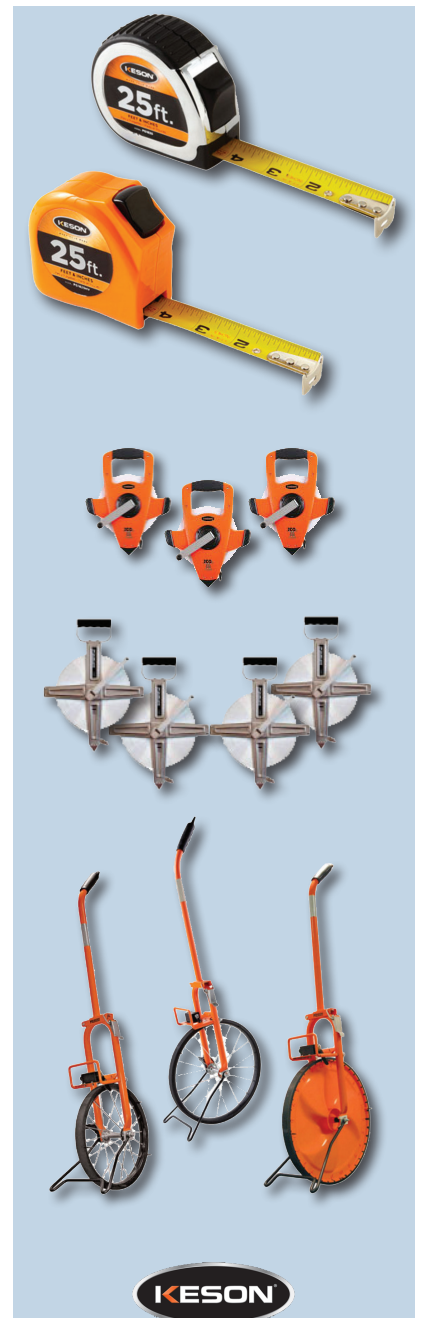





## Field Supplies & Accessories

### Tape Measures & Measuring Wheels (Continued)

#### Lufkin Tape Measures

| Part #   | Description  | Qty | PLI Price |
|----------|--|-----|-----------|
| PHV1312D | Lufkin 3/4in. x 12ft. Engineer Power Tape                  | 1   | \$10.50   |
| PHV1425D | Lufkin 1in. x 25ft. Engineer Power Tape                    | 1   | \$14.85   |
| P2133D   | Lufkin 1in. x 33ft. Engineer Power Tape                    | 1   | \$23.35   |
| Y1276    | Lufkin 1/4in. x 100ft. Peerless Yellow Clad Tape (ft./in.) | 1   | \$221.50  |
| C1276D   | Lufkin 1/4in. x 100ft. Peerless Chrome Clad Engineer Tape  | 1   | \$282.00  |
| Y1278    | Lufkin 1/4in. x 200ft. Peerless Yellow Clad Tape (ft./in.) | 1   | \$326.85  |
| C1278D   | Lufkin 1/4in. x 200ft. Peerless Chrome Clad Engineer Tape  | 1   | \$473.00  |
| 1066D    | Lufkin 5/8in. x 6ft. Engineer Wooden Folding Rule          | 1   | \$24.45   |
| 1066DM   | Lufkin 5/8in. x 2m. Engineer Wooden Rule                   | 1   | \$23.25   |



#### Rolatape Measuring Wheels

| Part #  | Description                               | Qty | PLI Price |
|---------|---|-----|-----------|
| 32-300S | Rolatape 11 1/4in. Single Measuring Wheel | 1   | \$90.50   |
| 32-400  | Rolatape 15 1/2in. Single Measuring Wheel | 1   | \$122.50  |
| 32-415  | Rolatape 15 1/2in. Single Measuring Wheel | 1   | \$127.50  |

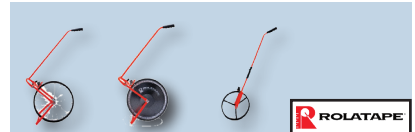

### Rebar & Rebar Caps

#### Rebar/Iron Pins

| Part #      | Description        | Qty | PLI Price |
|-------------|--------------------|-----|-----------|
| ZSE-5815REB | 5/8in x 15in Rebar | 16  | \$16.50   |
| 015812IB    | 5/8in x 12in Rebar | 20  | \$16.50   |
| ZSE-1230REB | 1/2in x 30in Rebar | 24  | \$32.00   |
| ZSE-5818REB | 5/8in x 18in Rebar | 25  | \$32.92   |
| ZSE-5830REB | 5/8in x 30in Rebar | 24  | \$49.50   |
| ZSE-3430REB | 3/4in x 30in Rebar | 16  | \$49.50   |



Note: Rebar pricing may vary.

#### Rebar Caps - Custom Imprints Available!

| Part #      | Description                              | Qty | PLI Price |
|-------------|--|-----|-----------|
| PLM-4-O-100 | 1/2in. Rebar Caps, 100Pk - <b>Orange</b> | 1   | \$34.00   |
| PLM-4-Y-100 | 1/2in. Rebar Caps, 100Pk - <b>Yellow</b> | 1   | \$34.00   |
| PLM-5-O-100 | 5/8in. Rebar Caps, 100Pk - <b>Orange</b> | 1   | \$36.99   |
| PLM-5-Y-100 | 5/8in. Rebar Caps, 100Pk - <b>Yellow</b> | 1   | \$36.99   |



## Excellence in Service Repair



We tackle annual cleaning and calibrations, full-on restorations, warranty repairs and EDM baseline testing, drawing on an extensive parts inventory.

**Schedule a Tour of our Service Centers!**

Pittsburgh, PA: 724.266.1600

Columbus, OH: 614.759.1000

Cincinnati, OH: 513.539.0022

Akron, OH: 330.633.4900





## Field Supplies & Accessories

### Marking Paint

#### Aervoe Marking Paint

| Part #  | Description   | Qty | PLI Price |
|---------|---|-----|-----------|
| 255     | Aervoe Construction Marking Paint - <b>White</b>                          | 12  | \$37.50   |
| 246     | Aervoe Construction Marking Paint - <b>Flo. Red</b>                       | 12  | \$37.50   |
| 258     | Aervoe Construction Marking Paint - <b>Yellow</b>                         | 12  | \$37.50   |
| 247     | Aervoe Construction Marking Paint - <b>Flo. Orange</b>                    | 12  | \$37.50   |
| 249     | Aervoe Construction Marking Paint - <b>Flo. Pink</b>                      | 12  | \$37.50   |
| 248     | Aervoe Construction Marking Paint - <b>Flo. Green</b>                     | 12  | \$37.50   |
| 250     | Aervoe Construction Marking Paint - <b>Blue</b>                           | 12  | \$37.50   |
| 220     | Aervoe Survey Marking Paint - <b>Flo. Red</b>                             | 12  | \$45.55   |
| 226     | Aervoe Survey Marking Paint - <b>Flo. Yellow</b>                          | 12  | \$45.55   |
| 222     | Aervoe Survey Marking Paint - <b>Flo. Orange</b>                          | 12  | \$45.55   |
| 229     | Aervoe Survey Marking Paint - <b>Flo. Pink</b>                            | 12  | \$45.55   |
| 224     | Aervoe Survey Marking Paint - <b>Flo. Green</b>                           | 12  | \$45.55   |
| 227     | Aervoe Survey Marking Paint - <b>Flo. Blue</b>                            | 12  | \$45.55   |
| 245     | Aervoe 32in. Marking Paint Stick  | 1   | \$20.10   |
| 710/720 | Aervoe Solvent-Based Striping Paint - <b>Traffic White Traffic Yellow</b> | 1   | \$55.35   |
| 790/791 | Aervoe Water-Based Striping Paint - <b>Traffic White Traffic Yellow</b>   | 1   | \$58.65   |
| 800A    | Aervoe Vers-A-Striper Pavement Paint Striping Cart                        | 1   | \$84.59   |
| 801A    | Aervoe Vers-A-Striper Turf & Durt Paint Striping Cart                     | 1   | \$92.81   |



### Lumber Crayons & Paint Sticks

#### Dixon Redimark Markers

| Part #  | Description                                       | Qty | PLI Price |
|---------|---|-----|-----------|
| 2887170 | Dixon 6in. Aluminum Barrel Markers - <b>Black</b> | 1Pk | \$19.95   |



#### Lumber Crayons & Paint Markers

| Part # | Description                    | Qty | PLI Price |
|--------|--------------------------------|-----|-----------|
| 10367  | Lumber Crayons - <b>Black</b>  | 12  | \$7.95    |
| 10365  | Lumber Crayons - <b>Red</b>    | 12  | \$7.95    |
| 10368  | Lumber Crayons - <b>Yellow</b> | 12  | \$7.95    |
| 10366  | Lumber Crayons - <b>Blue</b>   | 12  | \$7.95    |
| 10298  | Paint Markers - <b>White</b>   | 12  | \$46.46   |
| 10297  | Paint Markers - <b>Red</b>     | 12  | \$46.46   |
| 10299  | Paint Markers - <b>Yellow</b>  | 12  | \$46.46   |



### Survey Benchties & Hub Discs

#### Survey Benchties & Hub Discs

| Part #    | Description                              | Qty | PLI Price |
|-----------|--|-----|-----------|
| 24HUBDISC | Discs are in packages of 100 - Hole 1/8" | 1   | \$13.95   |
| 2700Y     | Yellow Benchties                         | 1   | \$65.95   |



### Brass Survey Markers

#### Brass Survey Markers

| Part #   | Description                    | Qty | PLI Price |
|----------|--------------------------------|-----|-----------|
| C/M-1.5B | 1 1/2in. Flat Top Brass Marker | 1   | \$6.89    |
| C/M-2B   | 2in. Flat Top Brass Marker     | 1   | \$12.15   |





## Field Supplies & Accessories

### Brass Survey Markers (Continued)

SitePro Survey Markers - Free Numerical Stamping Available!

| Part # | Description   | Qty | PLI Price |
|--------|---|-----|-----------|
| 19-700 | SitePro 1 3/8in. (34.9mm.) Brass Survey Marker - Flat Head  | 1   | \$8.00    |
| 19-701 | SitePro 2in. (50.8mm.) Brass Survey Marker - Flat Head      | 1   | \$8.50    |
| 19-702 | SitePro 2 1/2in. (63.5mm.) Brass Survey Marker - Flat Head  | 1   | \$10.00   |
| 19-703 | SitePro 3" (76.2mm.) Brass Survey Marker - Flat Head        | 1   | \$10.50   |
| 19-705 | SitePro 2in. (50.8mm.) Brass Survey Marker - Domed Head     | 1   | \$11.50   |
| 19-706 | SitePro 2 1/2in. (63.5mm.) Brass Survey Marker - Domed Head | 1   | \$12.50   |
| 19-707 | SitePro 3in. Dome Brass Survey Marker - Domed Head          | 1   | \$16.50   |



### Wood Hubs, Flats, Lath & Stakes

Wood Hubs, Flats, Lath & Stakes - Big Project? Call for Quantity Discounts!

| Part #   | Description  | Qty   | PLI Price   |
|----------|--|-------|-------------|
| ZSE2209H | 2in. x 2in. x 9in. Wood Hubs                                 | 25    | \$12.95     |
| ZSE2212H | 2in. x 2in. x 12in. Wood Hubs                                | 25    | \$13.95     |
| ZSE2218  | 2in. x 2in. x 18in. Wood Hubs                                | 25    | \$19.50     |
| ZSE1224F | 1in. x 2in. x 24in. Wood Flats                               | 25    | \$16.25     |
| ZSE18F   | 1in. x 2in. x 18in. Wood Flats                               | 50    | \$26.95     |
| ZSE36L   | 1/2in. x 1 1/2in. x 36in. Wood Lath                          | 50    | \$29.95     |
| ZSE36L   | 1/2in. x 1 1/2in. x 36in. Wood Lath (FULL PALLET) 60 BUNDLES | 3,000 | PLEASE CALL |
| ZSE48L   | 1/2in. x 1 1/2in. x 48in. Wood Lath                          | 50    | \$34.25     |
| ZSE48L   | 1/2in. x 1 1/2in. x 48in. Wood Lath (FULL PALLET) 48 BUNDLES | 2,400 | PLEASE CALL |



### Drafting Supplies

Alvin Pentel Pencils, Scales & Templates

| Part # | Description   | Qty | PLI Price |
|--------|---|-----|-----------|
| P205-A | Alvin Pentel Sharp 0.5mm. Black Barrel Drafting Pencil          | 1   | \$5.50    |
| P205-B | Alvin Pentel Sharp 0.5mm. Red Barrel Drafting Pencil            | 1   | \$5.50    |
| P205-D | Alvin Pentel Sharp 0.5mm. Green Barrel Drafting Pencil          | 1   | \$5.50    |
| P207-C | Alvin Pentel Sharp 0.7mm. Blue Barrel Drafting Pencil           | 1   | \$5.50    |
| P209-G | Alvin Pentel Sharp 0.9mm. Yellow Barrel Drafting Pencil         | 1   | \$5.50    |
| 3010-1 | Alvin 6in. Silver Aluminum Triangular Scale - Architect         | 1   | \$4.95    |
| 3210-1 | Alvin 6in. Silver Aluminum Triangular Scale - Engineer          | 1   | \$4.95    |
| 40MTS  | Alvin 40 Series 4in. Mini Hardwood Triangular Scale - Architect | 1   | \$12.95   |
| 41MTS  | Alvin 40 Series 4in. Mini Hardwood Triangular Scale - Engineer  | 1   | \$12.95   |
| 266P   | Alvin 6in. White Plastic Flat Architect Scale                   | 1   | \$11.63   |
| 245B   | Alvin 12in. Bamboo Engineer Triscale                            | 1   | \$23.95   |
| 41T    | Alvin Timely Small Shapes Template                              | 1   | \$1.50    |
| TD116  | Alvin All-Purpose Template                                      | 1   | \$7.50    |



**ALL the Field Supplies You Need, Fast**  
**WWW.LASERINST.COM**

Place Your Order Today & Get Your Project Moving!

|  |  |
|--|--|
| • MagNails, MagSpikes & MagHubs              | • Measuring Tapes & Wheels                     |
| • Safety Vests, Glasses & Hard Hats          | • Rolled Flagging, Wire Flagging & Whiskers    |
| • Paint Markers, Lumber Crayons & Templates  | • Tripods, Bipods & Grade Rods                 |
| • Field Bags-Lath, Tripod & Equip. Backpacks | • Pallet Pricing Available on Wood Lath/Stakes |

LOCAL-AREA PICKUP AND DELIVERY FOR SALES, RENTALS AND SERVICE\*!

\*LIMITED DELIVERY AREAS. CALL 724.266.1600 FOR DETAILS.



## Field Supplies & Accessories

### Flagging & Whiskers

#### Wire Flags

| Part #  | Description                               | Qty | PLI Price |
|---------|---|-----|-----------|
| 15282-I | 4x5x21in. Wire Flags - <b>White</b>       | 100 | \$10.95   |
| 15073-I | 4x5x21in. Wire Flags - <b>Yellow</b>      | 100 | \$10.95   |
| 15090-I | 4x5x21in. Wire Flags - <b>Flo. Orange</b> | 100 | \$10.95   |
| 15091-I | 4x5x21in. Wire Flags - <b>Pink</b>        | 100 | \$10.95   |
| 15074-I | 4x5x21in. Wire Flags - <b>Blue</b>        | 100 | \$10.95   |

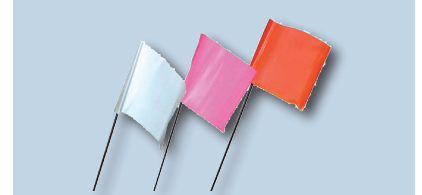

#### Mutual Industries Aerial Flagging

| Part #                    | Description  | Qty | PLI Price            |
|---------------------------|--|-----|----------------------|
| 16006-10-12 (-24)         | Mutual Industries 12in. (24in) Aerial Flagging - <b>HD White</b> | 1   | \$31.85<br>(\$61.15) |
| 15500-0-48/<br>15000-0-48 | Mutual Industries 48in. Aerial Target - Bullseye/Iron Cross      | 1   | \$16.46              |



#### Presco Rolled Flagging & Whiskers

| Part #                   | Description  | Qty | PLI Price           |
|--------------------------|--|-----|---------------------|
| TXW1500                  | Presco Rolled Flagging - <b>Standard White</b>                             | 12  | \$17.50             |
| TXR1300                  | Presco Rolled Flagging - <b>Standard Red</b>                               | 12  | \$17.50             |
| TXY1400STD               | Presco Rolled Flagging - <b>Standard Yellow</b>                            | 12  | \$17.50             |
| TXG1300                  | Presco Rolled Flagging - <b>Standard Green</b>                             | 12  | \$17.50             |
| TXB1000STD               | Presco Rolled Flagging - <b>Standard Blue</b>                              | 12  | \$17.50             |
| TXPP1700                 | Presco Rolled Flagging - <b>Standard Purple</b>                            | 12  | \$17.50             |
| TXRG1600                 | Presco Rolled Flagging - <b>GLO Red</b>                                    | 12  | \$17.50             |
| TXYG1400                 | Presco Rolled Flagging - <b>GLO Yellow</b>                                 | 12  | \$17.50             |
| TXOG1200                 | Presco Rolled Flagging - <b>GLO Orange</b>                                 | 12  | \$17.50             |
| TXPG1300                 | Presco Rolled Flagging - <b>GLO Pink</b>                                   | 12  | \$17.50             |
| TXLG1100                 | Presco Rolled Flagging - <b>GLO Lime</b>                                   | 12  | \$17.50             |
| TXBG1000                 | Presco Rolled Flagging - <b>GLO Blue</b>                                   | 12  | \$17.50             |
| SWO                      | Presco Rolled Flagging - <b>White Orange Striped</b>                       | 12  | \$19.95             |
| SWB (SWR)                | Presco Rolled Flagging - <b>White Blue Striped (White Red Striped)</b>     | 12  | \$19.80             |
| SYBK (SWBK)              | Presco Rolled Flagging - <b>Black Yellow Striped (Black White Striped)</b> | 12  | \$19.80             |
| SOBK (SOGBK)             | Presco Rolled Flagging - <b>Black Orange Striped (Black GLO Orange)</b>    | 12  | \$19.80             |
| SPGW                     | Presco Rolled Flagging - <b>White Pink Striped</b>                         | 12  | \$22.15             |
| ARW1500                  | Presco Rolled Flagging - Arctic <b>GLO White</b>                           | 12  | \$22.50             |
| ARRG1600                 | Presco Rolled Flagging - Arctic <b>GLO Red</b>                             | 12  | \$22.50             |
| ARYG1400/<br>AROG1200    | Presco Rolled Flagging - Arctic <b>GLO Yellow / GLO Orange</b>             | 12  | \$22.50             |
| ARPG1300                 | Presco Rolled Flagging - Arctic <b>GLO Pink</b>                            | 12  | \$22.50             |
| ARLG1100/<br>ARBG1000    | Presco Rolled Flagging - Arctic <b>GLO Lime / GLO Blue</b>                 | 12  | \$21.05<br>/\$22.50 |
| WHIS6W1000-<br>(100 PK)  | Presco 6in. Whisker (100 Pack) - <b>White</b>                              | 100 | \$12.15             |
| WHIS6Y1000-<br>(100 PK)  | Presco 6in. Whisker (100 Pack) - <b>Yellow</b>                             | 100 | \$12.15             |
| WHIS6OG1000-<br>(100 PK) | Presco 6in. Whisker (100 Pack) - <b>GLO Orange</b>                         | 100 | \$12.15             |
| WHIS6PG1000-<br>(100 PK) | Presco 6in. Whisker (100 Pack) - <b>GLO Pink</b>                           | 100 | \$12.15             |
| WHIS6G1000-<br>(100 PK)  | Presco 6in. Whisker (100 Pack) - <b>Green</b>                              | 100 | \$12.15             |
| WHIS6B1000-<br>(100 PK)  | Presco 6in. Whisker (100 Pack) - <b>Blue</b>                               | 100 | \$12.15             |





## Field Supplies & Accessories

### Field Books & Binders

#### Elan Field Books & Binders

| Part #             | Description                                    | Qty | PLI Price |
|--------------------|--|-----|-----------|
| E64-8x4F/ E64-8x8F | Elan Field Book Filler                         | 1   | \$3.69    |
| E64-8x4S           | Elan Economy Field Book                        | 1   | \$4.50    |
| E64-8x4WB          | Elan Field Book (425) - Wire Bound             | 1   | \$4.50    |
| E64-8x4B-I         | Elan Book - Single                             | 1   | \$7.15    |
| E64-4x4B-I         | Elan Field Book - Single                       | 1   | \$7.15    |
| E64-64             | Elan Level Book Individual                     | 1   | \$7.15    |
| 323                | Elan 2in. Standard 6-Ring Binder w/ Poly Cover | 1   | \$8.49    |
| E64-64PK/E64-8x4B  | Elan Level Book (6 Pack)                       | 6   | \$42.90   |

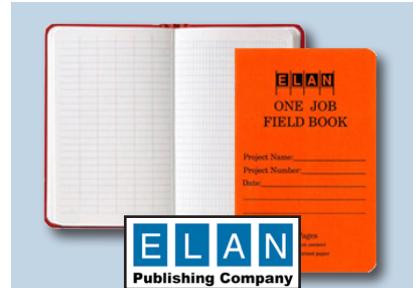

#### Rite in the Rain Field Books & Binders

| Part #    | Description                                       | Qty | PLI Price       |
|-----------|---|-----|-----------------|
| 200-RB    | Rite in the Rain Field Ring Binder                | 1   | \$13.79         |
| 302       | Rite in the Rain Transit Pattern Refill (100)     | 1   | \$13.95         |
| 300F/310F | Rite in the Rain Transit/Level Pattern Bound Book | 1   | \$22.95/\$22.95 |



#### Sokkia Field Books

| Part #        | Description                     | Qty | PLI Price      |
|---------------|---------------------------------|-----|----------------|
| 815200/-(6PK) | Sokkia 8x4 Field Book/6 Pack    | 1/6 | \$6.15/\$36.85 |
| 815260        | Sokkia Field Book               | 1   | \$7.15         |
| 815255/-(6PK) | Sokkia 64-64 Level Books/6 Pack | 1/6 | \$7.15/\$42.83 |
| 815230        | Sokkia Engineers Field Book     | 1   | \$8.51         |



### Carrying Cases & Bags

#### Hard Protective Cases

| Part #   | Description  | Qty | PLI Price |
|----------|--|-----|-----------|
| 915-1004 | Hard Case, Medium - 915 Yellow 13.8" L x 9.3" W x 6.2" H | 1   | \$99.95   |
| 925-1004 | Hard Case, Large - 925 Yellow 17" L x 11.8" W x 6.4" H   | 1   | \$132.50  |
| 940-1004 | Hard Case, Extra Large - 940 Yellow 20" L x 14" W x 8" H | 1   | \$163.95  |



#### Seco Field Bags

| Part #      | Description   | Qty | PLI Price |
|-------------|---|-----|-----------|
| 8098-00-ORG | Seco Spray Can Holster Case                             | 1   | \$10.75   |
| 8098-10-ORG | Seco Spray Can Holder w/ Pockets                        | 1   | \$18.85   |
| 8143-22-FLY | Seco Cell Phone/GPS Case                                | 1   | \$14.35   |
| 8070-00-ORG | Seco Single Prism Bag                                   | 1   | \$34.15   |
| 8080-00-ORG | Seco Triple Prism Bag (9in. x7in. x2in.)                | 1   | \$37.75   |
| 8081-00-ORG | Seco Jumbo Prism Bag                                    | 1   | \$52.15   |
| 8130-00-ORG | Seco Extra Tall Prism Bag                               | 1   | \$54.85   |
| 8082-00-ORG | Seco Super Jumbo Padded Prism Bag, Orange               | 1   | \$61.15   |
| 8071-00-ORG | Seco Optical Plummet Tribrach Case (6in. x 6in. x 2in.) | 1   | \$34.15   |
| 8100-00-ORG | Seco 8in. ID x 36in. Lath Bag w/ Pocket                 | 1   | \$35.75   |
| 8101-00-ORG | Seco 8in. ID x 48in. Lath Bag w/ Pocket                 | 1   | \$41.35   |
| 8103-20-ORG | Seco 24in. Heavy Duty Lath Bag w/ Pockets               | 1   | \$44.95   |
| 8100-20-ORG | Seco 36in. Heavy Duty Rhinotek Lath Bag                 | 1   | \$44.95   |
| 8101-20-ORG | Seco 48in. Heavy Duty Rhinotek Lath Bag                 | 1   | \$48.55   |
| 8150-20-ORG | Seco Heavy Duty Tripod Bag                              | 1   | \$59.35   |
| 8154-11-ORG | Seco Large Tripod Bag                                   | 1   | \$55.75   |
| 8180-20-ORG | Seco Heavy Duty Tripod/Prism Pole Bag                   | 1   | \$55.75   |
| 8154-12-ORG | Seco Heavy Duty GPS Tripod Bag                          | 1   | \$95.35   |
| 8120-30-ORG | Seco Back Pack Total Station Bag                        | 1   | \$247.45  |
| 8120-40-ORG | Seco 500mm. Total Station RuckSack                      | 1   | \$267.25  |





## Field Supplies & Accessories

### Safety Glasses

#### Lift Safety Glasses

| Part #     | Description                                     | Qty | PLI Price |
|------------|---|-----|-----------|
| ESR-6ST    | Lift Strobe Safety Glasses - <b>SilverSmoke</b> | 1   | \$8.00    |
| ESR-12CFST | Lift Strobe Safety Glasses - <b>CamoSmoke</b>   | 1   | \$8.50    |
| ESE-9M     | Lift Sectorlite Safety Glasses - <b>Mirror</b>  | 1   | \$6.50    |
| EFR-6ST    | Lift Flanker Safety Glasses - <b>Smoke</b>      | 1   | \$7.00    |
| EQT-12KST  | Lift Quest Safety Glasses - <b>BlackSmoke</b>   | 1   | \$6.50    |
| EQT-12CFST | Lift Quest Safety Glasses - <b>CamoSmoke</b>    | 1   | \$7.00    |



### Hard Hats

#### Lift Hard Hats

| Part #    | Description   | Qty | PLI Price |
|-----------|---|-----|-----------|
| HBFE-7W   | Lift Briggs Full Brim Hard Hat - <b>White</b>                 | 1   | \$14.60   |
| HBFE-7L   | Lift Briggs Full Brim Hard Hat - <b>Yellow</b>                | 1   | \$14.60   |
| HBSE-7W   | Lift Briggs Short Brim Hard Hat - <b>White</b>                | 1   | \$12.99   |
| HBSE-7L   | Lift Briggs Short Brim Hard Hat - <b>Yellow</b>               | 1   | \$12.99   |
| HDF-15NG  | Lift Dax Fiber Resin Full Brim Hard Hat - <b>Natural</b>      | 1   | \$84.62   |
| HDF-15WG  | Lift Dax Fiber Resin Full Brim Hard Hat - <b>Gloss White</b>  | 1   | \$84.62   |
| HDFM-17KG | Lift Dax Carbon Fiber Full Brim Hard Hat - <b>Matte Black</b> | 1   | \$146.00  |



#### MSA Hard Hats

| Part #            | Description  | Qty | PLI Price |
|-------------------|--|-----|-----------|
| 24202/24206/24201 | MSA V-Gard Hard Hat - <b>White / Yellow / Orange</b> | 1   | \$22.39   |



### Safety Vests

#### Seco Safety Vests

| Part #      | Description  | Qty | PLI Price |
|-------------|--|-----|-----------|
| 8292-50-FLY | Seco Class 2 Safety Vest, L - <b>Flo. Yellow</b>                   | 1   | \$23.35   |
| 8292-54-FLY | Seco Class 2 Safety Vest, XL - <b>Flo. Yellow</b>                  | 1   | \$23.35   |
| 8292-58-FLY | Seco Class 2 Safety Vest, XXL - <b>Flo. Yellow</b>                 | 1   | \$25.15   |
| 8265-42-FLY | Seco Class 2 ANSI Survey Vest, S - <b>Flo. Yellow</b>              | 1   | \$99.95   |
| 8265-42-FOR | Seco Class 2 ANSI Survey Vest, S - <b>Flo. Orange</b>              | 1   | \$99.95   |
| 8265-46-FLY | Seco Class 2 ANSI Survey Vest, M - <b>Flo. Yellow</b>              | 1   | \$99.95   |
| 8265-46-FOR | Seco Class 2 ANSI Survey Vest, M - <b>Flo. Orange</b>              | 1   | \$99.95   |
| 8265-50-FLY | Seco Class 2 ANSI Survey Vest, L - <b>Flo. Yellow w/ Stripe</b>    | 1   | \$99.95   |
| 8265-50-FOR | Seco Class 2 ANSI Survey Vest, L - <b>Flo. Orange w/ Stripe</b>    | 1   | \$99.95   |
| 8265-54-FLY | Seco Class 2 ANSI Survey Vest, XL - <b>Flo. Yellow</b>             | 1   | \$99.95   |
| 8265-54-FOR | Seco Class 2 ANSI Survey Vest, XL - <b>Flo. Orange</b>             | 1   | \$99.95   |
| 8265-58-FLY | Seco Class 2 ANSI Survey Vest, XXL - <b>Flo. Yellow</b>            | 1   | \$104.00  |
| 8265-58-FOR | Seco Class 2 ANSI Survey Vest, XXL - <b>Flo. Orange</b>            | 1   | \$104.00  |
| 8265-62-FLY | Seco Class 2 ANSI Survey Vest, XXXL - <b>Flo. Yellow w/ Stripe</b> | 1   | \$104.00  |
| 8365-46-FLY | Seco Class 3 ANSI Survey Vest, M - <b>Flo. Yellow</b>              | 1   | \$115.00  |
| 8365-50-FLY | Seco Class 3 ANSI Survey Vest, L - <b>Flo. Yellow</b>              | 1   | \$115.00  |
| 8365-54-FLY | Seco Class 3 ANSI Survey Vest, XL - <b>Flo. Yellow</b>             | 1   | \$115.00  |
| 8365-58-FLY | Seco Class 3 ANSI Survey Vest, XXL - <b>Flo. Yellow</b>            | 1   | \$118.00  |



#### SitePro Safety Vests

| Part #     | Description   | Qty | PLI Price |
|------------|---|-----|-----------|
| 23-500-L   | SitePro Light Weight Construction Vest, L - <b>Lime</b>   | 1   | \$11.50   |
| 23-500-XL  | SitePro Light Weight Construction Vest, XL - <b>Lime</b>  | 1   | \$11.50   |
| 23-500-XXL | SitePro Light Weight Construction Vest, XXL - <b>Lime</b> | 1   | \$12.30   |
| 23-550-L   | SitePro Survey Vest w/ Pockets, L - <b>Lime</b>           | 1   | \$50.75   |
| 23-550-XL  | SitePro Survey Vest w/ Pockets, XL - <b>Lime</b>          | 1   | \$50.75   |
| 23-550-XXL | SitePro Survey Vest w/ Pockets, XXL - <b>Lime</b>         | 1   | \$50.75   |





## Field Supplies & Accessories

### Two-Way Radios

#### SitePro Safety Vests

| Part #  | Description   | Qty | PLI Price |
|---------|---|-----|-----------|
| 53862   | Motorola Remote Speaker Microphone                              | 1   | \$62.95   |
| RMV2080 | Motorola Radio - VHF 2-Watt/8-Channels/Non-Display              | 1   | \$245.00  |
| RMU2080 | Motorola Radio - UHF 2-Watt/8-Channels/Display                  | 1   | \$290.00  |
| DTR410  | Motorola Digital Radio - Up to 100 Contacts (Private/Group)     | 1   | \$319.00  |
| RDV5100 | Motorola Radio - HF 2-5 Watts/10-Channel/Non-Display/Repeater   | 1   | \$325.00  |
| DTR550  | Motorola Digital Radio - Up to 150 Contacts (Private/Group)     | 1   | \$349.00  |
| RDU4100 | Motorola Radio - UHF 2-4 Watts/10-Channels/Non-Display/Repeater | 1   | \$360.00  |



### Road Signs & Accessories

#### Mesh Road Signs & Accessories

| Part #      | Description                                  | Qty | PLI Price |
|-------------|--|-----|-----------|
| 36M-MS-OLAH | 36in. x 36in. "One Lane Ahead" sign          | 1   | \$41.95   |
| 36M-MS-FAA  | 36in. x 36in. Mesh "Flagger Ahead" Sign      | 1   | \$41.95   |
| 36M-MS-SCA  | Mesh "Survey Crew Ahead" Sign                | 1   | \$41.95   |
| 48M-MS-WAA  | 48in. x 48in. Mesh Sign w/ "Work Area Ahead" | 1   | \$49.50   |
| 48M-MS-SCA  | 48in. x 48in. Mesh "Survey Crew Ahead" Sign  | 1   | \$49.50   |
| MS-RIGID-30 | Compact Sign Base                            | 1   | \$143.00  |



#### Road Signs, Cones & Lights

| Part #       | Description                                       | Qty | PLI Price |
|--------------|---|-----|-----------|
| 12PVCS-G     | 12in. 1.5lb Traffic Cone - Green                  | 1   | \$6.29    |
| PC500-2-A    | Pyralite Flash Magnetic Light - Amber             | 1   | \$90.12   |
| SSP-1        | 24in Octagonal Stop/Slow Paddle, Reflectorized    | 1   | \$74.00   |
| SSP-1T       | 24in Oct. Stop/Slow Paddle, Reflect. & Telescopic | 1   | \$92.00   |
| 272895       | WAP-Class 1 Amber Strobe, Med. Profile            | 1   | \$140.99  |
| WAMINIFL-C   | LED Mini Light Bar                                | 1   | \$178.50  |
| WAMINIFLM-C  | LED Mini Light Bar (Magnetic)                     | 1   | \$200.82  |
| WAMMB S35M-A | Low Pro Strobe Mini Light Bar (Magnetic)          | 1   | \$233.85  |
| 272876       | Amber Light                                       | 1   | \$123.50  |



#### Road Sign & Spring Base

This single spring sign stand has Step-n-Drop legs. It also comes with the traditional latch bracket connector for plastic corner pockets, or the universal sign holder which is ideal for sewn corner pockets. (25 lbs.)

| Part #        | Description                                | Qty | PLI Price |
|---------------|--|-----|-----------|
| 4026048-EV-HF | 48x48 Survey Crew Ahead Sign               | 1   | \$85.00   |
| 4022300       | Road Sign Base w/ Spring & Extendible Legs | 1   | \$177.10  |



### Survey Vehicle Accessories

#### Aluminum Survey Truck Boxes

Designed Specifically for Surveyors.  
Features Heavy-Duty Aluminum Construction.  
Store Tripods, Lath, Poles, Instruments & More!  
Call 412.861.6534 for More Information!

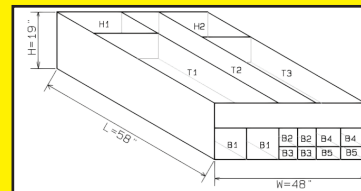

| Part # | Description  | Qty | PLI Price  |
|--------|--|-----|------------|
| 4858   | Logix Box 48in. x 58in. Aluminum Survey Box (Truck-Specific) | 1   | \$1,667.00 |





## Field Supplies & Accessories

### Hand Tools

#### Bully Tools Hand Tools

| Part # | Description                               | Qty | PLI Price |
|--------|---|-----|-----------|
| 99206  | Water Key, T-Style Handle, 36in.          | 1   | \$16.77   |
| 99207  | Water Key, T-Style Handle, 48in.          | 1   | \$19.72   |
| 99202  | Soil Probe, T-Style Handle, 36in.         | 1   | \$16.78   |
| 99203  | Soil Probe, T-Style Handle, 48in.         | 1   | \$18.77   |
| 99204  | Soil Probe, T-Style Handle, 60in.         | 1   | \$22.71   |
| 99200  | Manhole Cover Hook, T-Style Handle, 24in. | 1   | \$17.75   |



#### Council Tool Hand Tools

| Part #  | Description  | Qty | PLI Price |
|---------|--|-----|-----------|
| PR40    | Council Tool 4lb. Engineer Hammer w/ 15in. Wooden Handle   | 1   | \$19.35   |
| PR40FG  | Council Tool 4lb. Engineer Hammer w/ Fiberglass Handle     | 1   | \$22.43   |
| PR600   | Council Tool 6lb. Sledge Hammer w/ 36in. Wooden Handle     | 1   | \$25.85   |
| PR600FG | Council Tool 6lb. Sledge Hammer w/ 34in. Fiberglass Handle | 1   | \$26.92   |
| PR800FG | Council Tool 8lb. Sledge Hammer w/ 34in. Fiberglass Handle | 1   | \$40.00   |
| 1436    | Council Tool Ditch Bank, 14in. Blade, 36in. Wooden Handle  | 1   | \$39.12   |



#### Machetes, Manhole Hooks, Brush Axes & Frost Pins

| Part #       | Description  | Qty | PLI Price |
|--------------|--|-----|-----------|
| 442P-MA22    | 22in. Machete  | 1   | \$16.00   |
| 442P-MA24    | 24in. Machete  | 1   | \$17.95   |
| 44MA22SHEATH | 22in. Leather Machete Sheath w/ Belt Loop              | 1   | \$23.00   |
| 44MA24SHEATH | 24in. Leather Machete Sheath w/ Belt Loop              | 1   | \$24.95   |
| 33045        | Swedish Brush Axe                                      | 1   | \$55.50   |
| 4418RT       | Red Top Frost Pin                                      | 1   | \$26.50   |
| 4418GD       | Red Top Square Gad                                     | 1   | \$32.00   |
| 4432DP       | Red Top Manhole Hook, Diamond Point Tip                | 1   | \$29.95   |
| 4432FH       | Red Top Manhole Hook, Curved w/ 36in. Handle, Flat Top | 1   | \$29.95   |



#### New! Easy-Off Manhole Cover Remover

##### Operating Instructions:

1. Secure the "J" hook through the hole of the manhole cover.
2. Position shaft over manhole, take up the chain slack and attach to "S" hook
3. Pull back on Easy Off handle, displacing cover.
4. Move tool away from manhole until chain is tight and repeat. *It's that easy!*

| Part # | Description                    | Qty | PLI Price |
|--------|--------------------------------|-----|-----------|
| 273995 | Easy-Off Manhole Cover Remover | 1   | \$136.50  |



#### Easy-Off Manhole Cover Hook

This tool is designed to remove stubborn manhole covers manually. Just insert the hook under the groove of the lid and pull upwards. The hook is made of high-grade hexagon tool steel that has been properly hardened to prevent bending under stress.

#### Ontario Knife Company Machetes

| Part # | Description                                    | Qty | PLI Price |
|--------|--|-----|-----------|
| BSH18  | OKC 18in., Heavy Duty Nylon Sheath w/ Loop     | 1   | \$12.00   |
| BSH22  | OKC 22in., Heavy Duty Nylon Sheath w/ Loop     | 1   | \$13.00   |
| 6145   | OKC 18in., Open-Handle Military Machete        | 1   | \$23.50   |
| 8294   | OKC 22in., Open-Handle Machete                 | 1   | \$24.50   |
| 8516   | OKC 18in., Orange D-Handle Machete             | 1   | \$25.25   |
| 8520   | OKC 22in., Orange D-Handle, Heavy Duty Machete | 1   | \$26.00   |
| 6120   | OKC 18in., Sawback Machete                     | 1   | \$26.50   |







## Field Supplies & Accessories

### Hand Tools (Continued)

#### Seco/Estwing Hand Tools

| Part #  | Description                      | Qty | PLI Price |
|---------|----------------------------------|-----|-----------|
| 9070-08 | Estwing Engineer's Hammer, 48oz. | 1   | \$32.95   |
| 9070-03 | Estwing 13in. Rock Pick          | 1   | \$37.95   |
| 9070-00 | Estwing Axe w/ Leather Sheath    | 1   | \$50.95   |



#### SitePro Hand Tools

| Part #      | Description                       | Qty | PLI Price |
|-------------|-----------------------------------|-----|-----------|
| 17-EWB3-4LB | SitePro 4lb. Drilling/Club Hammer | 1   | \$35.00   |



### Alternative Leveling Solutions

#### ZIPLEVELS

| Part #   | Description                                | Qty | PLI Price |
|----------|--|-----|-----------|
| PRO-2000 | ZIPLEVEL Pro 2000 Elevation w/ Accessories | 1   | \$899.00  |



#### Introducing the ZIPLEVEL!

Set up in Seconds, Finish in Minutes, by YOURSELF!



Unpack, Power-On, & Zero at a Reference Point



Read Deviations from Level Plane



Pack-Up & Go!

Impact & Water Resistant

Single Setup Vertical Range of 40ft Over a 200ft Circle

Jobsite Rugged Operation -22°F to +158°F for Months on 1 9V Battery



Included Unipod Lets You Measure While Standing



Displays Elevations in Your Preferred Scale

Unlike a rotary laser, ZIPLEVEL® lets you truly work alone to quickly and easily level and read elevations directly in unmistakably clear digits. NO MORE rods, tripods, sensors, line-of-sight, error with distance, factory calibration or tedious computations. Now you can measure over any distance or elevation on earth, from paper thickness to the height of a mountain without error-inducing tabulation or math. **To Learn More, Contact: 412.861.6534!**

## Used Equipment Refurbished. Recalibrated. Ready to Work.

[www.laserinst.com/used](http://www.laserinst.com/used)

Serviced by Our Factory-Trained Technicians! Package Pricing or Individual Units!

Receivers to Robots!

**90-Day Warranties  
on Used Equipment!**  
(Optional Extended Warranties)

Updated Weekly!

\*Limited delivery areas. Please call 724.266.1600 for more information

**Need Help with Setup or Troubleshooting Your Equipment?  
Visit Our Support Page!**

- Online Support Library for Common Problems

- Contact Info for Our Industry Support Reps

**Submit a Support Request Ticket!**

[www.laserinst.com/support](http://www.laserinst.com/support)





## Construction Layout Solutions

### Leveling Lasers



#### Rugby 610 & 620

**Key Features:**

- One-button operation
- Superb performance w/ Rod Eye receivers
- Wide working range of 2,000ft (600m) using Rod Eye 140/160 receivers
- IP67 Rating
- Self-leveling
- 40-60 Hour operation

Rugby 610  
(PN: 6008612)  
**PLI PRICE:**  
**\$725.00**

Rugby 620  
(PN: 6008618)  
**PLI PRICE:**  
**\$960.00**



#### LL300N & LL300S

**Key Features:**

- Accuracy of ±3/32in @ 100ft (±2.2m @30m)
- 1,650-2,600ft (500-800m) Diameter range
- Rugged design
- HL450 included

LL300N  
(PN: LL300N)  
**PLI PRICE:**  
**\$745.00**

#### Leveled Price!

**LL300N KIT**  
(PN: LL300N-1 / LL300N-2)  
**PLI SPECIAL:**  
**\$799.00**

LL300S  
(PN: LL300S)  
**PLI PRICE:**  
**\$817.00**



#### LL500

**Key Features:**

- Temperature compensation
- Self-leveling
- Alkaline or rechargeable batteries
- HL700 or CR600 laser receiver
- 1,600ft (500m) Diameter working range
- Perfect for applications including:
  - Checking and adjusting elevations
  - Taking grade shots - Foundation checks
  - Excavations - Footings - Forms
  - Screeding concrete - Slope work and more!

LL500  
(PN: LL500)  
**PLI PRICE:**  
**\$1,100.00**



**Rugby CLA**  
*The Right Choice for Every Application!*  
**Choose Base Unit or FIVE Upgrade Options Based On Your Needs!**

CLA Base Unit  
(PN: 6012279)  
**PLI PRICE:**  
**\$1,850.00**



| CLX 250         | CLX 500         | CLX 600         | CLX 700         | CLX 800           |
|-----------------|-----------------|-----------------|-----------------|-------------------|
| (PN: 6012302)   | (PN: 6012291)   | (PN: 6012292)   | (PN: 6012293)   | (PN: 6012294)     |
| <b>\$140.00</b> | <b>\$150.00</b> | <b>\$590.00</b> | <b>\$880.00</b> | <b>\$3,580.00</b> |

### Grade Lasers

#### Level-Best Laser Grading Box



**Fine Grading Made Easy for Tractors & Skid Steers**

Rugged Casters, Wheel Hub and Tapered Roller Bearing Assemblies:

Composite Bushings: Foam-Filled Tires:

Durable Steel: Durable Cutting Edges:

To Learn More, Call 724.266.1600 or Email PLI @laserinst.com



**Rugby CLH**  
*Simplicity At Its Best!*  
**Choose Base Unit or THREE Upgrade Options Based On Your Needs!**

CLH Base Unit  
(PN: 6012274)  
**PLI PRICE:**  
**\$1,350.00**



| CLX 200         | CLX 300         | CLX 400         |
|-----------------|-----------------|-----------------|
| (PN: 6012288)   | (PN: 6012289)   | (PN: 6012290)   |
| <b>\$150.00</b> | <b>\$380.00</b> | <b>\$660.00</b> |

#### The First Upgradable Lasers

The Leica Rugby CLA and CLH allow you to upgrade your lasers to match your application needs. Pay for the functionality YOU need to do your job without paying for extra features you don't use.



#### GL412N & GL422N

**Key Features:**

- Accuracy of 1.5mm @ 30m (1/16in @ 100ft)
- Working range of up to 800m (2,600ft)
- RC402N Remote allows for up to 100m (330ft) operation
- Auto grade match
- IP66 Rating

#### Leveled Price!

GL412N  
(PN: GL412N)  
**PLI SPECIAL:**  
**\$1,700.00**

GL422N  
(PN: GL422N)  
**PLI PRICE:**  
**\$2,025.00**



#### GL612N & GL622N

**Key Features:**

- Auto self-leveling
- Auto grade-matching
- Grade range of ±25%
- Anti-vibration filter
- Temp. compensation and PlaneLok
- Auto axis alignment
- Mask mode function (turns beam off in up to 3 sides)

GL612N  
(PN: GL612N)  
**PLI PRICE:**  
**\$2,195.00**

GL622N  
(PN: GL622N)  
**PLI PRICE:**  
**\$2,295.00**





# Construction Layout Solutions

## Pipe & Utility Lasers



### DG613, DG613G & DG813

**Key Features:**

- Grades of -12% to +40%
- Operating range of up to 150m (500ft) w/ radio/ IR remote
- IP68 rating
- Flexible power and time-saving functions
- Green-beam (DG613G)

### Leveled Price!

**DG613**  
(PN: DG613)  
**PLI SPECIAL:**  
**\$3,595.00**

**DG613G (GREEN)**  
(PN: DG613G)  
**PLI PRICE:**  
**\$3,850.00**

**DG813**  
(PN: DG813)  
**PLI PRICE:**  
**\$4,100.00**



### DG613/DG613G/DG813 Pipe Laser Parts & Accessories

| Part #   | Description                          | Qty | PLI Price |
|----------|--------------------------------------|-----|-----------|
| P20/P20B | SP Alkaline Bat. Pack - DG511/DG711  | 1   | \$80.75   |
| Q104667  | SP Battery - DG613/DG813             | 1   | \$117.00  |
| P23/P23B | SP NIMH Battery Pack - DG511/DG711   | 1   | \$190.00  |
| Q104781  | SP Charger - DG613/DG813             | 1   | \$75.00   |
| P21      | SP Battery Cable - 12v. DC w/ Clips  | 1   | \$93.50   |
| P25      | SP Car Adapter                       | 1   | \$171.00  |
| RC803    | SP Remote - DG613/DG813              | 1   | \$385.00  |
| RC501    | SP Remote - DG511/DG711 (3-Button)   | 1   | \$290.00  |
| RC502    | SP Remote - DG511/DG711 (7-Button)   | 1   | \$417.00  |
| SF803    | SP Spot Finder - DG613/DG813         | 1   | \$390.00  |
| 956-1    | SP Set of Spare Pipe Laser Elements  | 1   | \$54.50   |
| 956      | SP Pipe Laser Target w/ 2 Elements   | 1   | \$88.00   |
| 1239     | SP Extended Height Vertical Pole Kit | 1   | \$245.00  |
| 1230     | SP Heavy Duty Invert Plate           | 1   | \$255.00  |
| 1244     | SP T-Bar                             | 1   | \$458.00  |
| 929      | SP Manhole Blower                    | 1   | \$467.50  |
| 1017     | SP Manhole Mount                     | 1   | \$554.90  |



### UL633N

**Key Features:**

- Up to ±25% grade on X/Y/Z axes
- Auto axis-alignment
- 800m (2,600ft) Diameter range
- Automatic temp. compensation
- Electronic leveling vibration filter
- Auto self-leveling and grade-matching
- Withstands 1m (3ft) drops onto concrete

**UL633N**  
Universal Laser  
w/ RC603N Remote  
& HL760 Receiver  
(PN: UL633N)  
**PLI PRICE:**  
**\$2,850.00**



### QML800G

**Key Features:**

- Two laser beams mark a visible "X" at desired points
- System controlled by an intuitive tablet app
- Simply tap points on tablet and lasers position "X" at that location on floor and ceiling
- Complicated shapes such as arcs and multilayered serpentine soffits made easy
- Setup accomplished through quick location of 2 known control points

**CALL FOR QUOTES!**  
724.266.1600  
PLI@LASERINST.COM



|                                     |                                   |                                  |
|-------------------------------------|-----------------------------------|----------------------------------|
| <b>56% Reduction in Labor Hours</b> | <b>1 Day Layout Completion</b>    | <b>Less Errors</b>               |
| <b>1/8" Accuracy</b>                | <b>1,200+ Linear Feet Per Day</b> | <b>"In &amp; Out" Efficiency</b> |

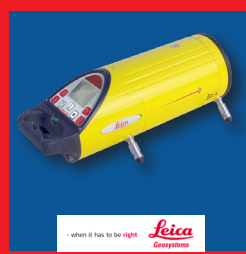

### Piper 200

**Key Features:**

- 10% to +25% Grades
- Operating range of up to 250m (650ft)
- Self-leveling range of -15% to +30%
- Self-centering
- Optional scope and mount kit

**Piper 200**  
(PN: 748710)  
**PLI PRICE:**  
**\$5,005.00**



### Piper Laser Parts & Accessories

| Part #         | Description                           | Qty | PLI Price     |
|----------------|---------------------------------------|-----|---------------|
| 746156         | Piper 200 Carrying Case               | 1   | \$150.00      |
| 746161/746162  | Foot, 6"/8", Piper (4 required)       | 1   | \$7.00/\$8.00 |
| 746163/ 746164 | Foot, 9"/10", Piper (4 required)      | 1   | \$10.00       |
| 746165         | Foot, 12", Piper (4 required)         | 1   | \$10.00       |
| 746157         | IR remote control                     | 1   | \$195.00      |
| 756088/ 757608 | Target insert, 6-12"/15-21"           | 1   | \$30.00/\$40  |
| 725858         | Target Assy w/small insert 300mm, red | 1   | \$115.00      |

### Piper Laser Parts & Accessories (Continued)

| Part #          | Description  | Qty | PLI Price    |
|-----------------|--|-----|--------------|
| 731493          | Blower used for pipelaying applications                                      | 1   | \$550.00     |
| 799185          | GKL311, Li-Ion charg., adapter, car cable                                    | 1   | \$140.00     |
| 734752          | GKL211, Li-Ion bat charger for GEB221/ GEB211, car adapt. cable, net adapter | 1   | \$110.00     |
| 733270          | GEB221, Li-Ion, 7.4V/4.4Ah, chargeable.                                      | 1   | \$190.00     |
| 746159/ 8247505 | Mounting bracket/Steel Knob 5/8 x 11   | 1   | \$45.00/\$50 |
| 745139          | Trivet handle assembly   | 1   | \$55.00      |
| 815613          | PTC100 Target Assembly, 100 mm / 4"  | 1   | \$70.00      |
| 742802          | Battery door assembly  | 1   | \$107.49     |
| 826695          | 7-1/2 Mtg Rod 5/8-11 Assembly  | 1   | \$130.00     |
| 746160          | Scope and mount assembly   | 1   | \$145.00     |
| 8246315         | Handle Rod Mount for use w/ AGL Rods   | 1   | \$320.00     |
| 746158          | Trivet assembly with mounting bracket  | 1   | \$395.00     |
| 8241078         | Manhole Transit Mount w/ 5/8 -11 thread                                      | 1   | \$525.00     |
| 6000000         | Drop manhole assembly for Piper series                                       | 1   | \$895.00     |
| 826728          | Transit (AGL Gradelight)   | 1   | \$1,095.00   |



# Construction Layout Solutions

## Interior Lasers

(Available in Both Red & Green Laser Beams)

**NEW!**



**GREEN BEAM**  
SPECTRA Precision

**Calibrated Before Delivery**

### LT20G & LT52G

#### Key Features:

- High-visibility green laser beams
- Wide fan beam angles for maximum coverage
- Versatile accessory can be used for any application including magnetic mounting, ceilingtrack mounting and tripod mounting
- Rugged, robust design
- Includes a soft pouch w/ belt loop, target, magnetic accessory bracket, ceiling mount, mounting strap, batteries and user guide

LT20G (GREEN)  
(PN: LT20G)  
**PLI PRICE:**  
**\$279.00**

LT52G (GREEN)  
(PN: LT52G)  
**PLI PRICE:**  
**\$499.00**

**NEW!**



**GREEN BEAM**  
SPECTRA Precision

**Calibrated Before Delivery**

### LT56 & LT58G

#### Key Features:

- 360 Degree beams
- Li-Ion batteries for 25+ Hrs of operation
- 360 Degree beams
- Auto self-leveling
- Optimized for ceiling work w/ mounting acc.
- Compensator lock and hard-shell case
- Optional HR220 for exterior applications
- Survives 3ft (1m) drops onto concrete

**Leveled Price!**

LT56 (RED)  
(PN: LT56)  
**PLI SPECIAL:**  
**\$450.00**  
(w/ HR220 Remote)  
(PN: LT56-2)  
**PLI PRICE: \$570.00**

LT58G (GREEN)  
(PN: LT58G)  
**PLI PRICE:**  
**\$595.00**

**NEW!**



**GREEN BEAM**  
SPECTRA Precision

**Calibrated Before Delivery**

### LP51G

#### Key Features:

- High visibility beam
- Automatic self-leveling and plumb
- Fast, one-person 90 degree layout
- Accuracy of 3/16 inch @ 50ft (3mm @ 10m)
- Working range up to 100ft (30m)
- Dust, water and shock-resistant
- Protective rubber over-molding withstands a drop of up to 3ft (1m) onto concrete
- Compensator lock for non-level applications
- Ships complete in soft pouch w/ mag. mounting accessory, target and x2 AA batteries

LP51G (GREEN)  
(PN: LP51G)  
**PLI PRICE:**  
**\$238.50**



**GREEN BEAM**  
SPECTRA Precision

**Calibrated Before Delivery**

### HV302 & HV302G

#### Key Features:

- High-visibility beam
- Line scan and beam plunge feature for easy drywall work
- Rotor vial for easy and accurate vertical plumb
- Preset adjustable rotation speed and scan line sizes to fulfill all interior application needs
- Increases flexibility w/ long range radio remote
- Fast setup, fewer parts and auto self-leveling

HV302 (RED)  
(PN: HV302-1)  
**PLI PRICE:**  
**\$1,030.00**

HV302G (GREEN)  
(PN: HV302G-1)  
**PLI PRICE:**  
**\$1,195.00**



**GREEN BEAM**  
Leica Geosystems

**Calibrated Before Delivery**

### Rugby 640G

#### Key Features:

- Self-leveling, horizontal, vertical, 90 degree and manual slope in dual axis
- Accuracy of ±2.2mm @ 30m (±3/32in @ 100ft)
- Range of 400m (1,300ft)
- Scan 90 – make layout easier by quickly moving the beam 90 degrees to the left or right side
- Plumb Down – auto and accurate plumb down direction for alignment over a reference point
- Work conveniently with offsets thanks to the Rod Eye receivers digital read-out

Rugby 640G (GREEN)  
(PN: 6011836)  
**PLI PRICE:**  
**\$1,595.00**



## FREE CALIBRATION CHECK!

Auto-Levels, Slope Lasers, Rotating Lasers, Line & Point Lasers  
Visit Any of Our 4 Service Centers!

Pittsburgh, PA: 724.266.1600

Columbus, OH: 614.759.1000

Cincinnati/Dayton, OH: 513.539.0022

Cleveland/Akron, OH: 330.633.4900

## NO APPOINTMENT REQUIRED!

\*One Free Calibration Check Per Location Per Day\*

## Hand Receivers



**Leica Geosystems**

**Calibrated Before Delivery**

### Rod Eye Basic & Rod Eye 120

#### Key Features:

- LCD indication
- Audio indication
- Automatic shut-off
- Working range of 600m (Basic) to 900m (120 Basic)
- Level vial alignment
- Versatile grade rod bracket

Rod Eye Basic  
(PN: 769811)  
**PLI PRICE:**  
**\$175.00**

Rod Eye 120  
(PN: 789922)  
**PLI PRICE:**  
**\$225.00**



**Leica Geosystems**

**Calibrated Before Delivery**

### Rod Eye 140, 160 & 180

#### Key Features:

- LCD indication
- Level vial alignment
- Anti-strobe protection
- 12cm detection window of beam over entire distance
- Auto slope catching and monitoring (180)

Rod Eye 140  
(PN: 789923)  
**PLI PRICE:**  
**\$295.00**

Rod Eye 160  
(PN: 789924)  
**PLI PRICE:**  
**\$350.00**

Rod Eye 180  
(PN: 828456)  
**PLI PRICE:**  
**\$425.00**



# Construction Layout Solutions

## Hand Receivers (Continued)



### HL450, HL700, HL750 & HL760

**Key Features:**

- Digital readout of elevation
- Anti-strobe sensor
- Large reception height
- New capture function remotely retains measurement (HL700)
- Magnetic or bracket mounts



**HL450**  
(PN: HL450)  
**PLI PRICE:**  
**\$260.00**

---

**HL700**  
(PN: HL700)  
**PLI PRICE:**  
**\$335.00**

---

**HL750**  
(PN: HL750)  
**PLI PRICE:**  
**\$345.00**

---

**HL760**  
(PN: HL760)  
**PLI PRICE:**  
**\$345.00**



### HR150, HR220 & HR320

**Key Features:**

- 3-Channel, dual-side LED display
- Built-in magnet for ceiling grid or drywall
- Work indoors or out up to 75m (250ft) (HR220)
- 100db Loud speaker indication (HR320)



**HR150**  
(PN: HR150)  
**PLI PRICE:**  
**\$130.00**

---

**HR220**  
(PN: HR220)  
**PLI PRICE:**  
**\$144.00**

---

**HR320**  
(PN: HR320)  
**PLI PRICE:**  
**\$165.00**

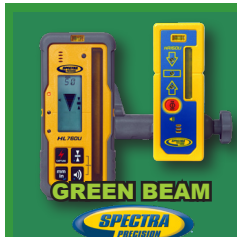

### HR150U & HL760U

**Key Features:**

- 3-Channel, dual-side LED display
- Built-in magnet for ceiling grid or drywall
- Work with red and high-visibility green beam lasers
- "Fingerprint" function filters other lasers



**HR150U**  
(PN: HR150U)  
**PLI PRICE:**  
**\$148.00**

---

**HL760U**  
(PN: HL760U)  
**PLI PRICE:**  
**\$365.00**

## Machine Receivers



### LMR240

**Key Features:**

- 250m Radius range
- 240 Degree reception
- 15cm Capture window
- 1.5-6mm Fine accuracy
- IP67 Rating
- 120-160Hr Battery life
- Ideal for use with backhoes and mini-excavators
- Extra-strong magnetic mount
- IP67 Rugged and waterproof



**LMR240**  
(PN: 773569)  
**PLI PRICE:**  
**\$595.00**



### LR30, LR50 & LR60

**Key Features:**

- Multiple channels of grade info
- Center & offset on-grade display
- Built-in plumb indicator



**LR30**  
(PN: LR30)  
**PLI PRICE:**  
**\$1,189.00**

---

**LR50**  
(PN: LR50)  
**PLI PRICE:**  
**\$1,590.00**

---

**LR60**  
(PN: LR60)  
**PLI PRICE:**  
**\$2,190.00**



### LR50W/LR60W - Wireless

**RD20 Wireless Remote Display Capable:**  
**Mounts in cab & displays grade to operator!**



| Part #   | Description   | QTY | PLI Price  |
|----------|---|-----|------------|
| MM-1     | Magnetic Mount - Excavator                              | 1   | \$280.00   |
| DM-20    | Magnetic Mount - Dozer                                  | 1   | \$280.00   |
| LR50W    | Receiver-Radio; Remote Display                          | 1   | \$1,860.00 |
| LR60W    | Receiver-Radio; Remote Display                          | 1   | \$2,450.00 |
| LR50W-MM | <b>Kit</b> - Receiver, RD20 Remote & Mag or Dozer Mount | 1   | \$2,195.00 |
| LR50W-DM | <b>Kit</b> - Receiver, RD20 Remote & Mag or Dozer Mount | 1   | \$2,195.00 |

### Choose the Right Receiver for the Right Job

| Machine Type        | Recommended Receiver(s)                            | Application(s)                     |
|---------------------|--|------------------------------------|
| Backhoes            | Use CR600, LR20 or LR50                            | Grading                            |
| Skid-Steer Loader   | Use CR600, LR20, LR30 or LR30W (w/ remote display) | Elevation Display                  |
| Mini Excavator      | Use CR600, LR20, LR50 or LR50W (w/ remote display) | Elevation Display                  |
| Skid-Steer w/ Blade | Use LR30, LR50, or LR30W/LR50W (w/ remote display) | Elevation Display/<br>Lift Control |
| Smaller Dozer       | Use LR30 or LR30W (w/ remote display)              | Elevation Display/<br>Lift Control |
| Larger Excavator    | Use LR50/LR60 or LR50W/LR60W (w/ remote display)   | Elevation Display/<br>Lift Control |
| Larger Dozer        | Use LR50 or LR50W (w/ remote display)              | Elevation Display/<br>Lift Control |



# Construction Layout Solutions

## One-Person Construction Positioning Package



### FOCUS 35 Robotic Total Station

- ▶ StepDrive motion technology
- ▶ Layout Pro software onboard
- ▶ Optional in 1", 2", 3", & 5" accuracies
- ▶ Motorized drive system at the instrument
- ▶ Gun-to-prism communication
- ▶ LockNGo tracking technology
- ▶ Dual-battery system (RX models)
- ▶ 2.4GHz Radio (Robotic/RX models)

## One-Person Construction Layout Package

### Option A: SP FOCUS 35 RX w/ Layout Pro Robotics Package



| Part #       | Description  |
|--------------|--|
| SUMF-35005   | Spectra Precision Focus 35 RX 5" Robot w/ 2x Li-Ion Batteries, Charger, Case & 360° Prism              |
| RG3-C41-002  | Spectra Precision Ranger 3RC w/ ABC, Cam., 2.4GHz Radio & Layout Pro ROB                               |
| 67501-08     | Spectra Precision Ranger 3 Range Pole Bracket  |
| 88400-03-SPN | Spectra Precision 2.6m Telescopic, Carbon Fiber Pole w/ Snap Lock; Calibrated for 360° Prism & Adapter |
| 90553-PL     | Seco/Crain Tri-Max Standard, Dual-Clamp, Heavy Duty Fiberglass Tripod                                  |

**Complete Package: \$23,813.45 <sup>\*tax</sup> (\$1,011.98 per month\*)**

**1.9% Financing for 24 Months\*!**

### Additional Options:

**Training (On-Site or Office): \$1,200.00 Per Day\*\***  
**Layout Pro Office Software (PN: 63820-10): \$795.00**  
**Warranty - FOCUS Robotic & Data Collector, Plus Software System (Call 724.266.1600 for Details)**

\*\*Within 30-mile radius of PLI locations.

### Terms & Conditions

Through Trimble Financial Services, we offer competitive rates, flexible terms, fast response, as well as great service! There are several advantages to our finance programs: We can help you improve cash flow, it's very flexible and you can get 100% financing. In addition, our leasing and finance are easier and faster than bank financing, and may provide you with tax benefits.\*\*\* Ask your sales rep. for more info on the tax benefits of financing or leasing.  
 \*Trade-in and rent-to purchase option not available with this offer  
 \*Payment listed is before applicable taxes and is subject to credit approval.  
 \*\*10% Down payment is required at listed price.  
 \*\$100.00 Doc Fee due with advance payment  
 \*\*Offers valid through 12/31/18.  
 \*\*\*We recommend that you consult your tax advisor to find out the tax benefits specific to your business.



## Construction Layout Solutions

### Two-Person Construction Positioning Package



## Two-Person Construction Layout Package

### Option B: NPL-322+ w/ Layout Pro Construction Layout Package



| Part #           | Description  |
|------------------|--|
| HQA46580         | Nikon NPL-322+ 5" Single-Face Total Station (Includes: 2x Li-Ion Batteries, 1x Clip-On Bat. Holder, 1x Tribrach, 1x Plastic Carrying Case, 1x Universal Charger/Power Cord/Adapters) |
| EG3-STN LDDF2-LP | Spectra Precision Nomad 1050L w/ Layout Pro Software (Includes: Charger, Data Cable, Hand Strap, 2x Screen Protectors, Stylus, Rechargeable Li-Ion Bat. Module, Case & Lanyard)      |
| 67901-06         | Spectra Precision Nomad/Recon Tripod Mount   |
| N/A              | Training, 1/2 Day On-Site or Office (within 30-Mile Radius of PLI Locations)   |

**Complete Package: \$7,040.00 <sup>+tax</sup> (\$586.67 per month\*)**

**0% Financing for 12 Months\*!**

## Two-Person Construction Layout Package

### Option C: NPL-322+ P w/ Layout Pro Construction Layout Package



| Part #           | Description   |
|------------------|---|
| HQA46610         | Nikon NPL-322+ 5" P Single-Face Total Station (Includes: 2x Li-Ion Batteries, Clip-on Battery Holder, Tribrach, Universal Charger, Power Cord, Adapters and Carrying Case)      |
| EG3-STN LDDF2-LP | Spectra Precision Nomad 1050L w/ Layout Pro Software (Includes: Charger, Data Cable, Hand Strap, 2x Screen Protectors, Stylus, Rechargeable Li-Ion Bat. Module, Case & Lanyard) |
| 67901-06         | Spectra Precision Nomad/Recon Tripod Mount  |
| N/A              | Training, 1/2 Day On-Site or Office (within 30-Mile Radius of PLI Locations)  |

**Complete Package: \$6,040.00 <sup>+tax</sup> (\$503.33 per month\*)**

**0% Financing for 12 Months\*!**

**Included w/ Two-Person Packages at NO CHARGE!**

**\$500.00+ Value, INCLUDED!**

| Part #      | Description                                    |
|-------------|--|
| 6405-01-FOR | Seco 25mm Stake Out Prism - Flo. Orange        |
| 5540-10     | Seco 8.5ft Ultralite Prism Pole                |
| 60-WDF20    | CST/Berger Heavy Duty Wooden/Fiberglass Tripod |

\*See Page 22 for full Terms & Conditions. Credit Application on Page 29.





## Build Construction Solutions



### Take Control of the Jobsite

Our Build Construction Positioning Solutions, utilizing the latest technology from Trimble, give contractors more control of their jobsites. By connecting your office and field crews through wireless data transfer, design updates can flow between both teams in real-time. Jobs can be created, updated, monitored and maintained without missing a beat.

#### RTS Series Robotic Total Stations

The Trimble RTS Series Robotic Total Stations help contractors perform layout tasks significantly more efficiently than conventional mechanical systems.

They offer construction-specific functionality and one-person operation for all jobsite layout and measurement, allowing for max flexibility and savings.



#### Training & Support

Our expert training and support team is composed of industry veterans with years of experience. We'll keep you up to speed on the latest and greatest hardware, software and practices, and are available by phone, email or on-site to help keep your projects moving.

**Call Your Local PLI Build Construction Solutions Rep. or 724.266.1600 To Learn More!**

### Trimble Field Link Taking the Connected Construction Site to the Next Level!



#### Kenai Rugged Tablet Computer

The new Trimble Kenai is a fully rugged tablet featuring Windows® 10 Pro and a large 10.1" screen capable of full-color images even in the brightest sunlight. Kenai connectivity includes Bluetooth®, Wi-Fi and optional 4G LTE dual-mode data cloud-capability, and utilizes hot-swappable batteries.



#### Trimble Field Link Software

Featuring task-based workflows, customizable views and a touch screen user interface designed to optimize the information presented, Trimble Field Link extends field layout capabilities. In addition to the advancements made in performing layout tasks, Trimble Field Link adds reporting routines to record and track layout productivity and to document existing site conditions.

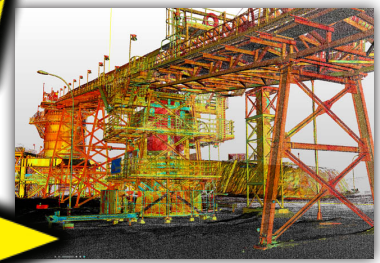

#### RealWorks & EdgeWise

RealWorks 3D scanning software allows you to integrate 3D point data to extract measurements, generate deliverables and utilize inside 3D CAD software. EdgeWise software complements 3D scanners and RealWorks to provide efficient end-to-end workflows and accurate BIM-ready models.



#### R8s GNSS Receiver

The concept is simple: Take the field-proven Trimble R8s Receiver, pair it with Trimble Field Link Controller Software and watch productivity soar on the jobsite! Designed specifically to meet the needs of building construction, the Trimble R8s system for general contractors streamlines workflows to help perform common field positioning tasks fast.

#### Build Construction Equipment Essential Parts & Accessories

| Part #     | Description                          | QTY | Price    |
|------------|--------------------------------------|-----|----------|
| 925-1004   | Hardcase 17"L x 11.8"W x 6.4"H       | 1   | \$132.50 |
| 90553-PL   | Tri-Max Dual Clamp Instrument Tripod | 1   | \$369.50 |
| 4852-16    | HD Column Clamp                      | 1   | \$365.00 |
| 61586-80   | HD Column Clamp                      | 1   | \$400.00 |
| 4852-18    | HD Column Clamp                      | 1   | \$461.00 |
| 6704-10    | Spheres (x3) Case                    | 1   | \$785.00 |
| 6704-10-TR | Scanning Spheres                     | 3   | \$999.95 |



#### TX6/TX8 3D Laser Scanner

The Trimble TX6 and TX8 laser scanners set new standards for performance and ease of use in high-speed collection of 3D data. Using a state-of-the-art blend of speed, long range and precision, the Trimble TX6/TX8 delivers high quality results in civil survey, industrial measurement, engineering and construction.





**Precision Laser  
& Instrument, Inc.**  
www.laserinst.com

Construction • Survey • GIS

Sales • Service • Rentals • Training • Support

Monday-Friday, 7:30am-4:30pm | Saturday, 8:00am-12:00pm (Pittsburgh Only)



**Locations:**  
(Full Addresses On Back Cover)

Pittsburgh, PA (HQ): 724.266.1600  
Columbus, OH: 614.759.1000  
Cincinnati, OH: 513.539.0022  
Akron, OH: 330.633.4900  
Charleston, WV: 304.776.1831  
Bridgeport, WV: 304.933.3036

## Build Construction Solutions

**All Equipment Available for Daily/Weekly/Monthly Rental!**



**The Right Tool for the Job**

**The Right Team for Your Jobsite**



**RTS**



**R8s**



**TX6/TX8**

**Application**

**New Construction**

**Renovation Project**



**Site Work**  
(Underground Utilities)

**RTS  
R8s**  
(Based on Line of Sight)

**RTS  
R8s**  
(Based on Line of Sight)



**Ondeck Layout**  
(Metal Deck & Concrete Slabs)

**RTS**  
(Long Range)

**RTS**  
(Long Range)



**Interior Layout**  
(Overhead Existing)

**RTS**

**RTS  
TX6/TX8**  
(Capture of Existing Site Conditions)



**Robert Fancher**

Field Technology Group: Sales

513.265.8228

RJF@laserinst.com

**Ohio**



**Sean Geis**

Field Technology Group: Sales

412.439.2743

SPG@laserinst.com

**Western PA & WV**

**Shop Online! E-Commerce Store: www.laserinst.com**

PLI Fall 2018 Supplies & Accessories Catalog (Ver. 8.0)



## Geospatial Positioning Equipment & Accessories

### Trimble SX10 Scanning Total Station Superior Surveying & Scanning in One

#### Surveys, Scans and Imagery with Supreme Precision

Achieve the highest in modern surveying precision and efficiency, automatically register dense 3D scan data, and add in live video and rich imagery, all in one total station! That's the power of the Trimble SX10, and paired with the familiar workflows of Access and Trimble Business Center Software, it enables you to create a range of deliverables like never before.

#### Key Features

- ▶ Combines surveying, imaging and high-speed 3D scanning in one revolutionary solution
- ▶ Trimble Lightning 3DM enables both high-accuracy measurements and high-speed scanning
- ▶ Scanning speeds of up to 26,600 pps at ranges up to 600m and a mere 14mm at 100m
- ▶ Improved Trimble VISION technology for fast, easy capture of high resolution site imagery
- ▶ Complete integration with workflows of Trimble Access and Trimble Business Center Software



**NEW!**

**7-INCH TOUCHSCREEN!**



#### Trimble S5 Trusted Performance

- Measure further and faster with Trimble DR Plus EDM
- Locate2Protect real-time equipment monitoring and InSphere equipment management
- Complete field-to-office solution for quick data capture and processing



#### Trimble S7 Fully-Loaded for Max Results

- Surveying, imaging, and 3D-scanning in one
- Improved robotic control, scene documenting, and photogrammetric measurements
- Complete field-to-office solution for quick data capture and processing



#### Trimble S9 & S9HP Advanced to Tackle Tough Jobs

- Available in 0.5" or 1" angle accuracy
- Optional Trimble VISION and SureScan Trimble 4D Control software for monitoring management



**TSC3**



**TSC7**

**NEW!**



**T10**

**CALL 724.266.1600 FOR QUOTES!**



# Geospatial Positioning Equipment & Accessories

## R10 GNSS Receiver

### A New Level of Productivity

Collect more accurate data faster and easier - no matter what the job or the environment, with the Trimble R10 GNSS System.



#### Key Features

- ▶ Cutting-edge Trimble HD-GNSS processing engine
- ▶ Precise position capture and full tilt compensation with Trimble SurePoint technology
- ▶ Trimble CenterPoint RTX provides RTK precision anywhere without a base station or VRS
- ▶ Trimble xFill technology for centimeter-level positioning during connection outages
- ▶ Advanced satellite tracking with Trimble 360 receiver technology
- ▶ Sleek, ergonomic design for easier handling



## R8s GNSS Receiver

Configured Today, Scalable Tomorrow

#### Key Features

- ▶ One configurable receiver that is scalable for future needs
- ▶ Available in post-processing, base only, rover only or base and rover configurations
- ▶ Advanced satellite tracking with Trimble 360 receiver technology
- ▶ Includes Trimble Maxwell 6 chips with 440 channels
- ▶ Simple integration with Trimble S-Series Total Stations
- ▶ Intuitive Trimble Access Field Software and Trimble Business Center Office Software





# Geospatial Positioning Equipment & Accessories

## Hydrographic Surveying Solutions



### HydroLite-TM Echosounder Kit - Call 724.266.1600 To Learn More!

The HydroLite-TM should be included in every Survey and Engineering company's standard equipment kit for hydrographic surveying. Developed to meet the requirements of the U.S. Army Tactical Dive Teams, the rugged, wireless HydroLite-TM looks and feels like your traditional survey instrument. It quickly measures and logs depths more accurately than standard systems, making fast work of ponds, rivers, lakes and more!

**Key Features:**

- Portable, integrated hydrographic survey solution
- Adaptable to any vessel
- Wireless data transfer
- Meets IP65 standards
- Quickly export xyz data

**Specifications:**

- Frequency 200-KHz
- Beam width: 4°
- Ping rate: 6-Hz
- Depth accuracy: 1cm / 0.1% of depth
- Output formats: NMEA, ASCII, Quality
- Range: 0.3m-75m

GPS & Data Collector Sold Separately

**Scope of Supply:**

- Sonarmite echosounder kit
- Hydrolite boat mount/pole kit
- Rugged shipping case
- User/training manual
- 1-Year support and warranty

**Optional:**

- Coast Guard beacon receiver
- PC data acquisition
- Digital bar check
- Tide gauge



### HyDrone-RCV - Call 724.266.1600 To Learn More!

The HyDrone-RCV is a hand-portable, remotely controlled catamaran platform developed for bathymetric survey applications. Working in conjunction with the HydroLite-TM portable echosounder kit, the HyDrone-RCV accomplishes the same results as more expensive RC survey systems. The lightweight, wide profile and watertight construction provide stability, ruggedness and portability. It is manufactured from high quality marine materials and components, and easily disassembles for transport and shipping. Work environments include mines, sewage treatment plants, contaminated lakes, harbors and rivers. Remote control access of the survey boat is easy using a high-power remote control system that offers up to 2km range with a survey endurance of over four miles on a single battery pack.

**Scope of Supply:**

- 2x12m catamaran pontoon hulls
- Two 12V DC shrouded thrusters
- 12V battery bank and charger
- 1 Year standard warranty
- Cross frame
- Handheld remote control unit
- Custom-fit portable shipping case
- Lifetime support

**Optional:**

- Sound velocity profiler (SVP)
- Radio telemetry
- HYPACK software
- RTK GPS
- Side scan sonar module
- HydroLite-TM
- AutoNAV AutoPilot Module with Mission Planner App on PC Laptop





**Katie.B.Shannon@wellsfargo.com**  
**Trimbleapps@wellsfargo.com**  
**Credit Fax 888-375-3288**

**Company Name** \_\_\_\_\_

Address \_\_\_\_\_ Email \_\_\_\_\_ Phone \_\_\_\_\_

City \_\_\_\_\_ County \_\_\_\_\_ State \_\_\_\_\_ Zip \_\_\_\_\_ Fax \_\_\_\_\_

Attention \_\_\_\_\_ Title \_\_\_\_\_ Years in Business \_\_\_\_\_

Description of Business \_\_\_\_\_ Fed ID # \_\_\_\_\_  Corporation  Partnership  Proprietorship

**(Required Information)**

**BANKS** Name Telephone Account Number Account Officer

1. \_\_\_\_\_

2. \_\_\_\_\_

**CREDIT & TRADE REFERENCE** Name Contact Telephone

1. \_\_\_\_\_

2. \_\_\_\_\_

**If individually owned, a partnership or a closely held corporation, please include and complete the following:**

Name \_\_\_\_\_ S.S.# \_\_\_\_\_ Date of Birth \_\_\_\_\_ Telephone \_\_\_\_\_

Address \_\_\_\_\_ City \_\_\_\_\_ State \_\_\_\_\_ Zip \_\_\_\_\_  Rent  Own

Name \_\_\_\_\_ S.S.# \_\_\_\_\_ Date of Birth \_\_\_\_\_ Telephone \_\_\_\_\_

Address \_\_\_\_\_ City \_\_\_\_\_ State \_\_\_\_\_ Zip \_\_\_\_\_  Rent  Own

I/We have applied to finance equipment. I authorize Wells Fargo Equipment Finance, a division of Wells Fargo Bank, N.A. to investigate the references listed above or other credit data including reports from credit reporting agencies which may be required as part of its normal credit approval procedures and authorize that any such information requested may be released by telephone. **NOTICE: Wells Fargo Equipment Finance complies with Section 326 of the USA PATRIOT Act. This law mandates that we verify certain information about you while processing your lease application.**

Authorized this \_\_\_\_\_ Day of \_\_\_\_\_ 20\_\_\_\_\_

Signature \_\_\_\_\_ Title \_\_\_\_\_

**DESCRIPTION OF EQUIPMENT TO BE LEASED**

| Quantity | New/Used | Model - Description | Unit Cost | Total Cost |
|----------|----------|---------------------|-----------|------------|
|          |          |                     |           |            |
|          |          |                     |           |            |
|          |          |                     |           |            |

**TOTAL COST**

Lease Term \_\_\_\_\_ Lease Rate Factor \_\_\_\_\_

**Less Trade In Allowance**

Purchase Option \_\_\_\_\_ Number of Advance Payments \_\_\_\_\_

**Net to Finance**

Lease Payment \$ \_\_\_\_\_  
 + Maintenance Payment \$ \_\_\_\_\_  
 = TOTAL Payment \$ \_\_\_\_\_

**Tax Rate** \_\_\_\_\_

**Dealer** Precision Laser & Instrument, Inc. **Salesperson** \_\_\_\_\_ **Phone** 724.266.1600

85 11th Street Ambridge PA 15003 724.266.8161

Street City State Zip Fax

**APPLICANT - DETACH AND RETAIN**

*Creditor's Name: Wells Fargo Bank, N.A.*

*Creditor's Address: 300 Tri-State International, Lincolnshire, IL 60069*

If your application for business credit is denied, you have the right to a written statement of the specific reasons for the denial. To obtain the statement, please contact Wells Fargo Bank, N.A. Attn: Credit Manager, 300 Tri-State International, Suite 400, Lincolnshire, IL 60069 or (800) 570-3607 within 60 days from the date you are notified of our decision. We will send you a written statement of reasons for the denial within 30 days of receiving your request.

**NOTICE:** The Federal Equal Credit Opportunity Act prohibits creditors from discrimination against credit applicants on the basis of race, color, religion, national origin, sex, marital status, age (provided the applicant has the capacity to enter into a binding contract), because all or part of the applicant's income derives from any public assistance program, or because the applicant has in good faith exercised any right under the Credit Protection Act (15 U.S.C. 1601 et seq.). The Federal agency that administers compliance with this law concerning this creditor is the Comptroller of the Currency, Customer Assistance Group, 1301 McKinney Street, Suite 3450, Houston, TX 77010-9050. Wells Fargo Equipment Finance is a division of Wells Fargo Bank, N.A.



# Geospatial Positioning Equipment & Accessories

## GNSS Receivers



### SP60 GNSS Receiver

**Key Features:**

- 240-Channel 6G ASIC
- Z-Blade GNSS-centric technology
- Both RTK and Trimble RTX capable
- Anti-theft technology
- Optional Long-range Bluetooth or UHF radio
- Extended survey scalability

**Simply Versatile**

The SP60 is a new generation GNSS receiver offering a high level of flexibility to cover any demand, from GIS to more sophisticated RTK and Trimble RTX capable solutions.

(PN: 104234-03)

**PLI PRICE: \$9,895.00**

**0%** for **12**  
Financing Months\*



### SP80 GNSS Receiver

**Key Features:**

- Z-Blade GNSS-centric technology
- Backup RTK and RTK bridge
- Trimble RTX corrections
- Anti-theft technology
- Wifi, SMS and email
- 3.5G Cellular modem
- Hot-swappable batteries
- eLevel technology

**The Most Connected GNSS Receiver**

The SP80 has the ability to track and process all available GNSS signals to provide the highest in precision measurement, even in challenging environments, and has the best communication and connectivity available.

(PN: 94334-50)

**PLI PRICE: \$12,495.00**

**0%** for **12**  
Financing Months\*



# Ask About On-Site Equipment Demos!

# Call 724.266.1600

## Mechanical Total Stations



### NPL-322+

**Key Features:**

- Optional in 2" and 5"
- Both prism and reflectorless
- Fast, accurate EDM
- Li-Ion batteries
- Bluetooth enabled
- Rugged and lightweight design
- Legendary optics

**5" Single-Face Model**  
(PN: HQA46580)

**PLI SPECIAL:**  
**\$4,395.00**

**2" Dual-Face Model**  
(PN: HQA46570)

**PLI PRICE:**  
**\$6,150.00**

**0%** for **12**  
Financing Months\*



### NPL-322 P+

**Key Features:**

- Optional in 2" and 5"
- Prism-only
- Fast, accurate EDM
- Li-Ion batteries
- Bluetooth enabled
- Rugged and lightweight design
- Legendary optics

**5" Single-Face Model**  
(PN: HQA46610)

**PLI PRICE:**  
**\$3,395.00**

**2" Dual-Face Model**  
(PN: HQA46600)

**PLI PRICE:**  
**\$5,150.00**

**0%** for **12**  
Financing Months\*



### Nikon XF

**Key Features:**

- Autofocus
- Fast, powerful EDM
- Dual color touchscreen displays
- Trimble Locate2Protect ready
- PIN Security
- 1", 2", 3" and 5" accuracies
- Hot-swap. batteries

**Nikon XF 5"**  
(PN: HNA40500)

**PLI PRICE:**  
**\$10,350.00**

**Nikon XF 3"**  
(PN: HNA40300)

**PLI PRICE:**  
**\$11,250.00**

**0%** for **12**  
Financing Months\*



### Nikon XS

**Key Features:**

- Autofocus
- Dual-face displays
- Fast, powerful EDM
- PIN security
- 1", 2", 3" and 5" accuracies
- Nikon onboard software
- Hot-swappable batteries

**Nikon XS 3"**  
(PN: HNA20300)

**PLI PRICE:**  
**\$9,500.00**

**Nikon XS 2"**  
(PN: HNA20200)

**PLI PRICE:**  
**\$10,350.00**

**0%** for **12**  
Financing Months\*



# Geospatial Positioning Equipment & Accessories

## Robotic Total Stations



### FOCUS 35 Robotic Total Station

#### Key Features:

- StepDrive™ motion technology
- SurveyPro™ software onboard
- Optional in 1", 2", 3" and 5" accuracies
- Motorized drive system at the instrument
- Gun-to-prism communication
- LockNGo™ tracking technology
- GeoLock GPS-assist technology
- Dual-battery system (RX models)
- Tracking sensor for prisms
- 2.4GHz Radio (Robotic/RX models)
- PIN code security locking system
- High speed, accuracy and precision

| Part #     | Description    | Qty | PLI Price   |
|------------|----------------|-----|-------------|
| SUMR-35005 | 5" Robot Model | 1   | \$16,195.00 |
| SUMR-35003 | 3" Robot Model | 1   | \$14,524.00 |
| SUMR-35002 | 2" Robot Model | 1   | \$17,995.00 |
| SUMR-35001 | 1" Robot Model | 1   | \$19,795.00 |
| SUMF-35005 | 5" RX Model    | 1   | \$16,995.00 |

Please Call 724.266.1600 for Additional Options.



#### All Robotic Instruments Include:

- A motorized drive system
- A tracking sensor to range pole and prism
- Instrument, range pole and prism communication

**Calibrated Before Delivery** | **0% Financing** for **12 Months\***

## 0% Financing for 12 Months!

### Put Your Equipment Investment to Work Before You Pay Out!

Many Spectra Precision and Nikon surveying instruments are available for immediate purchase at 0% financing for 12 months\*! See Page 29 for a Credit Application to take advantage of this great offer while it lasts.

#### Contact Your Local PLI Sales Rep. for Details.

\*Applies only to Spectra Precision and/or Nikon equipment with an MSRP of \$5,000.00 or greater

\*10% Down payment required

\*Trade-in and rent-to-purchase options not available with this offer

\*\$100 Doc Fee due with advance payment

\*We recommend that you consult your tax advisor to learn about the tax benefits specific to your business

## Data Collectors & Software

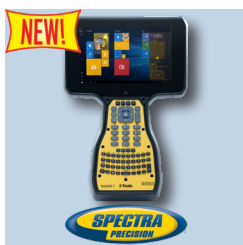

### Ranger 7

#### Key Features:

- 7-Inch touchscreen
- 68-Button keyboard
- Barcode, RFID and GNSS optional
- 4G LTE, 802.11 a/b/g/n and Bluetooth
- Windows 10 Pro OS

Survey Pro Model (PN: RG7-S02-001)  
**PLI PRICE: \$5,100.00**

Layout Pro Model (PN: RG7-C22-001)  
**PLI PRICE: \$5,700.00**



### SP20

#### Key Features:

- GNSS
- Android OS
- 4G LTE
- 5.3-Inch touchscreen
- Optional monopole survey-grade

|           |                 |            |
|-----------|-----------------|------------|
| 114819-00 | SP20 meter      | \$3,495.00 |
| 114819-01 | SP20 sub-mtr.   | \$4,995.00 |
| 114819-02 | SP20 dm         | \$6,595.00 |
| 114819-03 | SP20 cm         | \$8,595.00 |
| 115874-01 | sub-mtr. option | \$1,500.00 |
| 115875-01 | dm option       | \$3,100.00 |
| 115876-01 | cm option       | \$5,100.00 |

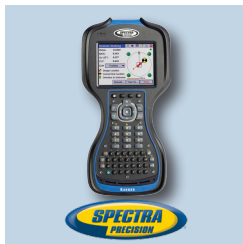

### Ranger 3

#### Key Features:

- Sunlight-readable VGA screen
- IP67 Rating
- SDHC & USB
- 30Hr+ Rechargeable
- Windows Mobile
- WiFi, GPS, Compass

Survey Pro Model (PN: RG3-P31-002)  
**PLI PRICE: \$3,395.00**

Layout Pro Model (PN: RG3-C41-002)  
**PLI PRICE: \$5,850.00**

### Choose the Right Software for Your Needs Call Us at 724.266.1600 To Learn More!



### FAST Survey

#### Key Features:

- Easy data collection
- Colorful graphics
- Main handheld devices supported
- Compatible w/ a wide range of measurement tools (GNSS Receivers, Total Stations, etc.)

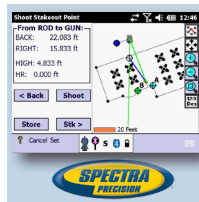

### Layout Pro

#### Key Features:

- CAD design data solutions
- Complex concrete form and anchor bolt layout through referencing any two known points
- Quick, easy layout of control points and offset hubs
- Layout of all lines from one reference location
- Checking of work, data collection and reporting



### Survey Pro/Survey Office

#### Key Features:

- Advanced COGO, Curve and stakeout Solutions
- Complete road layout and staking tool set
- Complete mechanical instrument support
- All data collection features and basic survey features
- Compelling survey deliverables, communication between field and office, and optional roads module

Please Call 724.266.1600 for Additional Options.



# Geospatial Positioning Equipment & Accessories

## Warranty Plans for Geospatial Equipment

### Control Units

| Part #          | Description   | Qty | PLI Price       |
|-----------------|---|-----|-----------------|
| EWLS-CU-HW      | <b>Warranty:</b> Survey TSC3/TSC7 <u>Hardware Only</u> Extended                             | 1   | <b>\$275.00</b> |
| EWLS-CU-HW-RNST | <b>Warranty Reinstatement:</b> Survey TSC3/TSC7 <u>Hardware Only</u> Extended               | 1   | <b>\$413.00</b> |
| EWLS-CU-HW      | <b>Warranty:</b> Trimble Recon, CU, Slate <u>Hardware Only</u> Extended                     | 1   | <b>\$275.00</b> |
| EWLS-CU-HW-RNST | <b>Warranty Reinstatement:</b> Trimble Recon, CU, Slate Controller, <u>HW Only</u> Extended | 1   | <b>\$413.00</b> |



### GNSS/GPS Receivers

| Part #           | Description   | Qty | PLI Price         |
|------------------|---|-----|-------------------|
| EWLS-ANT         | <b>Warranty:</b> Survey External Antenna Hardware Extended                          | 1   | <b>\$125.00</b>   |
| EWLS-ANT-RNST    | <b>Warranty Reinstatement:</b> Survey External Antenna Hardware Extended            | 1   | <b>\$188.00</b>   |
| EWLS-GPS         | <b>Warranty:</b> Survey GPS Receiver Hardware and Firmware Maintenance              | 1   | <b>\$845.00</b>   |
| EWLS-GPS-RNST    | <b>Warranty Reinstatement:</b> Survey GPS Receiver HW and Firmware Maintenance      | 1   | <b>\$1,268.00</b> |
| EWLS-R4-GPS      | <b>Warranty:</b> Survey R4 Receiver Hardware and Firmware Maintenance               | 1   | <b>\$615.00</b>   |
| EWLS-R4-GPS-RNST | <b>Warranty Reinstatement:</b> Survey R4 Receiver Hardware and Firmware Maintenance | 1   | <b>\$923.00</b>   |
| EWLS-GPS-FW      | <b>Firmware Maintenance:</b> Survey GPS Annual Firmware                             | 1   | <b>\$400.00</b>   |
| EWLS-GPS-FW-RNST | <b>Firmware Maintenance Reinstatement:</b> Survey GPS Firmware                      | 1   | <b>\$600.00</b>   |



### Robotic & Conventional/Mechanical Total Stations

| Part #               | Description   | Qty | PLI Price         |
|----------------------|---|-----|-------------------|
| EWLS-TS-MECH-HW      | <b>Warranty:</b> Mechanical Total Station HW Extend. Warranty and Field SW Maintenance                            | 1   | <b>\$669.00</b>   |
| EWLS-TS-MECH-HW-RNST | <b>Warranty Reinstatement:</b> Mechanical Total Station Hardware Extended Warranty & Field Software Reinstatement | 1   | <b>\$1,005.00</b> |
| EWLS-TS-SERVO        | <b>Warranty:</b> Servo Total Station Hardware Extended Warranty   | 1   | <b>\$975.00</b>   |
| EWLS-TS-SERVO-RNST   | <b>Warranty Reinstatement:</b> Servo Total Station System Hardware Extended Warranty Field Software Maintenance   | 1   | <b>\$1,463.00</b> |
| EWLS-TS-AUTO         | <b>Warranty:</b> AutoLock Total Station Hardware Extended   | 1   | <b>\$1,195.00</b> |
| EWLS-TS-AUTO-RNST    | <b>Warranty Reinstatement:</b> AutoLock Total Station Hardware Extended   | 1   | <b>\$1,793.00</b> |
| EWLS-TS-ROBOT        | <b>Warranty:</b> Robotic Total Station Hardware Extended  | 1   | <b>\$1,595.00</b> |
| EWLS-TS-ROBOT-RNST   | <b>Warranty Reinstatement:</b> Robotic Total Station Hardware Extended  | 1   | <b>\$2,393.00</b> |
| EWLS-ST5             | <b>Warranty:</b> Trimble Scanning Total Station Hardware Extended Warranty  | 1   | <b>\$3,990.00</b> |
| EWLS-ST5-RNST        | <b>Warranty Reinstatement:</b> Scanning Total Station HW Ext.   | 1   | <b>\$5,985.00</b> |



### GIS/Mapping Hardware & Software

| Part #   | Description  | Qty | PLI Price       |
|----------|--|-----|-----------------|
| 47288-87 | <b>1-Year SW Main. Ext.:</b> Positions Mobile Ext. (Perpetual) - Single    | 1   | <b>\$99.00</b>  |
| 47289-53 | <b>1-Year Hardware Warranty Extension:</b> Juno Series/Laser Ace 3D        | 1   | <b>\$149.00</b> |
| 47288-71 | <b>1-Year Software Maintenance Extension</b>                               | 1   | <b>\$295.00</b> |
| 47289-71 | <b>1-Year Hardware Warranty Extension</b>                                  | 1   | <b>\$325.00</b> |
| 47288-72 | <b>2-Year Software Maintenance Extension</b>                               | 1   | <b>\$390.00</b> |
| 46837-95 | <b>GPS Correct Extension:</b> ArcPad Software Update                       | 1   | <b>\$395.00</b> |
| 47288-84 | <b>1-Year SW Main. Ext.:</b> Positions Desktop Add-In (Perpetual) - Single | 1   | <b>\$399.00</b> |
| 47289-72 | <b>2-Year Hardware Warranty Extension</b>                                  | 1   | <b>\$450.00</b> |
| 45955-95 | <b>Field Software Update:</b> TerraSync Professional                       | 1   | <b>\$590.00</b> |
| 34191-95 | <b>Software Update:</b> GPS Pathfinder Office                              | 1   | <b>\$850.00</b> |
| 52726-95 | <b>Software Update:</b> GPS Analyst Extension for ESRI ArcGIS              | 1   | <b>\$850.00</b> |



**Hardware Eligibility:** In-Warranty pricing will be available for products within Factory or Extended-Warranty period. Products within Factory or Extended-Warranty period will be subject to Out-of-Warranty pricing. PLI recommends Out-of-Warranty products be inspected, but will not require inspection forms.

**Software Eligibility:** Standard pricing will be available for products within Factory or Extended-Warranty period. Products that have lapsed in coverage by more than 90 Days will be subject to reinstatement pricing.





# Geospatial Positioning Equipment & Accessories

## “Protect” Your Business, Back-Up Your Investments!

Introducing TRIMBLE PROTECTED PLUS+ for Survey Equipment



### Stay Productive!

- Maintain Fixed, Scalable Maintenance Expenditures!
- Avoid Surprises That Result In Lost Time & Money!
- Retain Peace of Mind; No More “Bad News” Moments!
- Stay Current & Consistent on Software & Firmware!
- Purchase a Plan Through PLI & Any Equipment Under Warranty Will Be Covered By a FREE Rental During Service Repairs!

### Trimble Protected Plus+ Features:

Hardware (GNSS Antennas, Control Units, GNSS Receiver Handhelds, Levels, Radios, Tablets & Total Stations)

|                             |  |                          |
|-----------------------------|--|--------------------------|
| • Sold in 1-Year Increments | • Includes Protection Against Hardware Defects   | • NO DEDUCTABLES, EVER!  |
| • Firmware Updates          | • Transferable Ownership (Follows Serial Number) | • Parts & Labor Coverage |

Software & Firmware (Control Units, GNSS Receiver Handhelds, Tablets & Total Stations)

|             |                 |                |   |
|-------------|-----------------|----------------|---|
| • Bug Fixes | • Minor Updates | • Enhancements | • AccessSync, Cloud-Based File Trans. Service |
|-------------|-----------------|----------------|---|

### NEW! Value-Added Features Give You Protection Against:



### Also Included: Annual Inspect-Clean-Calibrate Service for Survey Total Stations!

Total Station Coverage includes one Inspect-Clean-Calibrate service repair per year for each year of extended warranty coverage purchased.

## Unparalleled Technical Support & Training



### Construction Support

Anthony Pascuzzi | 412.287.3274 | ARP@laserinst.com

### Survey Support

Anthony Pascuzzi | 412.287.3274 | ARP@laserinst.com  
Aric Mompher | 614.332.6291 | AGM@laserinst.com

### GIS/Mapping Support

Jeremy Summerville | 412.552.0848 | JDS@laserinst.com



### Construction Training

Sean Geis | 412.439.2743 | SPG@laserinst.com

### Survey Training

Anthony Pascuzzi | 412.287.3274 | ARP@laserinst.com

### GIS/Mapping Training

Jeremy Summerville | 412.552.0848 | JDS@laserinst.com

- Certified Trainers
- PDH/CEU Credits Available
- Customize by Location, Duration & Topic



# Geospatial Positioning Equipment & Accessories

## Verified Accuracy in Real-Time Virtual Reference Station (VRS) Systems

- Instant access to real-time kinematic (RTK) corrections
- Centimeter-accurate corrections tailored to your geographic location
- Built-in redundancy to ensure connectivity, consistency & quality
  - Cost-effective & simple to use
  - Professionally-managed & secure
- Streamlined workflows, done right the first time

### What Are VRS Corrections?



A VRS system is one option for providing real-time differential correction to a GNSS receiver. It is the most commonly used technology behind most network correction services worldwide.

Corrections are necessary to eliminate errors and improve the accuracy of GNSS positions in collected data. VRS corrections are available from a variety of public and commercial services.

VRS networks and subscription services provide dual-frequency (L1/L2) real-time differential GPS (DGPS) and in many cases DGNSS (GPS and GLONASS) corrections for accuracy as data is collected.

A VRS service uses data from several (permanent) reference stations to compute corrections that are generally more accurate than corrections from a single reference station. Corrections are then broadcast over the Internet.

### Why Do I Need VRS Corrections?

The use of VRS corrections helps ensure the accuracy of GNSS data, independent of the distance to the nearest reference station.

### Aren't VRS Corrections Just for Surveyors?

The need for reliable and accurate positioning is not limited to surveying!

Today, a variety of industries including electric and gas utilities, water and wastewater services, and land management projects require mapping products that provide decimeter or better accuracy positioning in real-time.

### How it Works:

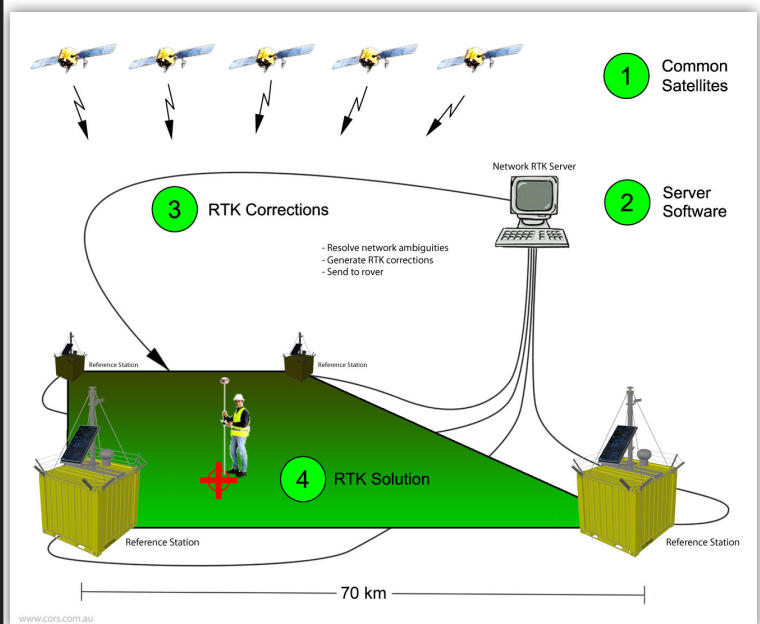

## VRS/Real-Time Network Solutions in Your Area:

(Please Contact Your Local PLI Store for More Information)





# Geospatial Positioning Equipment & Accessories

## Survey Total Station Accessories

### Trimble SX10 & S-Series Robotic Total Station Accessories

| Part #   | Description  | Qty | PLI Price  |
|----------|--|-----|------------|
| 73840019 | Trimble Instrument/Adv. Holder to PC Connection Cable                  | 1   | \$65.00    |
| TRB-3    | Empire 7.4v Lithium Battery Replacement                                | 1   | \$85.90    |
| 99511-30 | Trimble Li-Ion Battery, 10.8v, S-Series                                | 1   | \$155.00   |
| 58012029 | Trimble 360 Degree Prism, 1in., P.C., 2mm.                             | 1   | \$1,015.00 |
| 58128001 | Trimble 360 Prism w/ Height Adapter                                    | 1   | \$995.00   |
| AT360    | Trimble Active Track 360 Target w/ 7.4v. Li-ion Battery (NOT FOR SX10) | 1   | \$2,150.00 |
| MT1000   | Trimble MultiTrack Target w/ 7.4v. Li-ion Battery                      | 1   | \$2,750.00 |



### Spectra Precision Robotic Total Station Accessories

| Part #     | Description  | Qty | PLI Price  |
|------------|--|-----|------------|
| 59276025-I | SP FOCUS Radio Antenna, 2.4GHz, TNC/R                        | 1   | \$15.00    |
| 73841019   | SP Cable - 0.18m, Hirose 6-Pin to USB or Compact Flash Card  | 1   | \$50.00    |
| 73840019   | SP Cable - 2.5m, Hirose 6-Pin to PC USB                      | 1   | \$65.00    |
| 572202326  | SP Cable - 3.0m, Car Battery to (Croc Clips) to Hirose 6-Pin | 1   | \$80.00    |
| 53009012   | SP Cable - Coiled, External Radio, Hirose 12-Pin to DB9      | 1   | \$85.00    |
| 92670-10   | SP Battery - Li-ion, 2.8ah, 7.4v                             | 1   | \$120.00   |
| /92670     |  |     | /114.00    |
| 53002021   | SP Cable - 2.5m, Hirose 6-Pin to DB9 Female RS232            | 1   | \$194.25   |
| 53021010   | SP Dual Li-ion Battery Charger                               | 1   | \$682.50   |
| 58128001   | SP 360 Degree Prism w/ Height Adapter                        | 1   | \$995.00   |
| 58050019   | SP SPN External Radio, 2.4GHz, Global                        | 1   | \$1,995.00 |



## Survey GNSS Receiver Accessories

### Trimble GNSS Receiver Accessories

| Part #       | Description   | Qty | PLI Price |
|--------------|---|-----|-----------|
| 89844-00     | Trimble R10 12v Vehicle Adapter for Dual Battery Charger          | 1   | \$45.00   |
| 89854-00     | Trimble R10 UHF Radio Ant. w/ SMA, 410-470MHz, 0DB                | 1   | \$50.00   |
| 89842-00     | Trimble R10 Int. Power Supply for Dual Bat. Charger & Receiver    | 1   | \$95.00   |
| 89845-00     | Trimble R10 Quick Release Adapter, 0.05m                          | 1   | \$250.00  |
| 89840-00     | Trimble R10/R8 Rechargeable Battery, 7.4v, 3700mAh, 27.3Wh        | 1   | \$145.00  |
| 89841-00     | Trimble R10/R8 Dual Bat. Charger w/ Bat. Slot Inserts, Int. Power | 1   | \$750.00  |
| 44085-46-SUR | Trimble R8 Antenna 5in Whip - TNC 410-470MHz Radio                | 1   | \$50.00   |
| TRB-3        | Trimble R8 Empire 7.4v Lithium Battery Replacement                | 1   | \$85.90   |
| 92670-10     | Trimble R8 Battery - Li-ion, 2.6Ah, 7.4v, 19.2Wh                  | 1   | \$120.00  |
| /92670       |   |     | /114.00   |
| 89851-00     | Trimble R8 Serial Field Data Cable (7 P Lemo to DB9)              | 1   | \$145.00  |



## Instrument Radio Accessories

### Trimble TDL 450 Radio Accessories

| Part #      | Description   | Qty | PLI Price |
|-------------|---|-----|-----------|
| 51871-50-70 | SP TDL Radio Antenna, 0Db - 5Db Whip, 450-470MHz          | 1   | \$141.00  |
| 44482-00    | SP TDL Radio Antenna Mast Kit                             | 1   | \$204.75  |
| 66656-00    | SP TDL Cable - TDL 450 / HPB450 (0S / 1S Lemo; SAE Power) | 1   | \$208.00  |
| 74450-50-70 | SP TDL 450 5Db Gain Antenna Kit w/ Case, 450-470MHz       | 1   | \$331.00  |
| 74450-14    | SP TDL 450H Field Battery/Charger Kit                     | 1   | \$406.00  |



## Survey Data Controller Accessories

### Trimble TSC3 Accessories

| Part #      | Description  | Qty | PLI Price |
|-------------|--|-----|-----------|
| 82756-00    | Trimble TSC3 UV Screen Protectors, Anti-Glare            | 15  | \$13.00   |
| 82755-00    | Trimble TSC3 Hand Strap                                  | 1   | \$15.00   |
| 82754-00    | Trimble TSC3 Stylus Pen Kit (2x Styli, 1x Stylus Tether) | 1   | \$25.00   |
| 82766-00    | Trimble TSC3 Antenna for Internal 2.4GHz Radio Module    | 1   | \$25.00   |
| 5196-18     | Trimble TSC3 Tripod Bracket                              | 1   | \$25.95   |
| 82752-00    | Trimble TSC3 International Power Supply Kit              | 1   | \$95.00   |
| 82750-00    | Trimble TSC3 Rechargeable Battery w/ Battery Door        | 1   | \$125.00  |
| 82753-00    | Trimble TSC3 12v Vehicle Charging Cable                  | 1   | \$149.00  |
| 82758-00    | Trimble TSC3 Range Pole Bracket                          | 1   | \$155.00  |
| 5200-150    | Seco Pole Claw Clamp (Plain)                             | 1   | \$72.50   |
| 5200-065    | Seco TSC3/Ranger Claw Cradle                             | 1   | \$78.95   |
| 5200-16-050 | Seco TSC3/Ranger Cradle Assembly                         | 1   | \$90.95   |





# Geospatial Positioning Equipment & Accessories

## Survey Data Controller Accessories (Continued)

### NEW! Trimble TSC7 Accessories

| Part #      | Description   | Qty | PLI Price  |
|-------------|---|-----|------------|
| 121351-01-1 | Trimble TSC7 Hand Strap   | 1   | \$20.00    |
| 121344-01-1 | Trimble TSC7 Shoulder Sling   | 1   | \$25.00    |
| 82761-00    | Trimble TSC7 Serial Data cable, 1.0m (DB9 to DB9)                       | 1   | \$25.00    |
| 121355-01-1 | Trimble TSC7 Stylus w/ Tether   | 1   | \$35.00    |
| 121340-01-1 | Trimble TSC7 Glass Screen Protector                                     | 1   | \$45.00    |
| 121354-01-1 | Trimble TSC7 Carry Case Shoulder Bag                                    | 1   | \$60.00    |
| 121341-00-1 | Trimble TSC7 AC Adapter w/ Int. Cord                                    | 1   | \$115.00   |
| 121341-07-1 | Trimble TSC7 AC Adapter w/ CHN Cord                                     | 1   | \$115.00   |
| 104980-01-1 | Trimble TSC7 12V Vehicle Adapter  | 1   | \$189.00   |
| 121330-01-1 | Trimble TSC7 USB I/O Boot   | 1   | \$199.00   |
| 121330-02-1 | Trimble TSC7 Serial I/O Boot  | 1   | \$199.00   |
| 121349-01-1 | Trimble TSC7 Pole Mount   | 1   | \$199.00   |
| 121320-01-1 | Trimble TSC7 Rechargeable Battery 2-Pack                                | 2   | \$200.00   |
| 121345-01-1 | Trimble TSC7 Desktop Hub  | 1   | \$220.00   |
| 121343-01-1 | Trimble TSC7 External Battery Charge                                    | 1   | \$299.00   |
| 121348-01-1 | Trimble TSC7 External Battery Charger w/ Int. Cord                      | 1   | \$320.00   |
| 121358-01-1 | Trimble TSC7 Ext. Battery Charger w/ Int. Cord, Battery 2-Pack          | 2   | \$420.00   |
| 110255-00-1 | Trimble TSC7 EM110 1D/2D Barcode Imager                                 | 1   | \$599.00   |
| 110236-00-1 | Trimble TSC7 EM111 1D/2D Barcode Imager & UHF 902-928 MHz RFID - NA     | 1   | \$1,199.00 |
| 111974-00-1 | Trimble TSC7 EM111 1D/2D Barcode Imager & UHF 865.6-867.6 MHz RFID - EU | 1   | \$1,199.00 |
| 110238-00-1 | Trimble TSC7 EM120 2.4GHz Module  | 1   | \$1,500.00 |



### Trimble Tablet Accessories

| Part #   | Description  | Qty | PLI Price |
|----------|--|-----|-----------|
| 91473-00 | Trimble Tablet Screen Protectors w/ Cleaning Cloth | 2   | \$16.00   |
| 91472-00 | Trimble Tablet Stylus w/ Tether                    | 1   | \$20.00   |
| 91486-00 | Trimble Tablet Cironet Radio Antenna               | 1   | \$30.00   |
| 91471-00 | Trimble Tablet International AC Charging Kit       | 1   | \$75.00   |
| 91470-00 | Trimble Tablet Standard Battery                    | 2   | \$199.00  |
| 91487-00 | Trimble Tablet Range Pole Bracket                  | 1   | \$325.00  |



### Spectra Precision Ranger 3 Accessories

| Part #     | Description   | Qty | PLI Price |
|------------|---|-----|-----------|
| 82756-00   | SP Ranger 3 Anti-Glare Screen Protector Glass Panel     | 15  | \$13.00   |
| 59276025-1 | SP Focus-Radio Antenna, 2.4GHz TNC/R                    | 1   | \$15.00   |
| 67501-04   | SP Ranger 3 Stylus Pen Kit (2x Styli, 1x Stylus Tether) | 1   | \$25.00   |
| 5196-18    | SP Ranger 3 Tripod Hook                                 | 1   | \$25.95   |
| 82752-00   | SP Ranger 3 International Power Supply Kit              | 1   | \$95.00   |
| 82750-00   | SP Ranger 3 Rechargeable Battery w/ Battery Door        | 1   | \$125.00  |
| 82753-00   | SP Ranger 3 12v Vehicle Charging Cable                  | 1   | \$149.00  |
| 67501-08   | SP Ranger 3 Range Pole Bracket                          | 1   | \$147.50  |
| 5200-150   | Seco Pole Claw Clamp (Plain)                            | 1   | \$72.50   |
| 5200-065   | Seco TSC3/Ranger Claw Cradle                            | 1   | \$78.95   |



### NEW! Spectra Precision Ranger 7 Accessories

| Part #      | Description  | Qty | PLI Price  |
|-------------|--|-----|------------|
| 121351-01-2 | Spectra Precision Ranger 7 Hand Strap  | 1   | \$20.00    |
| 121344-01-2 | Spectra Precision Ranger 7 Shoulder Sling                                    | 1   | \$25.00    |
| 121355-01-2 | Spectra Precision Ranger 7 Stylus w/ Tether                                  | 1   | \$35.00    |
| 121340-01-2 | Spectra Precision Ranger 7 Glass Screen Protector                            | 1   | \$45.00    |
| 121341-00-2 | Spectra Precision Ranger 7 AC Adapter w/ Int. Cord                           | 1   | \$115.00   |
| 121341-07-2 | Spectra Precision Ranger 7 AC Adapter w/ CHN Cord                            | 1   | \$115.00   |
| 104980-01-2 | Spectra Precision Ranger 7 12V Vehicle Adapter                               | 1   | \$189.00   |
| 121330-01-2 | Spectra Precision Ranger 7 USB/Serial I/O Module                             | 1   | \$199.00   |
| 121330-02-2 | Spectra Precision Ranger 7 USB I/O Boot                                      | 1   | \$199.00   |
| 121349-01-2 | Spectra Precision Ranger 7 Pole Mount  | 1   | \$199.00   |
| 121320-01-2 | Spectra Precision Ranger 7 Rechargeable Battery 2-Pack                       | 2   | \$200.00   |
| 121345-01-2 | Spectra Precision Ranger 7 Desktop Hub                                       | 1   | \$220.00   |
| 121343-01-2 | Spectra Precision Ranger 7 External Battery Charger                          | 1   | \$299.00   |
| 121348-01-2 | Spectra Precision Ranger 7 External Battery Charger w/ Int. Cord             | 1   | \$320.00   |
| 121350-01-2 | Spectra Precision Ranger 7 Ext. Battery Charger w/ Int. Cord, Battery 2-Pack | 2   | \$420.00   |
| 110238-00-2 | Spectra Precision EM120 2.4GHz Module  | 1   | \$1,500.00 |





# Geospatial Positioning Equipment & Accessories

## Mobile Computing Tablet Accessories

### Trimble Kenai Tablet Accessories

| Part #       | Description  | Qty | PLI Price |
|--------------|--|-----|-----------|
| 91472-00     | Trimble Stylus                                     | 1   | \$20.00   |
| ACCAA-376    | Trimble Kenai Standard Screen Protector Kit        | 1   | \$45.00   |
| ACCAA-260    | Trimble Kenai Hand Strap                           | 1   | \$59.00   |
| ACCAA-377    | Trimble Kenai Anti-Polarizing Screen Kit           | 1   | \$69.00   |
| ACCAA-622    | Trimble Kenai Carry Case                           | 1   | \$79.00   |
| ACCAA-682    | Trimble Kenai Vehicle Charger (12V/24V)            | 1   | \$189.00  |
| ACCAA-118    | Trimble Kenai Standard Battery 49WHR               | 1   | \$199.00  |
| ACCAA-775-GC | Trimble Kenai Pole Mounting Kit                    | 1   | \$395.00  |
| ACCAA-683    | Trimble Kenai Desktop Battery Charger & AC Adapter | 1   | \$399.00  |
| ACCAA-711    | Trimble Kenai Office Docking Station               | 1   | \$499.00  |



### NEW! Trimble T10 Tablet Accessories

| Part # | Description   | Qty | PLI Price |
|--------|---|-----|-----------|
| 114125 | Trimble T10 Tablet Shoulder Strap   | 1   | \$19.00   |
| 114112 | Trimble T10 Tablet AC Adapter w/ Power Cord (19V/65W Out)                     | 1   | \$69.00   |
| 114124 | Trimble T10 Tablet Carrying Case  | 1   | \$99.00   |
| 114116 | Trimble T10 Keyboard w/ Trackpad  | 1   | \$119.00  |
| 114113 | Trimble T10 Tablet Battery Charger Kit / Single Battery                       | 1   | \$199.00  |
| 114111 | Trimble T10 Tablet BPack, Li-Ion, INDUS, 3S2P, 11.4V, 8000mAh, 123x147x18.4mm | 1   | \$299.00  |
| 114119 | Trimble T10 Office Dock (AC Adapter Not Included)                             | 1   | \$229.00  |
| 114114 | Trimble T10 Tablet Battery Charger/Gang Charger                               | 1   | \$499.00  |
| 114121 | Trimble T10 Pole Mount w/ Quick Release                                       | 1   | \$559.00  |



## Mapping & GIS Equipment Accessories

### Trimble R1 GNSS Receiver Accessories

| Part #    | Description                 | Qty | PLI Price |
|-----------|-----------------------------|-----|-----------|
| 102016-01 | Trimble R1 Belt Pouch       | 1   | \$35.00   |
| 102015-01 | Trimble R1 Pole Mount Pouch | 1   | \$35.00   |
| 102017-15 | Trimble R1 External Antenna | 1   | \$39.00   |



### Trimble R2 GNSS Receiver Accessories

| Part #       | Description   | Qty | PLI Price |
|--------------|---|-----|-----------|
| 101071-00-01 | Trimble R2 Power Supply & Cord for Dual Battery Charger | 1   | \$95.00   |
| 92670        | Trimble R2 Li-Ion, 2.6Ah, 7.4v, 19.2Wh Battery          | 1   | \$114.00  |
| 39870        | Trimble R2 Backpack                                     | 1   | \$175.00  |
| 101070-00-01 | Trimble R2 Dual Battery Charger w/ Power Supply & Cord  | 1   | \$600.00  |



### Trimble GeoExplorer 6000 & Geo 7 Series Accessories

| Part #            | Description  | Qty | PLI Price       |
|-------------------|--|-----|-----------------|
| 88015-00          | Trimble Geo 6000/Geo 7 Series USB Data Cable (1.8m)            | 1   | \$15.00         |
| 93773-03/88006-13 | Trimble Geo 7 Series Hand Strap/ Geo 6000 Series Handstrap Kit | 1   | \$15.00/\$20.00 |
| 88055-13          | Geo 6000/Geo 7 Series Replacement Stylus Kit                   | 1   | \$20.00         |
| 93601-02          | Trimble Geo 6000/Geo 7 Series Antiglare Screen Protector       | 2   | \$20.00         |
| 93598-01          | Trimble Geo 7 Series Soft Pouch                                | 1   | \$40.00         |
| 88049-03          | Geo 6000/Geo 7 Series USB to Serial Converter Cable            | 1   | \$45.00         |
| 88014-00          | Trimble Geo 6000/7 AC Power Supply w/ International Adapt.     | 1   | \$50.00         |
| 88056-00          | Geo 6000/Geo 7 Series 12v DC Power Supply (15v 1A Output)      | 1   | \$50.00         |
| 70800-15          | Trimble Geo 6000/7 Ext. Antenna Cable (TNC to SMB -1.5m)       | 1   | \$70.00         |
| 50643-3M          | Hurricane/Zephyr Geo Ant. Cable, 3M                            | 1   | \$105.00        |
| 50643-1.5M        | Hurricane/Zephyr Antenna Cable                                 | 1   | \$113.25        |
| 93599-00          | Trimble Geo 7 Series Bracket                                   | 1   | \$135.00        |
| 50643-5M          | 5M Geo XH/Hurricane Cable, SMB Male/TNC                        | 1   | \$145.00        |
| 88004-04          | Trimble Geo 6000/Geo 7 Series Li-Ion Bat. Pack (11.1v, 2.5Ah)  | 1   | \$195.00        |
| 94916-00          | Trimble Geo 7 Series Monopole Kit                              | 1   | \$495.00        |
| 93879-00          | Trimble Rangefinder Module for Geo 7 Series                    | 1   | \$1,195.00      |



Chris Walker | Rental Manager  
CRW@laserinst.com

## RENT THE LATEST & GREATEST!



DAILY, WEEKLY & MONTHLY RATES  
ALL NECESSARY ACCESSORIES  
SHIPPING & PICK-UP OPTIONS  
CALL 724.266.1600 TO LEARN MORE!



# Geospatial Positioning Equipment & Accessories

## Underground/Utility Locators

### CST/Berger Magnetic Locators

| Part #   | Description                                  | Qty | PLI Price |
|----------|--|-----|-----------|
| 19-202SC | CST/Berger Magna-Trak MT202 Magnetic Locator | 1   | \$599.00  |



### Leica Geosystems Underground Locators & Detection Solutions

| Part #  | Description  | Qty | PLI Price  |
|---------|--|-----|------------|
| 798643  | Leica Geosystems DigiCat 550i xf (Xtra Frequency) Utility Service Locator (60Hz) w/ Depth Indicator (ft/in/metric selectable)  | 1   | \$1,395.00 |
| 798648  | Leica Geosystems DigiTex 100 xf (Xtra Frequency) Signal Generator  | 1   | \$1,080.00 |
| 798649  | Leica Geosystems DigiTex 300 xf (Xtra Frequency) Signal Generator  | 1   | \$1,480.00 |
| 6011143 | Leica Geosystems ULTRA Locator 5 Watt Standard Kit (Includes: ULTRA Standard Locator, Standard 5 Watt Transmitter, ULTRA 5" (125mm) Signal Clamp, System Bag, Quick Guide & User Manual)   | 1   | \$5,092.00 |
| 6011142 | Leica Geosystems ULTRA Locator 12 Watt Standard Kit (Includes: ULTRA Standard Locator, Standard 12 Watt Transmitter, Ultra 5" (125mm) Signal Clamp, System Bag, Quick Guide & User Manual) | 1   | \$5,762.00 |
| 6011141 | Leica Geosystems ULTRA Locator 12 Watt Advanced Kit (Includes: ULTRA Advanced Locator, Advanced 12 Watt Transmitter, ULTRA 5" (125mm) Signal Clamp, System Bag, Quick Guide & User Manual) | 1   | \$7,102.00 |
| 818711  | Leica Geosystems ULTRA Transmitter Dual Output Cable   | 1   | \$302.00   |
| 842433  | Leica Geosystems Receiver Stethoscope  | 1   | \$469.00   |
| 818709  | Leica Geosystems ULTRA Transmitter battery Pack  | 1   | \$614.00   |
| 731053  | Leica Geosystems DigiMouse, Signal Point   | 1   | \$675.00   |
| 818708  | Leica Geosystems A Frame Electrical Fault Locator  | 1   | \$726.00   |
| 796703  | Leica Geosystems DigiTrace 50 Signal Trace, 165ft (50m)  | 1   | \$995.00   |
| 796704  | Leica Geosystems DigiTrace 80 Signal Trace, 260ft (80m)  | 1   | \$1,295.00 |



|         |  |   |             |
|---------|--|---|-------------|
| 6011496 | Leica Geosystems DS2000 Utility Detection GPR Cart Kit | 1 | \$23,500.00 |
|---------|--|---|-------------|

### Schonstedt Magnetic & Utility Locators

| Part #     | Description                         | Qty | PLI Price  |
|------------|-------------------------------------|-----|------------|
| REX        | Schonstedt REX Pipe & Cable Locator | 1   | \$2,845.00 |
| XTPC-33-HC | Schonstedt Cable & Pipe Locator     | 1   | \$2,295.00 |
| XTPC-82-HC | Schonstedt Cable & Pipe Locator     | 1   | \$2,317.00 |
| GA-52CX    | Schonstedt Magnetic Locator         | 1   | \$840.00   |
| GA-72CD    | Schonstedt Magnetic Locator         | 1   | \$995.00   |
| GA-92XTD   | Schonstedt Magnetic Locator         | 1   | \$964.00   |
| MAGGIE     | Schonstedt Magnetic Locator         | 1   | \$826.00   |

Ask About Our REX & GA92XTD Kit!



### SubSurface Instruments, Inc. Magnetic Locators & Water Leak Detectors

| Part #  | Description  | Qty | PLI Price  |
|---------|--|-----|------------|
| ML-1    | SubSurface Instruments Magnetic Locator                    | 1   | \$934.95   |
| ML-1M   | SubSurface Instruments Magnetic Locator                    | 1   | \$934.95   |
| ML-3S   | SubSurface Instruments Waterproof Magnetic Locator - Small | 1   | \$745.00   |
| ML-3L   | SubSurface Instruments Waterproof Magnetic Locator - Long  | 1   | \$980.00   |
| PL-2000 | SubSurface Instruments Pipe & Cable Locator                | 1   | \$3,675.00 |
| LD-7    | SubSurface Instruments Water Leak Detector                 | 1   | \$1,565.00 |
| LD-8    | SubSurface Instruments Water Leak Detector                 | 1   | \$1,995.00 |
| LD-12   | SubSurface Instruments Water Leak Detector                 | 1   | \$3,575.00 |
| LD-15   | SubSurface Instruments Water Leak Detector                 | 1   | \$4,195.00 |
| LD-18   | SubSurface Instruments Water Leak Detector                 | 1   | \$6,095.00 |





**Precision Laser  
& Instrument, Inc.**  
www.laserinst.com

Construction • Survey • GIS

Sales • Service • Rentals • Training • Support

Monday-Friday, 7:30am-4:30pm | Saturday, 8:00am-12:00pm (Pittsburgh Only)



**Locations:**  
(Full Addresses On Back Cover)

Pittsburgh, PA (HQ): 724.266.1600  
Columbus, OH: 614.759.1000  
Cincinnati, OH: 513.539.0022  
Akron, OH: 330.633.4900  
Charleston, WV: 304.776.1831  
Bridgeport, WV: 304.933.3036

## Geospatial Positioning Equipment & Accessories

# Trimble Forensics

## Collect. Document. Analyze.



## Crashes. Crime Scenes. Security.

*A Powerful Solution for Today's World*



Trimble Forensics is a powerful package of hardware and software designed specifically to help law enforcement and private sector security agencies handle the toughest information-collection challenges. It comes with unparalleled service, training and local support from experts who understand and embrace the law enforcement mission.

Featuring a broad selection of survey total stations, scanners, GIS/mapping data collectors and software, Trimble Forensics enables law enforcement personnel. Furthermore, Trimble Forensics scanners and software, including an exclusive SmartRooms feature that automates the creation of animations and drawings of complex rooms and buildings, make it easier for security planners to protect facilities and people.

**Contact Your Local PLI Sales Rep. or Call 724.266.1600 To Learn More!**

**STEP ONE:**

Choose the field capture hardware that fits your operation.



**STEP TWO:**

Select the field collection device designed for the way you work.



**STEP THREE:**

Pick the right software for the field and office.



Shop Online! E-Commerce Store: [www.laserinst.com](http://www.laserinst.com)



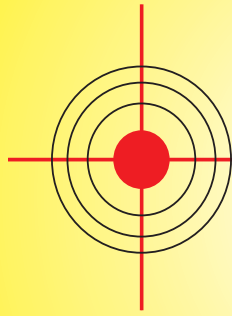

# Precision Laser & Instrument, Inc.

[www.laserinst.com](http://www.laserinst.com)

Construction • Survey • GIS

Sales Service Rentals Training Support

## A Dedicated Business Partner & One-Stop Shop

We are Precision Laser & Instrument, Inc., an “Authorized Distribution Partner” of Trimble equipment and accessories. Our company provides comprehensive positioning solutions for the Construction, Surveying and GIS industries by offering:

- **Sales** of top-quality laser, optical and positioning equipment, field supplies and accessories
- **Service** centers that have made us a “Preferred Service Provider” and “Authorized Warranty Center” for manufacturers including Trimble®, Spectra Precision®, Nikon®, CST/Berger®, Leica®, AGL®, Apache® and PLS®
- **Rentals** with a “Rent-to-Purchase” (Credit Option) for cost-effective solutions to supplement existing equipment
- **Training** and **Technical Support** that is available with every sale or rental made, and that can be customized by length and location to fit all of your job-specific needs



Rod Creese (Partner), Rob Barth (Partner),  
Mark Maximovich (VP of Operations & Finance)

### Our Purpose

*“We will provide sales, rentals, service and “concept to completion support” of the highest quality laser, optical and GPS equipment and related technologies through strong, long-term relationships with our customers.”*

### Our Role

*“We are trusted partners in your business, committed to providing the expertise and domain knowledge to meet your full range of equipment needs long after the initial sale.”*

### Our Promise

*“We will go beyond selling a product to offer a complete, customized solution, ensuring maximum return on your equipment investment and ultimate business success.”*

### Our Partners



CST/berger



SCHONSTEDT  
INSTRUMENT COMPANY

SECO



#### Pittsburgh, PA

85 11th Street  
Ambridge, PA 15003  
Ph: 724.266.1600  
Fax: 724.266.8161

#### Columbus, OH

372 Morrison Rd., Ste. D  
Columbus, OH 43213  
Ph: 614.759.1000  
Fax: 614.759.7059

#### Cincinnati, OH

820-B Lebanon St.  
Monroe, OH 45050  
Ph: 513.539.0022  
Fax: 513.539.0033

#### Akron, OH

2567 S. Arlington Rd. # 5  
Akron, OH 44319  
Ph: 330.633.4900  
Fax: 330.633.4999

#### Charleston, WV

504 Old Goff Mtn. Rd.  
Cross Lanes, WV 25313  
Ph: 304.776.1831  
Fax: 304.776.6790

#### Bridgeport, WV

919 West Main St.  
Bridgeport, WV 26330  
Ph: 304.933.3036  
Fax: 304.933.3584