



**Precision Laser
& Instrument, Inc.**

www.laserinst.com

Construction • Surveying • GIS

Sales • Service • Rentals • Training • Support



PLI 2021 Catalog (Ver. 12.0)

Surveying Equipment, Supplies & Accessories

Your Hand Guide to Positioning Essentials!

Pittsburgh, PA (HQ) | 724-266-1600

Columbus, OH
614-759-1000

Cincinnati, OH
513-539-0022

Cleveland/Akron, OH
330-633-4900

Toledo, OH
419-243-7271

Charleston, WV
304-776-1831

Bridgeport, WV
304-933-3036

Table of Contents



**Local Pick-Up
& Delivery!**



SHOP ONLINE!
WWW.LASERINST.COM

Note: Due to market fluctuations beyond our control, all prices in this catalog are subject to change per dealer discretion.

Field Supplies & Accessories

Grade Rods.....	Page 4	Tripods.....	Page 4
Tribrachs & Adapters.....	Page 5	Prisms.....	Page 5
Plumb Bobs & Accessories.....	Pg 5-6	Datum Markers & Smart Targets.....	Page 6
Prism Poles & Accessories.....	Page 7	Bipods.....	Page 7
Hand Levels.....	Page 8	Nails & Fasteners.....	Page 8
AutoLevels, Transits & Theodolites.....	Page 9	Tape Measures & Wheels.....	Pg 10-11
Rebar & Rebar Caps.....	Page 11	Marking Paint, Chalk & Lumber Crayons.....	Page 12
Survey Markers, Benchties & Hub Discs.....	Page 13	Wood Hubs, Flats, Wedges & Lath.....	Page 13
Flagging & Whiskers.....	Pg 13-14	Field Books & Binders.....	Page 15
Carrying Cases & Bags.....	Pg 15-16	Safety Glasses.....	Page 16
Hard Hats.....	Page 16	Safety Vests.....	Page 17
Two-Way Radios.....	Page 17	Road Signs & Accessories.....	Page 17
Survey Vehicle Accessories.....	Page 18	Hand Tools.....	Page 18
Alternative Leveling Solutions.....	Page 18		

Construction Solutions

Leveling Lasers.....	Page 19	Grade Lasers.....	Page 19
Pipe Lasers.....	Page 20	Utility Lasers.....	Page 20
Interior Lasers.....	Page 21	Hand Receivers.....	Page 21
iDig Grade Control System.....	Page 21	Machine Receivers.....	Page 22
Laser Lenker Rods.....	Page 22	Two-Person Layout Packages.....	Page 23
Underground Utility Locating.....	Page 24	Building Construction Solutions (BPOV).....	Pg 25-26

Surveying Solutions

GNSS Receivers.....	Page 27	Robotic Total Stations.....	Pg 28-29
Mechanical Total Stations.....	Page 29	Survey Total Station Accessories.....	Page 30
Survey GNSS Receiver Accessories.....	Page 30	Instrument Radio Accessories.....	Page 30
Data Controllers & Rugged Tablets.....	Page 31	Data Controller Accessories.....	Pg 31-33
Surveying Software.....	Page 34	Virtual Reference Station (VRS) Systems.....	Page 35
Hydrographic Surveying Solutions.....	Page 36		

GIS/Mapping Solutions

Handheld GIS Data Controllers.....	Page 37	Mapping GNSS Receivers.....	Page 37
GIS Software Solutions.....	Page 37	GIS Positioning Services.....	Page 37
GIS Mapping Accessories.....	Page 38		

(Ver. 12.0)



**Precision Laser
& Instrument, Inc.**
www.laserinst.com

Precision Laser & Instrument, Inc.
is a Factory Authorized Warranty Service Center
Specializing in Cleaning, Calibration & Warranty Repairs.

From, Sales & Rentals to Service & Support,
Our Expert Staff Truly Set Us Apart!

Visit One of Our 7 Locations
in Pennsylvania, Ohio & West Virginia!
(Full Addresses on Back Cover)



Establishing a reputation for excellence doesn't just come from being in business for many years, nor does it come from knowing the industry. It comes from seeing & recognizing the world through the eyes of your customers. **Most importantly, it comes from getting the job done right the first time, every time.** That's how we've built our reputation for excellence here at Precision Laser & Instrument, Inc.

Our Purpose

"We will provide sales, rentals, service & "concept to completion support" of the highest laser, optical & GPS equipment & related technologies through strong, long-term relationships with our customers."

Our Role

"We are trusted partners in your business, committed to providing the expertise & domain knowledge to meet your full range of equipment needs long after the initial sale."

Our Promise

"We will go beyond selling a product to offer a complete, customized solution, ensuring maximum return on your equipment investment & ultimate business success."

Robert J. Barth

Robert J. Barth

Partner

Rodney Creese

Rodney Creese

Partner





Forensics Supplies

- Magnails.....Page 8
- Measuring Tapes.....Page 10-11
- Spray Paint & Dispensers.....Page 12
- Lumber Crayons.....Page 12
- Hub Discs.....Page 13
- Wire & Rolled Flagging.....Pg 13-14



Crashes



Crime Scenes



Security

A Powerful Solution for Today's World

Trimble Forensics is a powerful package of hardware & software designed specifically to help law enforcement & private sector security agencies handle the toughest information-collection challenges. It comes with unparalleled service, training & support from experts who understand & embrace the law enforcement mission.

Featuring a broad selection of surveying total stations, 3D scanners, GIS/mapping data collectors & software, Trimble Forensics enables law enforcement personnel. Furthermore, Trimble Forensics scanners & software, including an exclusive SmartRooms feature that automates the creation of animations & drawings of complex rooms & buildings, makes it easier for security planners to protect facilities & people.

To Learn More, Please Contact:

Todd Jester

Applied Forensics Specialist

Ohio State Highway Patrol (Retired) - Crash/Crime Scene Reconstruction

Mobile: 330-787-1884 | Email: CTJ@laserinst.com

STEP ONE:

Choose the field capture hardware that fits your operation.



STEP TWO:

Select the field collection device designed for your workflow.



STEP THREE:

Pick the right software for field & office.



7301-50	Almnm. 16ft (Engr.)	\$69.94
7321-50	Almnm. 16ft (In.)	\$69.94
92021	CR 13ft (Engr.)	\$86.11
92022	CR 13ft (In.)	\$86.11
92041	CR 16ft (Engr.)	\$120.64
92042	CR 16ft (In.)	\$120.64

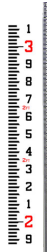

seco

92031	CR 20ft (Engr.)	\$133.11
92032	CR 20ft (In.)	\$133.11
98010	SVR 25ft (Engr.)	\$212.16
98011	SVR 25ft (In.)	\$212.16
90004	LR-STD 25ft (Engr.)	\$288.40
90022	LR-PRO 25ft (Engr.)	\$337.83
90024	LR-PRO 35ft (Engr.)	\$500.59
90026	LR-PRO 45ft (Engr.)	\$600.50

11-SPR25-T	25ft (In/10ths)	\$192.18
11-SPR25-C	25ft (In/8ths)	\$192.18
808338	25ft Rod	\$160.00
807348	25ft Rod (ft/10ths)	\$160.00



SitePro SOKKIA

TRIPODS



seco CRAIN CST/berger



SitePro



5610-00	Heavy Duty Aluminum Tripod Stabilizer	\$112.43
90553-PL	Tri-Max Dual-Camp, Heavy Duty Tripod	\$341.00
5321-17-ORG	Heavy Duty, Elevating, Fiberglass Tripod	\$384.26
60-ALQRI20-BPL	Aluminum, Quick-Clamp Tripod	\$79.50
60-FGHD20	HD Fiberglass Tripod w/ Quick Clamp	\$123.00
60-WDF20	Wood/Fiberglass Tripod	\$142.00
60-ALQRI20ELAZ	Elevating Tripod w/ Quick Clamp	\$210.00
210710	Industrial, Elevating 3D Scanner Tripod	\$1,375.00
01-RHIVIZ20-B	Dual-Clamp, Fiberglass Robot. Tripod	\$168.87
01-SHIVIZ20-B	Composite Surveyor Tripod	\$141.46
01-VHIVIZ20-B	Composite Contractor Tripod	\$103.98
01-FGC20ELAZ-B	Fiberglass Elevating Tripod	\$168.04

01-TFG2	Tripod Floor Guide, Large	\$29.61
01-TLS	Tripod Floor Guide	\$10.01
5610-15	3-Wheel Tripod Dolly	\$650.00



SitePro

RENT THE LATEST & GREATEST POSITIONING EQUIPMENT!

CHRIS WALKER | RENTAL MANAGER
724-266-1600 | CRW@LASERINST.COM

DAILY, WEEKLY & MONTHLY RATES
SHIPPING & PICK-UP OPTIONS

TRIBRACHS & ADAPTERS



seco  **SitePro**

2010-00	Fixed Tribrach Adapter	\$39.89
2020-00	Rotating Tribrach Adapter	\$48.76
2070-00	Rotating, Swiss-Style Adapter	\$61.27
05-1200-BBAG	Tribrach w/ Optical Plum. & Bag	\$205.72
2152-04-BLK	Tribrach w/ Optical Plummet	\$220.40
2153-04-BLK	Tribrach w/ Optical Plummet	\$204.65
2153-06-BLK	Tribrach, High-Precision w/ Opt. Pl.	\$317.91
78607007	Tribrach w/ Optical Plummet	\$310.00
58002007	Tribrach, 3 Pin w/ Optical Plummet	\$448.00



Prisms

6200-11-FOR	25mm 0/-30 Mini Prism w/ Side Vial	\$125.83
6200-10-FOR	25mm 0/-30 Mini Prism w/ Center Vial	\$125.83
6422-02-YLB	5.5in x 7in 0/-30 Prism Assembly	\$203.78
6422-02-FOB	5.5 x 7in 0/-30 Prism Assembly	\$203.78
6405-01-FOR	25mm 0/-30 Stakeout Prism Assembly	\$226.72
6405-10-FOR	0/-30 Mini Stakeout Prism w/ Site Cones	\$216.32
6405-11-FOR	0/-30 Mini Stakeout Prism Kit	\$283.77
6405-11-FLY	Stake-Out Prism w/ Bag & Adapters	\$314.63
03-1010-O	0/-30 Constant Prism System	\$132.15
03-ATP360	360 Degree Builders' Robotic Prism System	\$899.00
03-3600	360 Degree Robotics Prism	\$495.00
58020002	360 Prism w/ Height Adapter to Std. Rod	\$1,195.00



seco  **SitePro**



Plumb Bobs & Accessories



seco  **SitePro**

51-10218G	Leather Gammon Reel/Plumb Bob Sheath	\$16.40
15-1016	16-18oz Plumb Bob Sheath, Leather	\$8.20
51-10107	7-Pocket Leather Surveyor's Tool Pouch	\$25.00
51-10109	9-Pocket Leather Contractor's Tool Pouch	\$31.50
51-10110-TS	Leather Tool & Nail Pouch	\$27.58
51-15062	4-Pouch Pro Leather Fastener Bag	\$62.28
51-15018-DBR	3-Pouch Leather Tool Bag w/ Tape Holder	\$75.00

51-12035XL	3" Leather Ranger Work Belt, Extra Large	\$30.69
51-12035L	3" Leather Ranger Work Belt, Large	\$29.58
51-12101L	2" Top Grain Leather Belt, Large	\$24.49
51-12101XL	2" Top Grain Leather Belt, Extra Large	\$24.49



 **SitePro**

(Ver. 12.0)



6000-012	12oz Solid Brass, Hardened Steel Point Plumb Bob	\$18.85
6000-014	14oz Solid Brass, Hardened Steel Point Plumb Bob	\$20.94
6000-016	16oz Solid Brass, Hardened Steel Point Plumb Bob	\$21.00
6000-018	18oz Solid Brass, Hardened Steel Point Plumb Bob	\$23.62
6000-024	24oz Solid Brass, Hardened Steel Point Plumb Bob	\$29.93
6000-032	32oz Solid Brass, Hardened Steel Point Plumb Bob	\$37.75
6000-002	Universal Plumb Bob Replacement Point	\$3.19

001	6ft Gammon Reel	\$15.50
012	12ft Gammon Reel	\$20.50
012HV	12ft High-Visibility Gammon Reel	\$20.50



Datum Markers & Smart Targets



03-RSAK130-R	Plate w/ Angle & 2-Target Reflector 30x30mm	\$15.95
03-RSMP290M-R	17.5mm Swiveling Mini Prism w/ 360 Rotation	\$210.00
03-RSZ3-10	Target Reflectors, 30x30mm (10 Per Sheet)	\$26.80
03-RSZ4-10	Target Reflectors, 40x40mm (10 Per Sheet)	\$31.90
03-RSZ6-4	Target Reflectors, 60x60mm (4 Per Sheet)	\$21.50
03-RS183-R	Swivelling Target Reflector, 30mm	\$45.77
RS193M	Survey Target	\$68.85
RS30	Flat Prism Level Reflective Target, 30mm	\$8.30
RS50	Flat Prism Level Smart Target, 30mm	\$6.15
RS60	Flat Prism Level Smart Target, 40mm	\$8.15
RS96	Stakeout Aid w/ Ref. Target Marker	\$57.65

RSAK130	Angled Adapter w/ Reflective Targets, 30mm	\$17.60
RSKZ6	Long Distance Survey Target	\$18.38
RSL301	Laser Scanner Target Marker	\$6.00
RSL496	Laser Scanner Target, 120mm x 120mm, Folding	\$68.50
RSLT10	Laser Target, 120mm x 140mm, Folding	\$68.50
RSMP10	Mini Prism, 12.7mm w/ Peak	\$118.10
RSMP12	Mini Prism, 17.5mm w/ Peak	\$140.10
RSMP15	Angle Plate w/ Mini Prism, 12.7mm	\$123.60
RSMP280	17.5mm Mini Prism, 30mm Tilting Axis	\$139.92
RSMP290M	Mini Prism	\$160.25

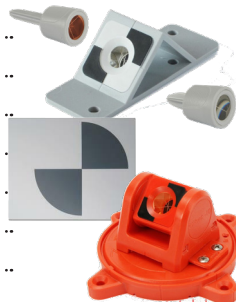

Prism Poles & Accessories



61586-20	Inverted Layout Rod w/ Metal Punch	\$435.00
43169-10	2m, Carbon Fiber Pole	\$284.00
41369-30	2.5m, Telescopic, Carbon Fiber Pole	\$350.00
51003007	2.6m, Telescopic, Std. Robotic Pole	\$379.00
43169-00	2m, Carbon Fiber Pole w/ Bipod	\$535.00
43169-20	2.5m, Tele., C. Fiber Pole w/ Bipod	\$597.00
89848-00	2m, C.F. Pole w/ Q. Release Adapter	\$745.00



5160-02-WOR	4ft Range Pole	\$33.47	5126-10	2m GPS/GIS Pole	\$458.90
5150-02-WOR	12ft Range Pole	\$86.62	5128-20-GT	2m Rvr. Rd. "GT"	\$249.20
5530-10	8.5ft, Dual-Grad	\$89.39	5145-00-FLY	0.25m Extension	\$37.81
5540-10	8.5ft, D.Grad +	\$186.68	5111-04	60mm Qk. R. (Both)	\$140.55
5500-23	2.7-5.1ft Mini	\$188.18	5111-04-051	60mm (Female)	\$41.96
5540-20	12ft, D.G. w/ TLV	\$252.72	5111-04-050	60mm (Male)	\$41.96
5500-21	12ft, TLV Pole	\$205.91	5132-00-ACL	25cm Ext., 1.25" OD	\$37.74
5540-30	15ft. D.G. w/ TLV	\$307.97	5130-00-FLY	6" Ext., 1" OD	\$35.70
5125-06-YEL	2m, GPS Rover	\$148.72	5010-00-RED	4ft Ext., 1.25" OD	\$86.10
5125-20-YEL-GT	2m Rvr. w/ "GT"	\$156.00	5530-30	1ft Mini Stkout. Pole	\$161.20
5512-13-FLY-GM	2.6m GPS Pole	\$178.83	5214-01	Grdnr., 1.25" Rest	\$255.96
5512-14-FOR-GT	8.5ft Robotic Pole	\$178.83	5125-L-PLI-KIT	2m Pole, Bag & Bipod Kit	\$330.00
55125-22-FLY-GT	Rvr. 2.1, 8.1, 6m	\$161.20	5129-50	8.5ft Rvr Pole	\$303.85
5129-52	8.5ft Robot Pole	\$303.85			



C-001 360 Prism Holder Hands-Free Measurement Solution

seco

Hands-Free Precision & Repeatability

The Marksman C-001 is equipped with a calibrated green laser module, making it the ultimate tool for quick & accurate construction layout. Whether you're laying out multiple points, gridlines, traverse or more, this system will provides superior repeatability!

\$2,195.00

Bipods

07-4360	Thumb-Release Aluminum Bipod	\$121.85
07-4160	10" Mini Prism Bipod	\$72.15
5217-04-YEL	Original Thumb-Release Bipod	\$164.52
5217-05-YEL	Mini Thumb-Release Bipod	\$178.88
5214-00	Alligator Camp Prism Pole Tripod	\$58.81
5218-15-ABK	Mini Simple Tripod w/ 12in. Legs	\$124.79
5218-02-YEL	Original Thumb-Release Tripod	\$217.00



(Ver. 12.0)

4050-01	Abney Level	\$53.07
4040-60	1x H. Lvl., 5" Extn. w/ 1x Extnl. Vial & Stadia	\$93.81
4040-05	1x H. Lvl., 5-7" Extn. w/ Extnl. Vial & Stadia	\$117.73
4040-30	2x H. Lvl., 5-7" Extn. w/ 1x Extnl. Vial & Stadia	\$127.77
4200-00	2x H. Lvl., 5-7" Extn. w/ 2x Extnl. Vial & Stadia	\$128.31



seco



SOKKIA

804260	5x Hand Level	\$156.66
804745	6-3/8" Topographic Abney Level w/ 2 Arcs	\$169.00
804755	5x Abney Level w/ Stadia	\$236.00

36524	24" IP65 Digital TECH Level	\$260.00
36548	48" IP65 Digital TECH Level	\$290.00
37424	24" Type 196 Level	\$80.00
37448	48" Type 196 Level	\$130.00
41048	48" R-Beam Series Level	\$139.99
41072	72" R-Beam Series Level	\$209.99
34610	6-10ft Magnetic Plate Level 2	\$360.00
35712	7-12ft Magnetic Plate Level 2	\$350.00



**Work Hard.
Work SMART.**

Electronic Accuracy | Digital Displays | Audible Inclination | IP65 Rating | Shock-Absorbing End Caps | Anti-Slip Grips

Nails & Fasteners

24750	3/4" x 1/8" MagNails (100/Box)	\$5.90
241000	1" x 5/32" MagNails (100/Box)	\$7.65
241250	1 1/4" x 3/16" MagNails (100/Box)	\$11.30
241500	1 1/2" x 1/4" MagNails (100/Box)	\$15.28
242000	2" x 1/4" MagNails (100/Box)	\$18.50
242500	2 1/2" x 1/4" MagNails (100/Box)	\$22.20



ChrisNik **MAG NAIL**
Pound it Harder. Find it Further.



ChrisNik



253MAGSPIKE	3/8" x 3" MagSpikes (25/Box)	\$32.75
254MAGSPIKE	3/8" x 4 1/2" MagSpikes (25/Box)	\$40.31
256MAGSPIKE	3/8" x 6" MagSpikes (20/Box)	\$41.65
258MAGSPIKE	3/8" x 8" MagSpikes (20/Box)	\$50.75
23MAG-HUB4	3/16" x 4" MagHubs	\$77.95
23MAG-HUB6	1/4" x 6" MagHubs	\$77.95
23MAG-HUB8	1/4" x 8" MagHubs	\$77.95
25456855	Stake Tacks (1lb. Box)	\$13.02
2545644	Stake Tacks (5lb. Box)	\$44.00

(Ver. 12.0)

AutoLevels, Transits & Theodolites



David White®



44-D8834 (LT6-900)	Meridian Transit Level, 22x Magnification	\$194.43
46-D8871 (LT8-300P)	Builders' Transit, 26x Mag. w/ Optical Plummet	\$1,056.56
46-D8872 (LT8-300LP)	Builders' Transit, 26x Mag. w/ Laser Plummet	\$1,102.99
46-D8877 (LT8-300LTU)	Utility Transit, 26x Mag. w/ Optical Plummet	\$1,131.39
46-D8879 (LT8-300LTU-LP)	Utility Transit, 26x Mag. w/ Laser Plummet	\$1,130.66

Horizontal & Vertical Sighting Made Easy

David White SitePro Transits are smooth, easy to operate and come in a variety of telescopic ranges. With both optical and laser plummet models to choose from, these instruments are perfect for virtually any sighting application.



Leica
Geosystems



840381	NA320, 20x AutoLevel w/ 360 Circle	\$235.00
840382	NA324, 24x AutoLevel w/ 360 Circle	\$250.00
840383	NA332, 32x AutoLevel w/ 360 Circle	\$295.00
352036	NA2, 32x (Optional 40x) AutoLvl. w/ Acc.	\$3,300.00
352038	NAK2 Unvsl. AutoLevel w/ Horiz. 360 Circle	\$4,200.00

AL-NIKON-AX-2S	AX-2S, 20x AutoLevel w/ 360 Circle, Plumb Bob	\$295.00
AL-NIKON-AC-2S	AC-2S, 24x AutoLevel w/ 360 Circle, Plumb Bob	\$360.00
AL-NIKON-AP-8	AP-8, 28x AutoLevel w/ 360 Circle, Plumb Bob	\$630.00
AL-NIKON-AS-2	AS-2, 34x AutoLevel w/ 360 Circle, Plumb Bob	\$1,535.00
AL-NIKON-AE-7	AE-7, 30x AutoLevel w/ Plumb Bob	\$1,195.00



NIKON-NE-100	10" Construction Theodolite	\$2,075.00
NIKON-NE-101	7" Construction Theodolite	\$2,250.00
DET-2	2" Construction Theodolite	\$1,195.00



Pre-Owned Equipment

Refurbished. Recalibrated. Ready-to-Work

Shop www.laserinst.com/pre-owned for great deals on construction, surveying & GIS/mapping equipment! All our pre-owned items are inspected & serviced by our factory-trained & certified technicians & come with a 90-day warranty. Ask about extended warranties & special pricing on select items!

www.laserinst.com/pre-owned

(Ver. 12.0)



ChrisNik

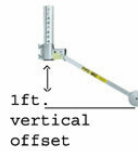

1702PM2 Pipe Invert Measurement Solution w/ Zero & 1ft Vertical Offset \$225.00

Measure Pipe Inverts and Sizes Fast, Easily and Accurately!

PGPRO1812V	12ft, Nylon-Coated, Hook-End Short Tape	\$9.51
PGT1816V	16ft, Nylon-Coated, Hook-End Short Tape	\$13.24
PGT181025V	25ft, Nylon-Coated, Hook-End Short Tape	\$17.05
PGT1825V	16ft, Nylon-Coated, Hook-End Short Tape	\$17.06
PG1025	25ft, Nylon-Coated, Hook-End Short Tape	\$18.57
PGPRO1816V	16ft, Nylon-Coated, Hook-End Short Tape	\$12.98
PGPRO1825	25ft, Nylon-Coated, Hook-End Short Tape	\$20.00
PGPRO1830	30ft, Nylon-Coated, Hook-End Short Tape	\$22.90



OTR18100	100ft, Open-Reel, Fiberglass Long Tape (Inches)	\$23.95
OTR10100	100ft, Open-Reel, Fiberglass Long Tape (10ths)	\$23.95
OTR18200	200ft, Open-Reel, Fiberglass Long Tape (Inches)	\$56.95
OTR10200	200ft, Open-Reel, Fiberglass Long Tape (10ths)	\$59.95
OTR1810300	300ft, Open-Reel, Fiberglass Long Tape (Inches)	\$76.50
OTR10300	300ft, Open-Reel, Fiberglass Long Tape (10ths)	\$69.95

OTRS1810100E	100ft, High-Speed (3x) Long Tape (In./10ths)	\$33.00
OTRS1810200E	200ft, High-Speed (3x) Long Tape (In./10ths)	\$34.95
OTRS1810300E	300ft, High-Speed (3x) Long Tape (In./10ths)	\$56.50



NR10100	100ft, Std. Rewind, Zero Point at End +1ft	\$68.50
NR10100E	100ft, Std. Rewind, Zero Point at Tape End	\$68.50
NR10100H	100ft, Std. Rewind, Hook-End Long Tape	\$54.50
NR10200H	200ft, Std. Rewind, Hook-End Long Tape	\$89.95
NR10200E	200ft, Std. Rewind, Zero Point at Tape End	\$89.95

NR30M	30m, Double-Nylon Coated Long Tape	\$72.50
NRS18M100	100ft, High-Speed, Nylon-Reinforced Long Tape	\$69.00
NRS18M200	200ft, High-Speed, Nylon-Reinforced Long Tape	\$105.50
NRS18300	300ft, High-Speed, Nylon-Reinforced Long Tape	\$144.00



(Ver. 12.0)

Tape Measures & Wheels (Cont'd)



SNR10100H	100ft, Nylon-Coated, Stainless Housing Tape	\$78.50
SNR18100	100ft, Nylon-Coated, Stainless Housing Tape	\$95.95
SNR18200	200ft, Nylon-Coated, Stainless Housing Tape	\$116.50
SNR10300	300ft, Nylon-Coated, Stainless Housing Tape	\$180.50
SNR18300	300ft, Nylon-Coated, Stainless Housing Tape	\$180.50

03Y1276N 1/4" x 100ft Peerless Yellow Clad Tape (ft./in.) **\$270.95**

03Y1276DN 1/4" x 100ft Peerless Chrome Clad Tape (10ths) **\$270.95**

03Y1278N 1/4" x 200ft Peerless Yellow Clad Tape (ft./in.) **\$399.00**

PHV1312D 3/4" x 12ft Engineer Power Tape **\$13.50**

PV1425D 1" x 25ft Engineer Power Tape **\$20.50**

PVH1425D 1" x 33ft Engineer Power Tape **\$28.50**



1066DN 5/8" x 6ft Engineer Wooden Folding Rule **\$24.50**

1066DM 5/8" x 2m Engineer Wooden Rule **\$24.50**

C1278D 1/4" x 200ft Peerless Chrome Clad Tape (10ths) **\$375.00**

MP301 3ft Measuring Wheel (ft./in.) **\$149.95**

RRT12 3ft Measuring Wheel (ft./in.) **\$99.95**

RRT1210 3ft Measuring Wheel (ft./10ths) **\$99.95**

MP401 4ft Measuring Wheel (ft.) **\$175.95**



Rebar & Rebar Caps



Note: Rebar pricing may vary.

ZSE-5815REB	5/8" x 15" Rebar	Call for Pricing
ZSE-5812REB	5/8" x 12" Rebar	Call for Pricing
ZSE-1230REB	1/2" x 30" Rebar	Call for Pricing
ZSE-3430REB	3/4" x 30" Rebar	Call for Pricing

Ask About Local Delivery On Wood & Rebar!

PLM-4-O-100 1/2" Rebar Caps (100Pk) - Orange **\$58.00**

PLM-4-Y-100 1/2" Rebar Caps (100Pk) - Yellow **\$58.00**

PLM-5-O-100 5/8" Rebar Caps (100Pk) - Orange **\$60.00**

PLM-5-Y-100 5/8" Rebar Caps (100Pk) - Yellow **\$60.00**



**Custom
Imprints
Available!**

Marking Paint, Chalk & Lumber Crayons



255	Construction Marking Paint - WHITE	\$44.85
246	Construction Marking Paint - FLO. RED	\$44.85
258	Construction Marking Paint - YELLOW	\$44.85
247	Construction Marking Paint - FLO. ORANGE	\$44.85
249	Construction Marking Paint - FLO. PINK	\$44.85
248	Construction Marking Paint - FLO. GREEN	\$44.85
250	Construction Marking Paint - BLUE	\$44.85
260	Construction Marking Paint - PURPLE	\$44.85

220	Survey Marking Paint - FLO. RED	\$48.50
226	Survey Marking Paint - FLO. YELLOW	\$48.50
222	Survey Marking Paint - FLO. ORANGE	\$48.50
229	Survey Marking Paint - FLO. PINK	\$48.50
224	Survey Marking Paint - FLO. GREEN	\$48.50
227	Survey Marking Paint - FLO. BLUE	\$48.50
245	32" Paint Marking Stick	\$22.00



LCWHITE-BX	Lumber Crayons (Box of 12) - WHITE	\$15.00
LCYELLOW-BX	Lumber Crayons (Box of 12) - YELLOW	\$15.00
LCPINK-BX	Lumber Crayons (Box of 12) - PINK	\$15.00

46061BX	Paint Markers (Box of 12) - WHITE	\$38.95
46062BX	Paint Markers (Box of 12) - YELLOW	\$38.95
46056BX	Paint Markers (Box of 12) - PINK	\$38.95



8B	8oz Marking Chalk - BLUE	\$1.50
105B	5lb Marking Chalk - BLUE	\$8.50
8R	8oz Marking Chalk - RED	\$1.45
105R	5lb Marking Chalk - RED	\$8.25
105GL	5lb Marking Chalk - GLO. LIME	\$15.00
105GO	5lb Marking Chalk - GLO. ORANGE	\$15.00
105W	5lb Marking Chalk - WHITE	\$8.25
105BLACK	5lb Marking Chalk - BLACK	\$10.10
SS3H	Soapstone Chalk	\$4.25

P100	100ft Chalk Line Reel	\$10.50
G110	110ft Chalk Line Reel	\$24.50
G130	130ft Chalk Line Reel	\$39.95
K3XPRO	100ft Chalk Line Reel, 3x1 Rewind	\$19.50



(Ver. 12.0)

Survey Markers, Benchties & Hub Discs



C/M-1.5B	1 1/2" Flat Top, Brass Survey Marker	\$7.85
C/M-2B	2" Flat Top, Brass Survey Marker	\$16.75
19-701	2" (50.8mm) Brass Survey Marker - Flat Top	\$9.00
19-702	2 1/2" (63.5mm) Brass Survey Marker - Flat Top	\$11.00
19-703	3" (76.2mm) Brass Survey Marker - Flat Top	\$11.00
19-705	2" (50.8mm) Brass Survey Marker - Domed Top	\$12.00
19-706	2 1/2" (63.5mm) Brass Survey Marker - Domed Top	\$13.00
19-707	3" (76.2mm) Brass Survey Marker - Domed Top	\$18.00
2700Y	Yellow Benchties	\$65.00
24HUBDISC	Hub Discs (100Pk) w/ 1/8" Hole	\$14.75



ChrisNik

SitePro



Wood Hubs, Flats, Wedges & Lath

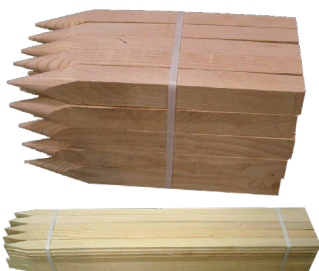

ZSE2209H	2" x 2" x 9" Wood Hubs	Call for Pricing
ZSE2212H	2" x 2" x 12" Wood Hubs	Call for Pricing
ZSE2218	2" x 2" x 18" Wood Hubs	Call for Pricing
ZSE1224F	1" x 2" x 24" Wood Flats	Call for Pricing
ZSE18F	1" x 2" x 18" Wood Flats	Call for Pricing
ZSE36L	1/2" x 1 1/2" x 36" Wood Lath	Call for Pricing
ZSE48L	1/2" x 1 1/2" x 48" Wood Lath	Call for Pricing

**Ask About Local Delivery On Wood & Rebar,
As Well As Additional Options!**

Flagging & Whiskers



TXFLB1000	4" x 5" x 30" Wire Flags (1,000Pk) - BLUE	\$109.21
TXFLLG1100	4" x 5" x 30" Wire Flags (1,000Pk) - GLO. LIME	\$109.21
TXFLYG1400	4" x 5" x 30" Wire Flags (1,000Pk) GLO. YELLOW	\$109.21
TXFLPG1300	4" x 5" x 30" Wire Flags (1,000Pk) GLO. PINK	\$109.21
TXFLOG1200	4" x 5" x 30" Wire Flags (1,000Pk) GLO. ORANGE	\$109.21



16006-10-24	24" Aerial Flagging - HD WHITE	\$61.15
15500-0-48	48" Aerial Target - Bullseye	\$18.30
15000-0-48	48" Aerial Target - Iron Cross	\$18.30

SS.75YBKOG150 Safety Skirt Perimeter Marker **\$16.75**

Consists of 9.25" strips of Orange Glo., nylon-coated PVC sewn into 0.75" x 150ft yellow/black/yellow woven barricade tape.

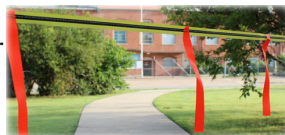

(Ver. 12.0)

Flagging & Whiskers (Cont'd)

TXW1500	Roll Flagging - WHITE	\$18.59
TXR1300	Roll Flagging - RED	\$18.59
TXY1400STD	Roll Flagging - YELLOW	\$18.59
TXG1300	Roll Flagging - GREEN	\$18.59
TXB1000STD	Roll Flagging - BLUE	\$18.59
TXPP1700	Roll Flagging - PURPLE	\$18.59

PRESCO



TXRG1600	Roll Flagging - GLO. RED	\$18.59
TXYG1400	Roll Flagging - GLO. YELLOW	\$18.59
TXOG1200	Roll Flagging - GLO. ORANGE	\$18.59
TXPG1300	Roll Flagging - GLO. PINK	\$18.59
TXLG1100	Roll Flagging - GLO. LIME	\$18.59
TXBG1000	Roll Flagging - GLO. BLUE	\$18.59

SWO	Roll Flagging - WHITE/ORANGE STRIPED	\$23.85
SWB	Roll Flagging - WHITE/BLUE STRIPED	\$23.85
SWR	Roll Flagging - WHITE/RED STRIPED	\$23.85
SYBK	Roll Flagging - BLACK/YELLOW STRIPED	\$23.85
SWBK	Roll Flagging - BLACK/WHITE STRIPED	\$23.85
SOBK	Roll Flagging - BLACK/ORANGE STRIPED	\$23.85
SGBK	Roll Flagging - BLACK/GLO. ORANGE	\$23.85
SPGW	Roll flagging - WHITE/PINK STRIPED	\$23.85

PRESCO



PRESCO		ARW1500	Roll Flagging - ARCTIC GLO. WHITE	\$23.50
		ARRG1600	Roll Flagging - ARCTIC GLO. RED	\$23.50
		ARYG1400	Roll Flagging - ARCTIC GLO. YELLOW	\$23.50
		AROG1200	Roll Flagging - ARCTIC GLO. ORANGE	\$23.50
		ARPG1300	Roll Flagging - ARCTIC GLO. PINK	\$23.50
		ARLG1100	Roll Flagging - ARCTIC GLO. LIME	\$23.50
		ARBG1000	Roll Flagging - ARCTIC GLO. BLUE	\$23.50

WHIS6OG1000	6" Whiskers (1000/Case) - GLO. ORANGE	\$134.54
WHIS6PG1000	6" Whiskers (1000/Case) - GLO. PINK	\$134.54
WHIS6W1000	6" Whiskers (1000/Case) - WHITE	\$134.54
WHIS6Y1000	6" Whiskers (1000/Case) - YELLOW	\$134.54
WHIS6G1000	6" Whiskers (1000/Case) - GREEN	\$134.54
WHIS6B1000	6" Whiskers (1000/Case) - BLUE	\$134.54
WHIS6R1000	6" Whiskers (1000/Case) - RED	\$134.54



PRESCO

(Ver. 12.0)



E64-8X4F	8" x 4" Field Book Filler	\$3.69
E64-8x4S	8" x 4" Economy Field Book	\$4.50
E64-8x4WB	8" x 4" Field Book - Wire Bound	\$4.50
E64-8x4B-I	8" x 4" Field Book - Single	\$7.31
E64-4x4B-I	4" x 4" Field Book - Single	\$7.31
E64-64	Level Book - Single	\$7.31
323	2" Standard, 6-Ring Binder w/ Cover	\$8.49

300F	Rite in the Rain Transit Pattern Book	\$24.82
310F	Rite in the Rain Level Pattern Book	\$24.82
815200	8" x 4" Field Book	\$6.25
815200-(6PK)	8" x 4" Field Book (6Pk)	\$37.40
815260	8" x 4" Field Book	\$6.75
815255	8" x 4" Level Book	\$7.30
815255-(6PK)	8" x 4" Level Book (6Pk)	\$43.80
815230	Engineers Field Book	\$6.75



SOKKIA



seco



Carrying Cases & Bags



915-1004	13.8" L x 9.3" W x 6.2" H Case - YELLOW	\$112.40
915-1001	13.8" L x 9.3" W x 6.2" H Case - BLACK	\$112.40
925-1004	17" L x 11.8" W x 6.4" H Case - YELLOW	\$172.33
940-1004	20" L x 14" W x 8" H Case - YELLOW	\$213.70

NANUK
PROFESSIONAL PROTECTIVE CASES

8098-00-ORG	Spray Can Holster Case	\$13.58
8098-10-ORG	Spray Can Holder w/ Pockets	\$21.63
8143-22-FLY	Cell Phone/GPS Case	\$21.52
8070-00-ORG	Single Prism Bag	\$34.59
8080-00-ORG	Triple Prism Bag	\$36.71
8081-00-ORG	Jumbo Prism Bag	\$49.29
8130-00-ORG	Extra Tall Prism Bag	\$52.45
8082-00-ORG	Super Jumbo Padded Prism Bag	\$57.69
8071-00-ORG	Optical Plummet Tribrach Case	\$37.63



seco



(Ver. 12.0)

Carrying Cases & Bags (Cont'd)



8103-20-ORG	24" Lath Bag w/ Pockets	\$57.70
41BAG36HDL	36" Heavy Duty Lath Bag	\$55.00
8100-20-ORG	36" Lath Bag	\$56.10
41BAG48HDL	48" Heavy Duty Lath Bag	\$63.00
8101-20-ORG	48" Lath Bag	\$62.60

seco ChrisNik

8150-20-ORG	Tripod Bag	\$70.30
8154-11-ORG	Large Tripod Bag	\$80.33
8180-20-ORG	Tripod/Prism Pole Bag	\$53.54
8154-12-ORG	GPS Tripod Bag	\$107.07
8120-30-ORG	Back Pack Total Station Bag	\$277.15
8120-40-ORG	Total Station Ruck Sack	\$296.59



Safety Glasses



ESR-6ST Strobe Safety Glasses - Silver/Smoke **\$8.70**

ESR-12CFSTB Strobe Safety Glasses - Camo/Smoke **\$9.45**

ESE-9MB Sectorlite Safety Glasses - Mirror **\$5.00**



ESE-6ST Flanker Safety Glasses - Smoke **\$6.85**

EFR-6ST Flanker Safety Glasses - Smoke **\$7.60**

ESE-6C Flanker Safety Glasses - Clear **\$6.85**

EFR-6CB Flanker Safety Glasses - Clear Bulk **\$5.65**



EQT-12KST Quest Safety Glasses - Black/Smoke **\$6.85**

EQT-12CFST Quest Safety Glasses - Camo/Smoke **\$7.60**

EQT-12KA Quest Safety Glasses - Black/Amber **\$6.85**



Hard Hats

HBSE-7W Briggs Short Brim Hard Hat - WHITE **\$14.10**

HBSE-7L Briggs Short Brim Hard Hat - YELLOW **\$14.10**



HBFE-7W Briggs Full Brim Hard Hat - WHITE **\$15.15**

HBFE-7L Briggs Full Brim Hard Hat - YELLOW **\$15.15**

HDF-15NG Dax Fiber Resin Full Brim Hard Hat - NATURAL **\$88.00**

HDF-15WG Dax Fiber Resin Full Brim Hard Hat - GLOSS WHITE **\$97.35**

HDFM-17KG Dax Carbon Fiber Full Brim Hard Hat - MATTE BLACK **\$162.25**



Safety Vests



23-750-FL-L	Class 2 Survey Vest, Large, FLO. LIME	\$72.00
23-750-FL-XL	Class 2 Survey Vest, XL, FLO. LIME	\$72.00
23-750-FL-XXL	Class 2 Survey Vest, 2XL, FLO. LIME	\$78.75
8265-42-FLY	Class 2 ANSI Survey Vest, Small, FLO. YELLOW	\$141.38
8265-42-FOR	Class 2 ANSI Survey Vest, Small, FLO. ORANGE	\$141.38
8265-46-FLY	Class 2 ANSI Survey Vest, Medium, FLO. YELLOW	\$141.38
8265-46-FOR	Class 2 ANSI Survey Vest, Medium, FLO. ORANGE	\$141.38
8265-50-FLY	Class 2 ANSI Survey Vest, Large, FLO. YELLOW w/ STRIPE	\$141.38
8265-50-FOR	Class 2 ANSI Survey Vest, Large, FLO. ORANGE w/ STRIPE	\$141.38
8265-54-FLY	Class 2 ANSI Survey Vest, XL, FLO. YELLOW	\$141.38
8265-54-FOR	Class 2 ANSI Survey Vest, XL, FLO. ORANGE	\$141.38
8265-58-FLY	Class 2 ANSI Survey Vest, 2XL, FLO. YELLOW	\$152.29
8265-58-FOR	Class 2 ANSI Survey Vest, 2XL, FLO. ORANGE	\$152.29
8265-62-FLY	Class 2 ANSI Survey Vest, 3XL, FLO. YELLOW w/ STRIPE	\$152.29



Two-Way Radios

RMV2080	VHF 2-Watt, 8-Channel, Non-Display Radio	\$245.00
RMU2080	UHF 2-Watt, 8-Channel, Display Radio	\$290.00
RDV5100	HF 2-5 Watt, 10-Channel, Non-Display Repeater Radio	\$325.00
DTR550	Digital Radio (Up to 150 Contacts (Private/Group))	\$349.00
RDU4100	UHF 2-4 Watt, 10-Channel, Non-Display Repeater Radio	\$360.00



Road Signs & Accessories



36M-MS-OLAH	36" x 36" One Lane Ahead Sign	\$42.95
36M-MS-FAA	36" x 36" Flagger Ahead Sign	\$42.95
36M-MS-SCA	36" x 36" Survey Crew Ahead Sign	\$42.95
48M-MS-WAA	48" x 48" Work Area Ahead Sign	\$50.57
48M-MS-SCA	48" x 48" Survey Crew Ahead Sign	\$50.57
48M-MS-ASIP	48" x 48" Aerial Survey Sign	\$89.00
4026048-EV-HF	48" x 48" Reflective Survey Sign	\$73.40
MS-RIGID-30	Compact Sign Base	\$144.20
4022300	Sign Base w/ Spring & Ext. Legs	\$154.30
PC500-2-A	Flash Magnetic Light - AMBER	\$90.12

(Ver. 12.0)

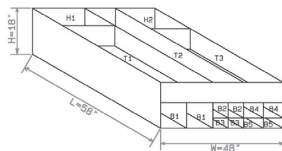

Surveyors! Keep Your Gear Organized!

- Designed Specifically for Surveyors
- Heavy Duty Aluminum Construction
- Easy to Install & Remove
- Store Tripods, Lath, Poles, Instruments Accessories & More!

**Call 412-861-6534
for More Information!**

4858 48" x 58" Aluminum Survey Box (Truck-Specific) **\$1,670.00**

Hand Tools

122-C	12" Brush Hook w/ 36" Curve Handle	\$78.75
17-COLO18-W	18" Colo-Machete w/ Wood Handle	\$10.59
442P-MA22	22" Tempered Steel Machete	\$16.65
17-COLO24-W	24" Colo-Machete w/ Wood Handle	\$11.54
442P-MA24	24" Tempered Steel Machete	\$18.25
17-LS22	22" Leather Machete Sheath	\$15.81
44MA22SHEATH	22" Leather Sheath w/ Belt Loop	\$22.50
17-LS24	24" Leather Machete Sheath	\$19.97
44MA24SHEATH	24" Leather Sheath w/ Belt Loop	\$24.95



4418RT	Red Top Frost Pin	\$26.50
4418GD	Red Top Square Gad	\$32.00
4432DP	Manhole Hook, Diamond Point Tip	\$29.95
4432FH	Manhole Hook, Curved w/ 36" Handle	\$29.95
17-RF48E	48oz Engineer Hammer	\$15.22
17-EWB3-4LB	4lb Drilling/Club Hammer	\$30.00

ChrisNik **SitePro**

GB500	500ft Braided, Nylon Mason Twine - GREEN	\$8.50
OB500	500ft Braided, Nylon Mason Twine - ORANGE	\$8.25
PB500	500ft Braided, Nylon Mason Twine - PINK	\$8.50



Alternative Leveling Solutions



- Single Setup Vertical Range of 40ft Over a 200ft Circle
- Jobsite Rugged Operation of -22°F to +158°F
- Months of Operation on one 9V Battery
- Impact & Water Resistant
- Displays Elevations in Your Preferred Scale
- Included Unipod Lets You Measure While Standing



PRO-2000 ZIPLEVEL PRO-2000

\$899.00

Level Without The Need for Line-of-Sight

No more rods, tripods, sensors, line-of-sight, distance errors, factory calibration or computations. Now, you can measure over any distance or elevation on earth, from paper thickness to the height of a mountain, without error-inducing tabulation or math.

To Learn More or Schedule a Demo, Contact 412-861-6534

(Ver. 12.0)

Leveling Lasers



**CALIBRATED
BEFORE DELIVERY**

The Toughest Laser You Will Ever Own

Great for elevation control across the site, excavations, basic slopes, leveling forms and footers, concrete forms and more!

LL300N	LL300N Leveling Laser	\$752.00
LL300N-8	LL300N w/ HR320 Receiver	\$672.00
LL300N-1	LL300N, Tripod, HL450 & Grade Rod (10ths) KIT	\$850.00
LL300N-2	LL300N, Tripod, HL450 & Grade Rod (in) KIT	\$850.00
LL300S	Spectra Precision LL300S	\$840.00

**Laser Accuracy of +/- 3/32" per 100ft | Self-Leveling of +/- 5 Degrees
1650ft Diameter Range | 90 Hour Battery Life | IP66 Rating
-4°F to 122°F Operating Temperature | Dust & Waterproof**

The Spectra Precision LL500 Setting the Industry Standard for 40 Years!



Get Our 40th Anniversary Commemorative Decal!

The LL500 is the ideal one-person leveling system for a range of applications. Temperature compensation allows you to meet your toughest accuracy requirements in any type of variable environmental conditions.

LL500 Spectra Precision LL500 **\$1,150.00**

**Laser Accuracy of +/- 1/16" per 100ft |
Self-Leveling of +/- 11 Arc Minutes | 1,600ft Diameter Range
175Hr Battery Life | -4°F to 122°F Operating Temperature**



**CALIBRATED
BEFORE DELIVERY**

Grade Lasers



GL412N GL412N Single Grade Laser **\$1,890.00**

GL422N GL422N Dual Grade Laser **\$2,250.00**

**Laser Accuracy of +/- 1/16" per 100ft | 2,600ft Diameter Range
-10% to 15% Grade Range | Grade Accuracy of 1/8" at 100ft
-4°F to 122°F Operating Temperature | IP66 Rating**

GL612N GL612N Single Grade Laser **\$2,195.00**

GL622N GL622N Dual Grade Laser **\$2,550.00**

**Laser Accuracy of +/- 1/16" per 100ft | 2,600ft Diameter Range
+/- 25% Grade Range | IP67 Rating**

Spectra Precision grade lasers with two-way radio remote offer superior grade, level and vertical capabilities. They also feature self-plumb in vertical positions, Grade-Match and PlaneLok.

(Ver. 12.0)



DG613	DG613 Pipe Laser	\$3,995.00
DG613G	DG613G Green-Beam Pipe Laser	\$4,350.00
DG813	DG813 Pipe Laser	\$4,525.00

Working in the Trenches Has Never Been Easier

Compact, rugged and powerful with reduced length for easy setup in tight inverts, the DG613/DG613G/DG813 Pipe Lasers are the new standard.

**Self-Leveling of -12% to +40% | 'Line Alert' Jarring Feature
Line Set/Check Capability | IP68 Rating**



Available Spectra Precision Pipe Laser Accessories Include the Following:



P20	Alkaline Battery Pack (DG511/DG711)	\$80.75
P20B	Alkaline Battery Pack (DG511/DG711)	\$80.75
Q104667	Spectra Precision Battery (DG511/DG711)	\$117.00
P21	Battery Cable - 12v DC w/ Clips	\$93.50
P25	Car Adapter	\$171.00
RC803	Remote Control (DG613/DG813)	\$385.00
RC501	3-Button Remote (DG511/DG711)	\$290.00
RC502	7-Button Remote (DG511/DG711)	\$417.00
956-1	Set of Spare Pipe Laser Elements	\$54.50
956	Pipe Laser Target w/ 2 Elements	\$92.50
1239	Extended Height Vertical Pole Kit	\$245.00
1230	Heavy Duty Invert Plate	\$255.00
1244	T-Bar	\$458.00
929	Manhole Blower	\$517.95
1017	Manhole Mount	\$554.90
SF803	Spot Finder for DG813	\$390.00

Utility Lasers

Working in the Trenches Has Never Been Easier

The Spectra Precision UL633N features total automatic control of all three (X, Y, Z) axes. It's automatic self-leveling in horizontal, vertical and dual grade (X and Y axes) with grade ranges of +/- 25%. This is the laser with enough versatility to fit any application.

UL633N	UL633N Universal Laser	\$3,125.00
--------	------------------------	-------------------

**Fully Auto Up To +/- 25% Grade On X/Y/Z Axes | 2,600ft Diameter Range
490ft Operating Radio Range | Automatic Temperature Compensation**



CALIBRATED BEFORE DELIVERY

All our lasers are checked on our calibration ranges by factory-trained and certified technicians prior to delivery.

(Ver. 12.0)

Interior Lasers



LT20G	LT20G Green-Beam Laser	\$214.50
LT52G	LT52G Green-Beam Laser	\$384.25
LT56	LT56 Laser	\$445.00
LT56-2	LT56 Laser w/ HR220 Receiver	\$516.00
LT58G	LT58G Green-Beam Laser	\$549.00
LP51G	LP51G Green-Beam Laser	\$200.50

HV302G-1 HV302G - **Green-Beam** Laser **\$1,295.00**

The Most Versatile Interior Construction Laser

The automatic self-leveling of the Spectra Precision HV302G Horizontal/Vertical Laser offers exceptional versatility & superior green-beam visibility. A split beam enables plumb point transfer & 90 degree layout.

**Laser Accuracy of +/- 1/16" per 100ft | 250ft Diameter Range
Automatic Horizontal/Vertical Self-Leveling | Grade Matching & PlaneLok
Height of Instrument Alert (Stops Rotating When Jarred)**



Hand Receivers



HL450	HL450 Receiver	\$260.00
HL700	HL700 Receiver	\$350.00
HL750	HL750 Receiver	\$355.00
HL760	HL760 Receiver	\$365.00

HR1220	HR1220 Line/Dot Interior Laser Receiver	\$165.00
HR220	HR220 Receiver	\$144.00
HR320	HR320 Receiver	\$170.00
HR150U	HR150U Green-Beam Receiver	\$148.00
HL760U	HL760U Green-Beam Receiver	\$395.00



NEW!

With the iDig system, you can manage distances, depths & desired slopes. The combination of advanced technologies is unique in the world: no cables, radio communication, simplified installation & solar charging!

The user interface has been designed for excavator operators & can be appreciated by all. A bar graph & LED display guides you in the same field of vision as your bucket & makes the iDig an ideal solution!

Enter a new era of construction & increased the performance of grading & excavating!

Learn More & Request a Demo!
www.laserinst.com/iDig

724-266-1600 | PLI@laserinst.com

Grade Control **Made Easy**

(Ver. 12.0)



The Best Way to Get Good Grade

The CR700 is a machine mounted display receiver used on small grading & excavating equipment as well as a traditional laser receiver mounted to a grade rod or hand held!

CR700 Combination Laser Receiver **\$495.00**

LR30	LR30 Machine Receiver	\$1,270.00
LR50	LR50 Machine Receiver	\$1,620.00
LR60	LR60 Machine Receiver	\$2,380.00



773569 LMR240 Machine Receiver

\$700.00

Leica
Geosystems



LR50W	LR50W Wireless Machine Receiver	\$1,800.00
MM-1	Magnetic Mount for Excavator	\$280.00
DM-20	DM-20, Bolt-On Dozer Mount	\$280.00
LR50WMM	KIT - LR50W, RD20 Remote & Magnetic Mount for Excavator	\$2,195.00
LR50W-DM	KIT - LR50W, RD20 Remote & Dozer Mount	\$2,195.00
LR60W	LR60W Wireless Machine Receiver	\$2,675.00

Laser Lenker Rods



GR1000	Lenker Rod, 10ft	\$210.00
GR1000T	Lenker Rod, 10ft	\$210.00
GR1000I	Lenker Rod, 10ft	\$210.00
GR1000ICF	Lenker Rod, 10ft	\$210.00
GR1450	Lenker Rod, 15ft	\$295.00
GR1450T	Lenker Rod, 15ft	\$295.00
1000-1301	10-15ft Case	\$35.00
1000-1302	10/15ft Case	\$45.00
1000-1026	10ft Rplmt. Tape	\$69.00



B-STORM	Receiver Bracket	\$73.00
B1	Universal Bracket	\$73.00
UB-1	Universal Bracket	\$79.00
F687511-185	Laser Pole, 16ft (ft/10ths)	\$410.00



LASERLINE MFG. INC.



(Ver. 12.0)

Two-Person Layout Packages



Option A: Nikon N w/ Layout Pro Construction Layout Package



HQA46710	Nikon N Series 5" (Includes: x1 Tribrach, x1 Hard Case, x1 Shoulder Strap, x1 Li-Ion Battery, x1 USB Charger, x1 USB Cable, x1 Rain Cover, x1 Lens Cap, x1 Adjustment Pin Tool, x1 Allen Wrench)
ST10-010-001	Spectra Precision ST10 Rugged Tablet
10-5360	Universal Cradle / Pole Clamp
D11145	Adapter, 1/25mm OD to 1 1/4 OD
Training	Training, 1/2 Day On-Site or Office (Within 30-Mile Radius of PLI Locations)

Complete Package: \$8,950.00 +tax

Option B: Nikon K w/ Layout Pro Construction Layout Package



HQA46730	Nikon K Series 5" (Includes: x1 Tribrach, x1 Hard Case, x1 Shoulder Strap, x1 Li-Ion Battery, x1 USB Charger, x1 USB Cable, x1 Rain Cover, x1 Lens Cap, x1 Adjustment Pin Tool, x1 Allen Wrench)
ST10-010-001	Spectra Precision ST10 Rugged Tablet
10-5360	Universal Cradle / Pole Clamp
D11145	Adapter, 1/25mm OD to 1 1/4 OD
Training	Training, 1/2 Day On-Site or Office (Within 30-Mile Radius of PLI Locations)

Complete Package: \$7,825.00 +tax

Included w/ Either Package at NO CHARGE!	Additional Options Available w/ Either Package
6405-01-FOR 25mm Stake Out Prism - Flo. Orange	Training On-Site/Office (\$1,200.00/Day (30mi radius))
5540-10 8.5ft Ultralite Prism Pole	63820-10 Layout Pro Office Software (\$795.00)
01-RHIVIZ20-B Salamander Series Tripod	Warranty Call 724-266-1600 for Details.

0% Financing for 24 Months*! | Terms & Conditions

Through Trimble Financial Services, we offer competitive rates, flexible terms, fast response, as well as great service! There are several advantages to our finance programs: We can help you improve cash flow, it's very flexible & you can get 100% financing. In addition, our leasing & finance are easier & faster than bank financing, & may provide you with tax benefits.** Ask your sales rep. for more info on the tax benefits of financing or leasing.

*Trade-in & rent-to-purchase option not available with this offer

**10% Down payment is required at listed price

***Offers valid through 9/30/21

*Payment listed is before applicable taxes & is subject to credit approval

**\$100.00 Doc Fee due with advance payment

***We recommend you consult your tax advisor for business-specific benefits

(Ver. 12.0)

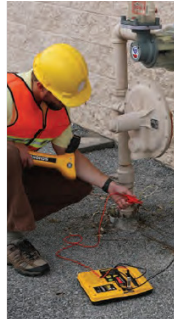

The Most Advanced, Practical, Precise Locators

We carry a range of solutions for magnetic, pipe & cable detection. Available in a range of frequencies & task-based designs, our locators can help tackle any jobs you require. The magnetic locators are typically used to identify static objects at varying depths, from small corner pins to large tanks, while the pipe & cable locators are great for water, gas, cable & other utilities to provide a safe worksite & prevent damage.

Locating Solutions for a Full Range of Industries, Including:

- Surveying & Mapping
- Construction & Excavation
- Water & Sewer
- Roads & Transportation
- Power & Electric
- Oil & Gas Pipelines
- Contract Locating
- Telecommunications & Cable
- Facilities Management & More!

19-202SC Magna-Trak MT202 Magnetic Locator **\$699.00**

798643 DigiCat 550i xf Utility Locator **\$1,360.00**



SCHONSTEDT
INSTRUMENT COMPANY

SPOT	SPOT Magnetic Locator	\$768.00
REX	REX Pipe & Cable Locator	\$2,902.00
MAGGIE	Magnetic Locator	\$850.00
GA-52CX	Model GA-52CX Magnetic Locator	\$901.00
GA-72CD	Model GA-72CD Magnetic Locator	\$1,026.00
GA-92XTD	Model GA-92XTD Magnetic Locator	\$982.00

Model	MAGGIE	SPOT	GA-52Cx	GA-72Cd	GA92-XTd
Major Features	Pistol-Grip Visual Display Highest Accur.	Ultralight-Weight Lowest Cost Highest Accur.	Most Popular Lower Cost Highest Accur.	Most Rugged Most Popular for UXO/Demining	Most Portable Holster Included Extends/Retracts
Audio Output	YES	YES	YES	YES	YES
Visual Output	YES	NO	NO	YES	YES
Battery Indicator	YES	NO	NO	YES	YES
Sensitivity Indicator	YES	NO	NO	YES	YES
Sensitivity Controls	4 Levels	5 Levels	5 Levels	4 Levels	4 Levels
Headphone Compat.	YES	NO	YES	YES	YES

(Ver. 12.0)



BuildingPoint
Ohio Valley



The Experts in Design-Build-Operate Solutions

Precision Laser & Instrument, Inc.'s Build Construction Division
is Now Your Local BuildingPoint Ohio Valley!



www.buildingpointohiovalley.com

BuildingPoint Ohio Valley is your local Trimble Distribution Partner for Trimble Buildings' build construction solutions serving Ohio, Pennsylvania & West Virginia as part of a global network.

Our team of experts is dedicated to modernizing the construction industry, making it more productive, profitable & efficient through cutting-edge hardware, software & services.

We strive to support the Design-Build-Operate lifecycle, to make work simpler for all involved, from Architects, to MEP Professionals, Construction Managers & General Contractors, & give them the power to achieve greater success.

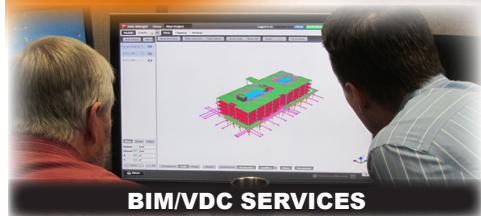

BIM/VDC SERVICES



TRAINING & SUPPORT

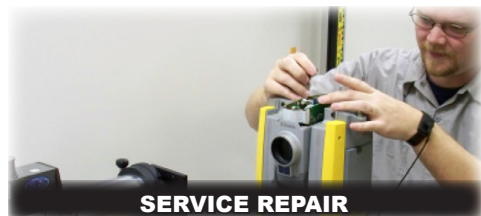

SERVICE REPAIR



RENTALS



Construction Layout

BuildingPoint Ohio Valley's construction layout solutions offer numerous benefits over more traditional methods. Designed with contractors in mind, our technology features simplified setups, one-person operation, easy-to-learn & use software, guided workflows & more, making short work of common building layout & as-built measurement tasks.

Featuring: Trimble SPS986 GNSS, RTS Robotic Total Stations & RPT600 Layout Station



3D Laser Scanning

BuildingPoint Ohio Valley's 3D laser scanning solutions can provide you with accurate, as-built data of existing conditions to create dimensionally-accurate, data-rich 3D models for new construction, renovation, restoration & more.

Featuring: Trimble X7, TX5 & TX8 3D Laser Scanning Systems

Mixed Reality

BuildingPoint Ohio Valley's mixed reality solutions transform complex data into clear visualizations that give context to critical information on the jobsite. Allow for greater understanding on the jobsite at 1:1 scale to make work safer, QA/QC easier & both errors & wasteful change orders minimized. Positioned with high-accuracy GNSS, it's now easy to view spatial relationships more precisely to identify & mitigate structural, mechanical & plumbing (MEP) clashes more effectively.

Featuring: Trimble SiteVision & XR10 w/ HoloLens 2



Construction Software

BuildingPoint Ohio Valley's 3D construction software unifies our Trimble hardware solutions & provides a clean, consistent interface, enhancing communication & collaboration across projects, field to office, in real-time. With job-specific workflows, built-in functions & reporting, it increases accuracy, productivity & ultimately profitability.

Featuring: Trimble T100 & FZ-M1 Rugged Tablets

925-1001 17"Lx11.8"Wx6.4"H Hardcase **\$172.33**

4852-16 Heavy Duty Round Column Clamp **\$477.35**

4852-18 Heavy Duty Square (I-Beam) Column Clamp **\$530.40**



90553-PL Tri-Max Dual-Clamp Tripod **\$341.00**

58020002-FTG Trimble 360 Prism w/ Height Adapter **\$1,195.00**

03-3600 360 Degree Robotic Prism System **\$465.00**

43169-00 2m Carbon Range Pole w/ Bipod **\$535.00**

120531-GEO T100 Pole Bracket (Medium Length) **\$549.00**

122906-GEO T100 Pole Bracket (Long Length) **\$575.00**

52000-32-FTG FZ-M1 Pole Bracket **\$344.74**



The Trimble R12i GNSS System: A New Angle of Productivity

The Trimble R12i delivers unmatched GNSS performance, speed & accuracy to boost your productivity like never before. With improved performance in challenging GNSS conditions & a robust IMU-based tilt compensation that lets you forget about leveling the pole, you'll get more done faster than you thought possible.

- ProPoint GNSS processing
- xFill correction outage technology
- CenterPoint RTX corrections tech.
- Optimized for Trimble Access SW
- Cellular, Bluetooth & Wi-Fi
- All-day battery w/ indicator
- 672 Channel solution w/ Trimble 360 satellite tracking
- Support for RTK-level precision
- SurePoint tilt compensation for precise positions
- Android & iOS platform support
- IP67 Rating & ergonomic form factor
- 6GB internal memory

Call for Quotes & Free Demos at 724-266-1600 or PLI@laserinst.com

The Trimble R8s GNSS System: Configured Today, Scalable Tomorrow

The Trimble R8s gives you the features & benefits you need in one, flexible, scalable system, so you can build a solution tailored to your job. As your requirements change, it can adapt.

- One configurable receiver that's scalable for all needs
- Available in post-processing, base only, rover only or base & rover configurations
- Advanced satellite tracking with Trimble 360 technology
- Maxwell 6 chips with 440 channels
- Trimble Access & Trimble Business Center Field & Office Software

Call for Quotes & Free Demos at 724-266-1600 or PLI@laserinst.com



SPECTRA®
GEOSPATIAL

The Spectra Geospatial SP85 GNSS System: Unmatched Connectivity

The SP85 is a next-generation GNSS receiver that combines decades of GNSS RTK technology with revolutionary GNSS processing.

- Patented Z-Blade technology
- 600-Channel 6G ASIC
- L-band satellite capable GNSS
- 3.5G Cellular modem
- SMS & email alerts
- Backup RTK
- eLevel technology
- Wi-Fi communication
- Anti-theft technology
- RTK bridge
- RTX corrections

Call for Quotes & Free Demos at 724-266-1600 or PLI@laserinst.com

The Spectra Geospatial SP60 GNSS System: Simply Versatile

The SP60 offers a high level of flexibility to cover any survey demand from simple post-processing, through standard UHF or unique long-range Bluetooth base & rover systems, to sophisticated RTK & CenterPoint RTX capable rover solutions.

- Extended survey scalability
- Z-Blade GNSS-centric
- Internal TRx UHF radio
- New 240-channel 6G ASIC
- CenterPoint RTX capable rover
- Long range Bluetooth

Call for Quotes & Free Demos at 724-266-1600 or PLI@laserinst.com



SPECTRA®
GEOSPATIAL

(Ver. 12.0)



The Trimble SX12 3D Scanning Robotic Total Station: Revolutionary

The Trimble SX12 is the industry's most innovative solution for surveying, engineering & 3D scanning professionals, all in one, high-precision instrument.

- High-accuracy total station & 3D scan data
 - 1" Angular accuracy
 - 1.5mm scan range noise at 200m
 - 14mm diameter EDM laser spot at 100m
- Quick data capture, even at long ranges
 - 26.6 kHz scan measurement rate, up to 600m
 - 1.6s total station measuring time in prism mode, 1.2s in DR mode
- Vivid, eye-safe laser pointer (3mm Diameter laser pointer spot at 50m)
- Simple navigation & documentation with Trimble VISION camera system (x3 Calibrated cameras)



Call for Quotes & Free Demos at 724-266-1600 or PLI@laserinst.com



The Trimble S5 Robotic Total Station: A High-Accuracy Workhorse

Built on proven technologies, the Trimble S-Series S5 Robotic Total Station is the no nonsense workhorse that efficiently & dependably performs with the highest accuracy.

- Everything you need to perform survey campaigns
- Trimble DR Plus EDM ■ Trimble L2P real-time location information
- Intuitive Trimble Access & Trimble Business Center software workflows
- Available in 1", 2", 3" & 5" angle accuracies

Call for Quotes & Free Demos at 724-266-1600 or PLI@laserinst.com

The Trimble S7 Robotic Total Station: Powerful & Simple

The Trimble S-Series S7 is the system for efficient surveying, allowing you to adapt to any situation, with features that allow you to collect accurate data faster than ever before.

- Surveying, imaging & scanning in one, powerful solution
- Trimble VISION technology for video robotic control, scene documentation & photogrammetry
- Trimble L2P real-time location information ■ Trimble DR Plus for long range & accuracy
- Trimble Access & Trimble Business Center Field & Office Software
- Available in 1", 2", 3" & 5" angle accuracies

Call for Quotes & Free Demos at 724-266-1600 or PLI@laserinst.com



The Trimble S9/S9HP Robotic Total Stations: High-Performance

Combining top technologies & accuracies, the Trimble S-Series S9 Robotic Total Stations are your go-to for monitoring, tunneling, or any other high-demand survey or engineering task.

- Trimble DR Plus or HP EDM for optimal speed, accuracy & reliability
- Optional Trimble VISION & SureScan technology
- Intuitive Trimble Access & Trimble Business Center software workflows
- Trimble 4D Control for monitoring management
- Available in 0.5" or 1" angle accuracies

Call for Quotes & Free Demos at 724-266-1600 or PLI@laserinst.com



The Spectra Geospatial FOCUS 35 Robotic Total Station

The FOCUS 35 is a productive, reliable & affordable robotic total station that moves the power of the observer from the instrument to the range pole.

- StepDrive motion technology
- SurveyPro software onboard
- Long-range, reflectorless
- GeoLock GPS-assist tech.
- L-range Bluetooth on LockNGo
- LockNGo tracking technology
- High-precision prism measurements
- PIN code security locking system
- Available RX models with ext. operation, dual-bat.
- Available in 1", 2", 3" & 5" angle accuracies

Call for Quotes & Free Demos at 724-266-1600 or PLI@laserinst.com



Mechanical Total Stations

The Nikon N Series Mechanical Total Stations: Advanced & Innovative

The Nikon N series offer advanced EDM in an innovative package, including flexible charging & connectivity options, with both prism and reflectorless EDM modes.

- Prism & reflectorless
- Phone app for easy data transfer
- USB battery charger
- Fast, accurate EDM
- NFC simplifies bluetooth pairing
- Available in 2" & 5" angle accuracies

5" Model | P/N: HQA46710 | PLI Price: \$4,875.00

2" Model | P/N: HQA46700 | PLI Price: \$5,995.00



The Nikon K Series Mechanical Total Stations: Advanced & Innovative

The Nikon K series offer advanced EDM in an innovative package, including flexible charging & connectivity options, allowing you to easily transfer data between the field & office.

- Economical & practical
- Phone App for easy data transfer
- USB battery charger
- Fast, accurate EDM
- NFC simplifies bluetooth pairing
- Available in 2" & 5" angle accuracies

5" Model | P/N: HQA46730 | PLI Price: \$3,710.00

2" Model | P/N: HQA46720 | PLI Price: \$4,500.00

The Nikon XF Mechanical Total Station: A Total Station for Everyone

The Nikon XF is packed with features that make survey work easier & faster. Superior Nikon optics give crisp, bright sightings, even in low-light conditions.

- Choice of EDM
- Dual, color touchscreens
- PIN security
- Hot-swappable batteries
- Survey Pro & Layout Pro software onboard
- Optional L2P asset protection
- Superior Nikon optics
- 1", 2", 3" & 5" angle accuracies

5" Model | P/N: HNA40500 | PLI Price: \$10,350.00

3" Model | P/N: HNA40300 | PLI Price: \$11,250.00



The Nikon XS Mechanical Total Station: Built Tough for All Occassions

The Nikon XS is compact, lightweight & easy to setup. Its onboard software ensures smooth workflows from field to office, empowering you to get more done, everyday.

- Autofocus
- Fast, powerful EDM
- Nikon onboard software
- Dual-face displays
- PIN security
- Available in 1", 2", 3" & 5" angle accuracies

3" Model | P/N: HNA20300 | PLI Price: \$9,500.00

2" Model | P/N: HNA20200 | PLI Price: \$10,350.00

(Ver. 12.0)

Survey Total Station Accessories

TRB-3	Empire 7.4v Lithium Battery	\$85.90
73840019	0.18m, Hirose 6-Pin to USB or Flash Card Cable	\$65.00
99511-30	Trimble Li-Ion Battery, 10.8v, S-Series	\$304.00
58128001	360 Degree Prism with Height Adapter	\$1,295.00
MT1000	Multi-Track Target w/ 7.4v Li-Ion Battery	\$2,750.00
58050019	External Radio, 2.4GHz, Global	\$1,995.00
101070-00-01	Dual Battery Charger w/ Power Supply	\$600.00



Trimble
Authorized Distribution Partner



73841019	0.18m, Hirose 6-Pin to USB or Flash Card	\$65.00
73840019	2.5m, Hirose 6-Pin to USB	\$50.00
572202326	3.0m, Hirose 6-Pin to PC USB	\$80.00
53009012	Coiled, External Radio, Hirose 12-Pin to DB9	\$85.00
92670-10	Li-Ion Battery, 7.4v	\$120.00
53002021	2.5m, Hirose 6-Pin to DB9 RS232	\$194.25

Survey GNSS Receiver Accessories

89844-00	R10/R12 Vehicle Adapt. for Dual-Bat. Charger	\$45.00
89854-00	R10/R12 UHF Radio Antenna	\$60.00
89845-00	R10/R12 Quick Release Adapter, 0.05m	\$275.00
89840-00	R10/R12/R8 Rechargeable Battery, 7.4v	\$174.50
89841-00	R10/R12/R8 Dual-Bat. Charger	\$750.00
44085-46-SUR	R8 Antenna, 5" Whip, 410-470MHz Radio	\$60.00
51871-50-70	5DB 450-470MHz Whip Antenna	\$141.00
92670-10	Li-Ion Battery, 7.4v	\$120.00
89851-00	R8 Serial Data Cable (7P Lemo to DB9)	\$145.00
TRB-3	Empire 7.4v Lithium Battery	\$85.90



Trimble
Authorized Distribution Partner

Instrument Radio Accessories

51871-50-70	TDL Radio Antenna, 0DB-5Db Whip, 450-470MHz	\$141.00
44482-00	TDL Radio Antenna Mast Kit	\$240.00
66656-10	TDL Cable - TDL450/HPB450 (0S/1S Lemo; SAE)	\$250.00
74450-50-70	TDL 450 5db gain Antenna Kit w/ Case	\$331.00
74450-14	TDL 450H Field Battery/Charger Kit	\$406.00



Trimble
Authorized Distribution Partner



Trimble T100

Industry-leading power management & a large battery with fast-charge, reducing downtime.

NEW!



- 10" Touchscreen
- Windows 10 OS & Apps
- Powerful i5 Processor
- Support for EM120 2.4 GHz Module

Quotes & Free Demos | 724-266-1600 | PLI@laserinst.com



Trimble TSC5

- 5" Touchscreen
- Backlit, alphanumeric keypad
- Android 10 operating system
- Google Mobile Services
- IP65 Rating

Quotes & Free Demos
724-266-1600 or PLI@laserinst.com

Trimble TSC7

- 7" Touchscreen
- Backlit, alphanumeric keypad
- Windows 10 operating system
- 8GB RAM, 64GB internal memory
- Intel Pentium processing power

Quotes & Free Demos
724-266-1600 or PLI@laserinst.com



Ranger 7

- 7" Touchscreen
- Backlit, alphanumeric keypad
- Windows 10 operating system
- SurveyPro or Layout Pro software
- Dual hot-swappable batteries

Survey Pro Model | P/N: RG7-S02-001
PLI Price: \$5,100.00

Ranger 3

- 4.2" Touchscreen
- 30Hr+ Rechargeable battery
- Integrated Bluetooth, Wi-Fi, GPS
- SDHC & USB
- IP67 Rating

Survey Pro Model | P/N: RG3-P31-002
PLI Price: \$3,699.00



SP20

114819-00	Meter	\$3,495.00
114819-01	Sub-Meter	\$4,995.00
114819-02	Decimeter	\$6,595.00
114819-03	Centimeter	\$8,595.00
115875-01	Decimeter Option	\$3,100.00
115876-01	Centimeter Option	\$5,100.00

ST10

- 10.1" Touchscreen
- 128GB Storage
- 4G Data modem
- Optional, 2.4GHz radio module
- Windows 10 operating system

Quotes & Free Demos
724-266-1600 or PLI@laserinst.com



Data Controller Accessories

121351-01-1	TSC5/7 Hand Strap	\$20.00
82755-00	TSC3 Hand Strap	\$18.00
121344-01-1	TSC5/7 Shoulder Sling	\$25.00
121986-01-GEO	TSC5/7 Carry Case / Pouch	\$50.00
121354-01	TSC7 Carry Case Shoulder Bag	\$60.00
121355-01-1	TSC7 Stylus w/ Tether	\$46.00
82754-00	TSC3 Stylus Pen Kit	\$25.00
115896-GEO	TSC5 Screen Protector (10 Pack)	\$250.00
121340-01-1	TSC7 Screen Protector	\$67.00
82756-00	TSC3 Screen Protectors	\$21.00



(Ver. 12.0)



121330-01-1	TSC7 USB I/O Boot	\$199.00
121330-02-1	TSC7 Serial I/O Boot	\$199.00

121341-00-1	TSC7 AC Adapter w/ Int. Cord	\$115.00
121341-07-1	TSC7 AC Adapter w/ CHN Cord	\$115.00
104980-01-1	TSC7 12v Vehicle Adapter	\$204.00
82761-00	TSC7 Data Cable, 1.0m (DB9)	\$25.00
121921-GEO	Int. AC Power Adapt. Charg. Kit	\$350.00
114955-GEO	USB Type-A to USB Type-C	\$150.00
121345-01-1	TSC5 Desktop Hub	\$220.00
121718-BLK-GEO	11-32v DC Vehicle Charger	\$199.00
120532-BLK-GEO	USB 3.1 USB-C to USB-A	\$25.00
82752-00	TSC3 Int. Power Supply Kit	\$114.00
82753-00	TSC3 Vehicle Charging Cable	\$149.00



121320-01-1	TSC7 Rechargeable Battery 2-Pack	\$216.00
121343-01-1	TSC7 External Battery Charger	\$299.00
121348-01-1	TSC7 Ext. Bat. Charger w/ Int. Cord	\$320.00
121358-01-1	TSC7 Ext. Bat. Charg. w/ Int. Cord., 2-Pack	\$445.00
82750-00	TSC3 Rechargeable Battery	\$133.00

110238-00-1	EM120 2.4GHz Module	\$1,500.00
115189-GEO	EM120 2.4GHz Antenna	\$150.00
82766-00	TSC3 Antenna for 2.4GHz Radio Module	\$38.00
110255-00-01	EM110 1D/2D Barcode Imager	\$599.00
110236-00-1	EM111 1D/2D & UHF 902-928MHz RFID	\$1,199.00
110221-00-1	EM100 GNSS Receiver	\$2,500.00



121952-01-GEO	TSC5/7 Pole Mount Bracket	\$65.00
121951-01-GEO	TSC5/7 Quick Release Pole Clamp	\$185.00
121349-01-1	TSC7 Pole Mount	\$221.00
10-52139	TSC7 Mounting Bracket	\$131.10
5196-22	TSC7 Tripod Bracket	\$133.85
82759-00	TSC3 Tripod Bracket	\$45.00
82758-00	TSC3 Range Pole Bracket	\$164.00
5200-150	TSC3 Pole Claw Clamp	\$72.97
5200-065	TSC3 Claw Cradle	\$79.70

82756-00	Ranger 3 Screen Protector	\$21.00
121355-01-2	Ranger 7 Stylus w/ Tether	\$46.00
67501-04	Ranger 3 Stylus Pen Kit	\$34.00



Data Controller Accessories (Cont'd)



121341-00-1	Ranger 7 AC Adapter w/ Int. Cord	\$115.00		
82752-00	Ranger 3 Int. Power Supply Kit	\$114.00		
104980-01-2	Ranger 7 12v Vehicle Adapter	\$204.00		
82753-00	Ranger 3 12v Vehicle Charging Cable	\$149.00		
				
	121320-01-2	Ranger 7 Rechargeable Battery 2-Pack	\$200.00	
	121348-01-1	Ranger 7 Ext. Bat. Charger w/ Int. Cord	\$320.00	
	82750-00	Ranger 3 Rechargeable Battery w/ Door	\$133.00	
121349-01-1	Ranger 7 Pole Mount	\$221.00		
5196-18	Ranger 3 Tripod Hook	\$29.47		
67501-08	Ranger 3 Range Pole Bracket	\$171.00		
				
	121330-01-1	Ranger 7 USB/Serial I/O Module	\$199.00	
	121330-02-1	Ranger 7 USB I/O Boot	\$199.00	
	110238-00-1	EM120 2.4GHz Module	\$1,500.00	
114125	T10 Shoulder Strap	\$19.00		
114109	T10 Screen Protector (Single)	\$20.00		
114124	T10 Carrying Case	\$120.00		
114116	T10 Keyboard w/ Trackpad	\$119.00		
114121	T10 Pole Mount w/ Quick Release	\$576.00		
	114120	T10 AC Adapter w/ Power Cord	\$34.00	
	114113	T10 Battery Charger Kit	\$199.00	
	114111	T10 Battery Pack, Li-Ion	\$347.00	
	114114	T10 Group Battery Charger	\$499.00	
	114119	T10 Office Docking Station	\$229.00	
120516-BLK-GEO	T100 Screen Protector	\$40.00		
120524-BLK-GEO	T100 Stylus & Tether	\$70.00		
122906-BLK-GEO	T100 Pole Bracket (Long)	\$575.00		
120531-GEO	T100 Pole Bracket (Med)	\$549.00		
107727-01-BLK-GEO	T100 Carrying Case	\$125.00		
121427-BLK-GEO	T100 Desk Stand	\$99.00		
123247-BLK-GEO	T100 Mounting Plate	\$99.00		
				
	124341-BLK-GEO	T100 AC Adapter Kit	\$75.00	
	121718-FTG	T100 USB C Vehicle Chgr.	\$199.00	
	120532-BLK-GEO	T100 USB C to A Adapter	\$25.00	

Ver. 12.0

(Ver. 12.0)

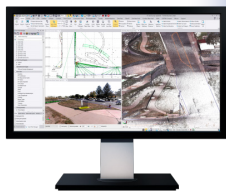

Trimble Business Center: The Leading Office Software for Surveyors

Trimble Business Center (TBC) has field-to-finish survey CAD software, helping surveyors deliver high-accuracy GNSS & CAD data, & leverage full traceability over the project.

- Import any geospatial data
- Survey quality reports
- Autodrafting with feature codes
- GNSS baseline processing
- Level adjustments
- Network adjustments
- Surface & corridor design
- Automatic error flagging
- QA/QC routines
- Geospatial project management
- Total station editor
- Traverse adjustments
- Point cloud tools
- Dynamic project/drawing updates

Call for Quotes & Free Demos at 724-266-1600 or PLI@laserinst.com

Trimble Access: Streamline Your Everyday Workflows

Trimble Access is designed to support your daily survey field work, including topographical surveys, staking, control & more, in a familiar, easy-to-use interface.

- One-tap feature coding
- Graphical staking of points, lines, arcs & alignments from active maps
- Integrated surveying technology combining optical, scanning & GNSS data plus images
- Powerful COGO routines

Call for Quotes & Free Demos at 724-266-1600 or PLI@laserinst.com

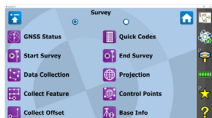

SPECTRA[®]
GEOSPATIAL

Spectra Geospatial Survey Pro: Comprehensive Survey Software

Survey Pro provides you with a complete set of capabilities for all your survey projects. With streamlined workflows & data transfer, it's your go-to field survey solution.

- Full support for mechanical & robotic total stations, as well as GNSS & digital levels
- Complete feature set including data collection with features & attributes, staking routines of all times, comprehensive road layout, DTM support & more
- Dynamic map displays with support for active background maps
- Full support for surveying workflows & techniques

Call for Quotes & Free Demos at 724-266-1600 or PLI@laserinst.com

Spectra Geospatial Survey Office: Field-to-Finish with Confidence

Survey Office is ideal for processing & analyzing GPS/GNSS & optical survey data recorded in the field & exporting it to a design package.

- Easy data management
- Fast & powerful processing
- CAD command line
- Tunneling workflows
- Quality assurance
- Complete survey project control
- Point feature extraction
- Scanning, surface tools & more!

Call for Quotes & Free Demos at 724-266-1600 or PLI@laserinst.com



SPECTRA[®]
GEOSPATIAL

Introducing Trimble Protected PLUS+ for Survey Equipment!

Trimble Protected PLUS+ Features:

Hardware (GNSS Antennas, Control Units, GNSS Receiver Handhelds, Levels, Radios, Tablets & Total Stations)

- Sold in 1-year increments
- Includes protection against hardware defects
- No deductibles, ever!
- Firmware updates
- Transferable ownership (serial numbers)
- Parts & labor coverage

Software & Firmware (Control Units, GNSS Receiver Handhelds, Tablets & Total Stations)

- Bug fixes & minor updates
- Enhancements
- AccessSync, cloud-based file transfer service

Total Station Coverage includes one inspect-clean-calibrate per year for each year of ext. warranty coverage purchased! Purchase a plan through PLI & any equipment under warranty will be covered by a FREE rental during service!

(Ver. 12.0)

Verified Accuracy in Real-Time with VRS

- Instant access to real-time kinematic (RTK) corrections
- Centimeter-accurate corrections tailored to your geographic location
- Built-in redundancy to ensure connectivity, consistency & quality
- Cost-effective & simple to use
- Professionally managed & secure

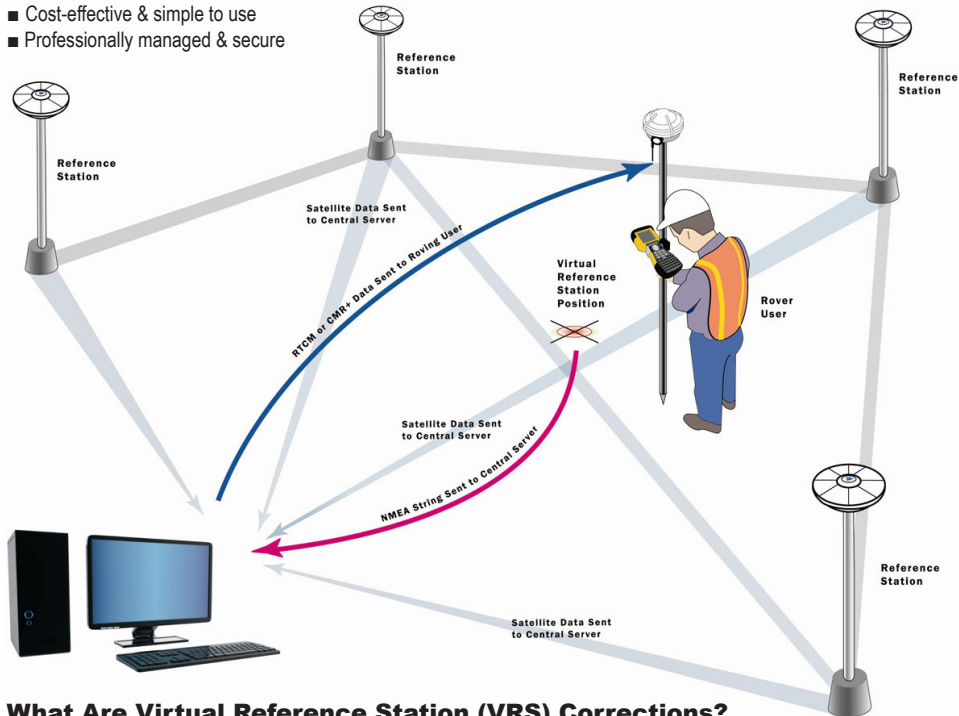

What Are Virtual Reference Station (VRS) Corrections?

A VRS system is one option for providing real-time differential correction to a GNSS receiver. It is the most commonly used technology behind most network correction services worldwide.

Corrections are necessary to eliminate errors & improve the accuracy of GNSS positions in collected data. VRS corrections are available from a variety of public & commercial services.

VRS networks & subscription services provide dual-frequency (L1/L2) real-time differential GPS (DGPS) & in many cases DGNSS (GPS & GLONASS) for accuracy as data is collected.

A VRS service uses data from several (permanent) reference stations to compute corrections that are generally more accurate than corrections from a single reference station. Corrections are then broadcast over the internet.

Why Do I Need VRS Corrections?

The use of VRS helps ensure the accuracy of GNSS data, independent of the distance to the nearest reference station.

Aren't VRS Corrections Just for Surveyors?

The need for reliable & accurate positioning is not limited to surveying! Today, a variety of industries including electric & gas utilities, water & wastewater services, as well as land management projects require mapping products that provide decimeter or better positioning accuracy in real-time.

Local VRS/Real-Time Network Solutions:

(Please Contact Your Local PLI Rep or Store for More Information)



(Ver. 12.0)



HyDrone USV Solution

The HyDrone is a hand-portable, remotely controlled catamaran platform developed for bathymetric survey applications. Working in conjunction with the HydroLite-TM portable echosounder kit, the HyDrone accomplishes the same results as more expensive hydrographic surveying systems.

Its lightweight, wide profile & watertight construction provide stability, ruggedness & portability. This solution is manufactured from high-quality marine components & easily disassembles for transport.

Work difficult environments including mines, sewage treatment plants, contaminated lakes, harbors & rivers. Remote control access of the survey boat is easy using a high-power remote control system that offers up to 2km range with a survey endurance of over four miles on a single battery pack.

Scope of Supply:

- (x2) 12m Catamaran pontoon hulls
- (x2) 12V DC Shrouded thrusters
- 12V Battery bank & charger
- 1 Year standard warranty

- Cross frame
- Handheld remote control unit
- Custom-fit portable shipping case
- Lifetime support

Optional:

- Sound velocity profiler (SVP)
- Radio telemetry
- HYPACK software
- AutoNAV AutoPilot Module with Mission Planner App

- RTK GPS
- Side scan sonar module
- HydroLite-TM



HydroLite-TM Echosounder Kit

The HydroLite-TM should be included in every surveying & engineering firm's standard equipment kit for hydrographic surveying. Developed to meet the requirements of the U.S. Army Tactical Dive Teams, the rugged, wireless HydroLite-TM looks & feels like your traditional survey instrument. It quickly measures & logs depths more accurately than standard systems, making fast work of ponds, rivers, lakes & more!

Key Features:

- Portable, integrated solution
- Adaptable to any vessel
- Wireless data transfer
- Meets IP65 standards
- Quickly export xyz data

Scope of Supply:

- Sonarmite echosounder kit
- Hydrolite boat mount/pole kit
- Rugged shipping case
- User/training manual
- 1-Year support & warranty

Specifications:

- Frequency of 200KHz
- Beam width: 4°
- Ping rate: 6Hz
- Depth accuracy: 1cm/0.1%
- Output: NMEA, ASCII, Quality
- Range: 0.3m-75m

Optional:

- Coast Guard beacon receiver
- PC Data acquisition
- Digital bar check
- Tide gauge



(Ver. 12.0)

Handheld GIS Data Controllers



Trimble TDC150

- Integrated GNSS
- Meter to cm
- 5.3" Multi-touch display
- Qualcomm processor w/ 2GB RAM
- 16GB Storage
- MIL-STD-810 & IP67 ratings

Quotes & Free Demos
724-266-1600 or PLI@laserinst.com



Trimble TDC600

- 6" Touchscreen display
- Qualcomm processor w/ 4GB RAM
- 64GB Storage
- 8GB RAM, 64GB internal memory
- Integrated GNSS
- 4G LTE, Wi-Fi & Bluetooth

Quotes & Free Demos
724-266-1600 or PLI@laserinst.com



GNSS Receivers



Trimble R1

- Compact & cable-free w/ internal antenna
- Flexibility to choose your data collection device
- Work with Trimble handhelds or consumer-grade smart devices

Quotes & Free Demos
724-266-1600 or PLI@laserinst.com



Trimble R2

- Sub-meter to cm accuracies
- Easy data collection by pairing w/ smartphones, tablets, or Trimble handhelds using Trimble software
- Multiple constellations / corrections
- Integrated antenna

Quotes & Free Demos
724-266-1600 or PLI@laserinst.com



GIS Software Solutions



Trimble TerraFlex

- Fast, efficient data collection using customizable, digital forms
- Direct integration w/ ESRI
- Multiple device support
- Easy coordinate system support

Quotes & Free Demos
724-266-1600 or PLI@laserinst.com



Trimble Positions

- Enables high-accuracy GNSS in field collection workflows
- Real-time & post-processed
- GIS data field & office sync
- Stores features & metadata

Quotes & Free Demos
724-266-1600 or PLI@laserinst.com



Positioning Services

Trimble Catalyst

- Positioning on Android smartphones or tablets
- 1 Meter, sub-meter, decimeter or precision subscriptions
- Trimble & 3rd party apps
- Several mounting options for Trimble Catalyst DA1 Antenna
- Automatic datum handling via Trimble Corrections Hub

Quotes & Free Demos | 724-266-1600 | PLI@laserinst.com



GIS Technology "Jump Start" Programs

Our GIS Jump Starts are Perfect for Those Who Want To:

- Take their existing GIS to the field
- Rapidly deploy mobile GIS solutions
- Add high-accuracy location info to existing workflows
- Eliminate paper workflows
- Migrate seamlessly from Trimble TerraSync & Esri Arcpad!

Learn More: 724-266-1600 | PLI@laserinst.com



102016-01	R1 Belt Pouch	\$35.00
102015-01	R1 Pole Mount Pouch	\$35.00
102017-15	R1 External Antenna	\$39.00



101071-00-01	R2 Power Supply & Cord for Dual Bat. Charger	\$95.00
92670-10	R2 Li-Ion, 2.6Ah, 7.4v Battery	\$120.00
39870	R2 Backpack	\$175.00
101070-00-01	R2 Dual Battery Charger w/ Power Supply	\$600.00



93773-03	Geo 6000 / 7 Series Hand Strap	\$15.00
88006-13	Geo 6000 / 7 Series Hand Strap Kit	\$20.00
88055-13	Geo 6000 / 7 Series Replacement Stylus Kit	\$20.00
93601-02	Geo 6000 / 7 Series Antiglare Screen Protector	\$10.00
93598-01	Geo 7 Series Soft Pouch	\$40.00



88015-00	Geo 6000 / 7 Series USB Data Cable	\$15.00
88049-03	Geo 6000 / 7 Series USB to Serial Cable	\$45.00
88014-00	Geo 6000 / 7 AC Power w/ International Adapter	\$50.00
88056-00	Geo 6000 / 7 Series 12v DC Power Supply	\$50.00
70800-15	Geo 6000 / 7 Ext. Antenna Cable	\$70.00
88004-04	Geo 6000 / 7 Series Li-Ion Battery Pack	\$195.00



93599-00	Geo 7 Series Bracket	\$135.00
94916-00	Geo 7 Series Monopole Kit	\$495.00
93879-00	Geo 7 Series Rangefinder Module	\$1,195.00



50643-1.5M	Hurricane / Zephyr Geo Ant. Cable, 1.5M	\$113.25
50463-3M	Hurricane / Zephyr Geo Ant. Cable, 1.5M	\$130.75
50643-5M	Hurricane / Zephyr Geo Ant. Cable, 5M	\$145.00



GIS Technology "Support Now" Program

- 12 or 24-Month unlimited tech support* for GIS HW & SW
 - Toll-free # & email for in-house support specialists
 - Answers within 1-2 business hours
 - Email notification 60 days prior to expiration
- *Includes support for GIS solutions such as Esri Collector & Survey123 when partnered with Trimble Solutions

Learn More: 724-266-1600 | PLI@laserinst.com

**Local Pick-Up
& Delivery!**



**Precision Laser
& Instrument, Inc.**
www.laserinst.com



SHOP ONLINE!
WWW.LASERINST.COM

Construction • Surveying • GIS

Sales • Service • Rentals • Training • Support



A Dedicated Business Partner & One-Stop Shop

Precision Laser & Instrument, Inc. is an Authorized Distribution Partner of Trimble equipment and accessories.

Our company provides comprehensive positioning solutions for the Construction, Surveying and GIS/Mapping industries through sales, service repair, rentals, training and technical support of top-quality laser, optical and positioning equipment, as well as equipment accessories and field supplies.

Our Partners



CST/berger

IKESON

Leica
Geosystems

PRESCO

SCHONSTEDT
INSTRUMENT COMPANY

S&CO

SURFSURFACE INSTRUMENTS, INC.
PRECISELY MADE IN THE USA

AERVOE

We're Your Local Positioning Solutions Provider!

Pittsburgh, PA (HQ): 85 11th Street | Ambridge, PA 15003 | Ph: 724-266-1600 | Fax: 724-266-8161

Columbus, OH

372 Morrison Rd., Ste. D
Columbus, OH 43213
Ph: 614-759-1000
Fax: 614-759-7059

Cincinnati, OH

820-B Lebanon Street
Monroe, OH 45050
Ph: 513-539-0022
Fax: 513-539-0033

Cleveland/Akron, OH

2567 S. Arlington Rd., Ste. 5
Akron, OH 44319
Ph: 330-633-4900
Fax: 330-633-4999

Toledo, OH

3637 Briarfield Blvd.
Maumee, OH 43537
Ph: 419-243-7271
Fax: 419-243-6418

Bridgeport, WV

98 Thompson Drive
Bridgeport, WV 26330
Ph: 304-933-3036
Fax: 304-933-3584

Charleston, WV

504 Old Goff Mountain Road
Cross Lanes, WV 25313
Ph: 304-776-1831
Fax: 304-776-6790